

F.A.I. RTE	SECTION	COUNTY	TOTAL SHEETS	SHEET NO.
80/94		COOK	870	118
STA.		TO STA.		
FED ROAD DIST. NO.		ILLINOIS	FED. AID PROJECT	

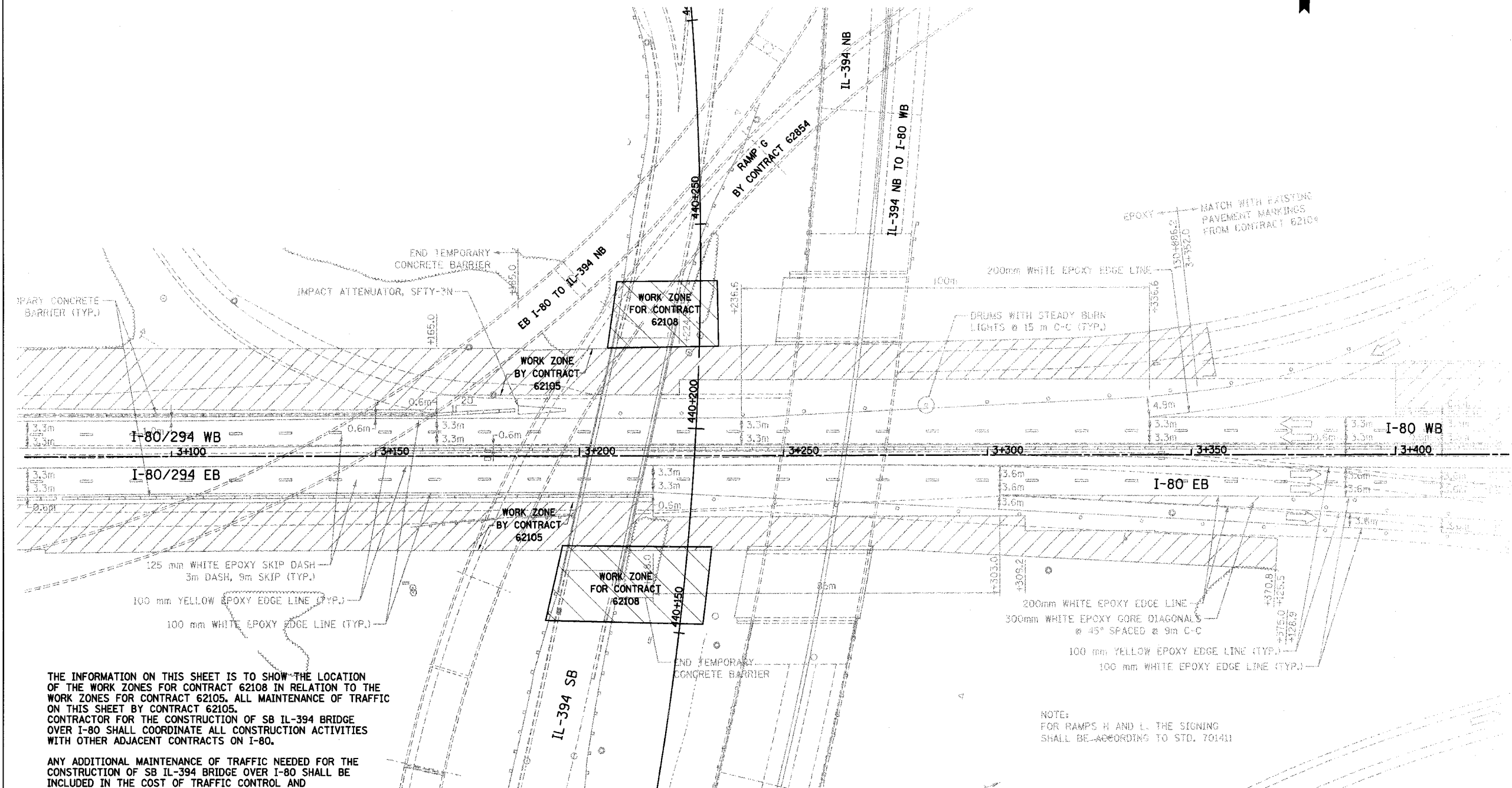

THE INFORMATION ON THIS SHEET IS TO SHOW THE LOCATION OF THE WORK ZONES FOR CONTRACT 62108 IN RELATION TO THE WORK ZONES FOR CONTRACT 62105. ALL MAINTENANCE OF TRAFFIC ON THIS SHEET BY CONTRACT 62105. CONTRACTOR FOR THE CONSTRUCTION OF SB IL-394 BRIDGE OVER I-80 SHALL COORDINATE ALL CONSTRUCTION ACTIVITIES WITH OTHER ADJACENT CONTRACTS ON I-80.

ANY ADDITIONAL MAINTENANCE OF TRAFFIC NEEDED FOR THE CONSTRUCTION OF SB IL-394 BRIDGE OVER I-80 SHALL BE INCLUDED IN THE COST OF TRAFFIC CONTROL AND PROTECTION (EXPRESSWAYS).

ALL MAINTENANCE OF TRAFFIC SHOWN ON THIS SHEET IS FOR REFERENCE ONLY.

NOTE:
FOR RAMP H AND L, THE SIGNING SHALL BE ACCORDING TO STD. 701411

LEGEND

- WORK ZONE
- TEMPORARY PAVEMENT
- TRAFFIC DIRECTION
- LANE CLOSURE
- DRUMS WITH STEADY BURN LIGHTS
- VERTICAL PANELS
- TYPE III BARRICADE WITH 2 FLASHING LIGHTS

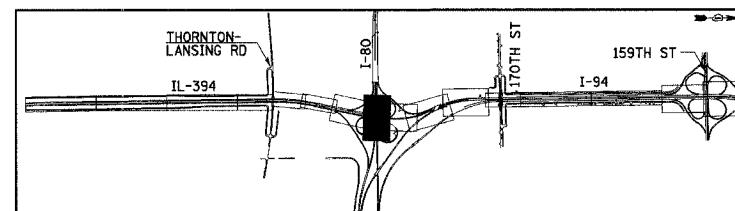

REVISIONS	
NAME	DATE

ILLINOIS DEPARTMENT OF TRANSPORTATION
I-94 EAST BOUND / IL 394 SOUTH BOUND

**MAINTENANCE OF TRAFFIC
STAGE 1
I-80/94 UNDER SB IL-394**

HORIZ SCALE: 1:500
VERT SCALE: NONE
DATE: JULY 18, 2005
DRAWN BY: STS
CHECKED BY: JES

