

F.A.I. 80/94 (KINDERY EXPRESSWAY) BORING LOCATION PLAN ILLINOIS DEPARTMENT OF TRANSPORTATION, COOK COUNTY		F.A.I. RTE.	SECTION	COUNTY	TOTAL SHEET SHEETS NO.
Wang Engineering, Inc. 3248 Midway Street Lombard, IL 60148 630-963-9928 SEC-Environmental Engineers 250-08-04		80/94	*	COOK	870 187
		STA.	TO STA.	ILLINOIS FED. AID PROJECT	
		39+850	40+200		
		FED ROAD DIST. NO.			

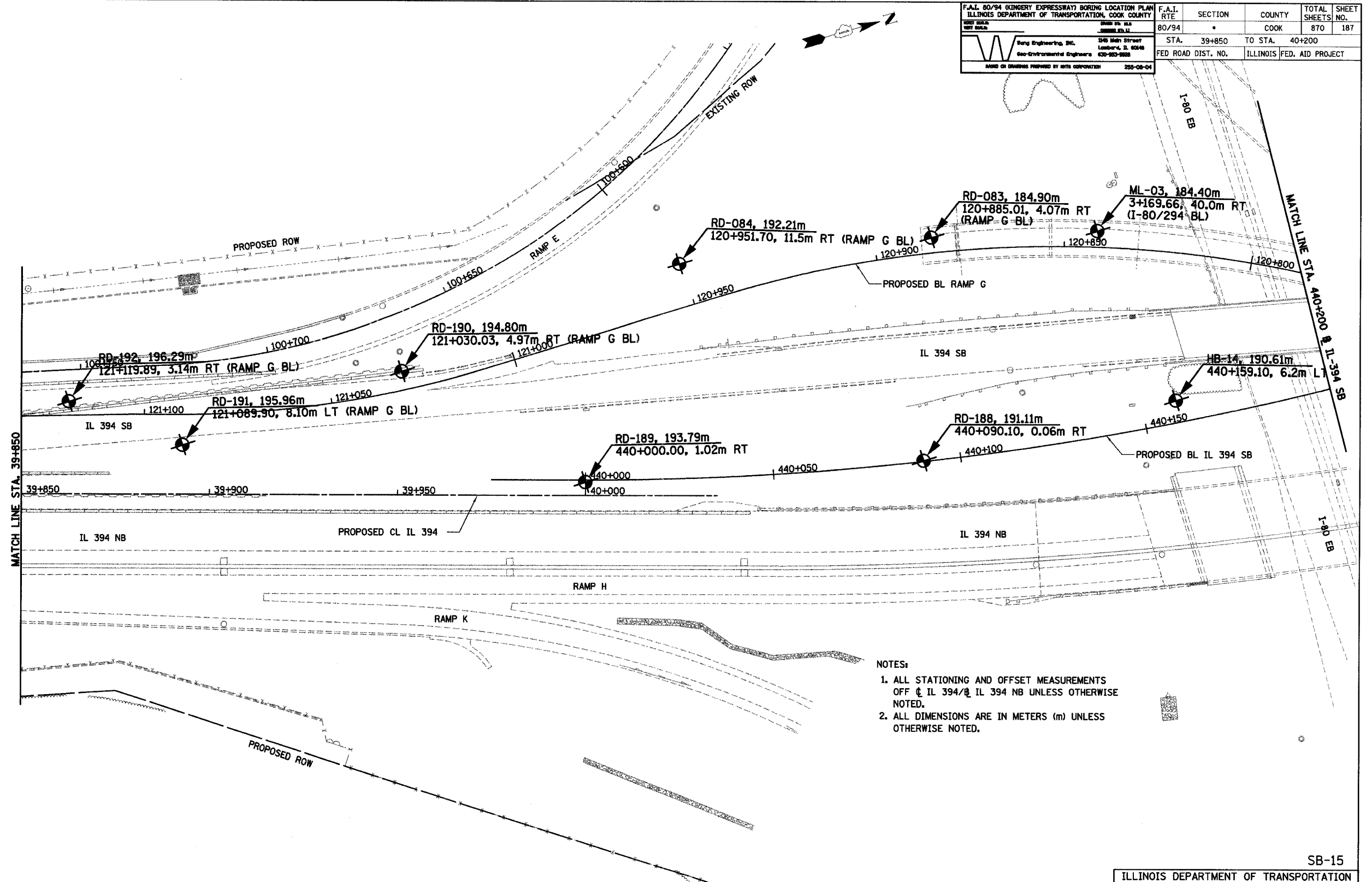

- NOTES:
1. ALL STATIONING AND OFFSET MEASUREMENTS OFF  $\phi$  IL 394/IL 394 NB UNLESS OTHERWISE NOTED.
  2. ALL DIMENSIONS ARE IN METERS (m) UNLESS OTHERWISE NOTED.

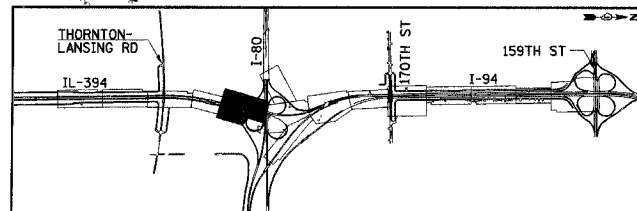

REVISIONS	
NAME	DATE

SB-15  
 ILLINOIS DEPARTMENT OF TRANSPORTATION  
 I-94 EAST BOUND / IL 394 SOUTH BOUND  
**SOIL BORING PLAN**  
 IL 394  
 STA. 39+850 (IL 394) TO  
 STA. 440+200 (IL 394 SB)

HORIZ SCALE: 1:500  
 VERT SCALE:  
 DATE: JULY 18, 2005

DRAWN BY:  
 CHECKED BY: