

F.A.I. RTE	SECTION	COUNTY	TOTAL SHEETS	SHEET NO.
80/94		COOK	870	221
STA. 38+900		TO STA. 39+250		
FED ROAD DIST. NO.		ILLINOIS FED. AID PROJECT		

**LEGEND - EXISTING**

- EXISTING INLET
- ◊ EXISTING CATCH BASIN
- EXISTING MANHOLE
- ⊠ EXISTING MEDIAN DRAINAGE STRUCTURE
- X ⊠ EXISTING DRAINAGE STRUCTURE REMOVAL
- ⊠ AD EXISTING DRAINAGE STRUCTURE ADJUSTMENT
- ~ EXISTING DITCH
- REC EXISTING DRAINAGE STRUCTURE RECONSTRUCTED
- A EXISTING FRAMES AND GRATES ADJUSTMENT
- C EXISTING DRAINAGE STRUCTURES TO BE CLEANED
- ~ EXISTING STORM SEWER TO BE REMOVED
- ~ EXISTING STORM SEWER
- ~ EXISTING SLOTTED DRAIN
- ~ EXISTING PIPE UNDERDRAIN

**MANHOLES TO BE RECONSTRUCTED W/TIFCL**  
 38+946.1, 6.1 LT  
 39+144.0, 6.0 LT  
 39+148.2, 6.0 LT

**REMOVING CATCH BASINS**  
 38+943.9, 36.0 LT  
 39+146.9, 34.5 LT

**STORM SEWER REMOVAL - 300mm**  
 STA. 38+943.94 TO 38+946.13 - 30.0m (24.1cu m)

**STORM SEWER REMOVAL - 375mm**  
 STA. 39+146.87 TO 39+148.24 - 28.6m (29.4 cu m)

**CATCH BASINS TO BE ADJUSTED**  
 39+148.1, @ IL 394  
 38+946.2, @ IL 394

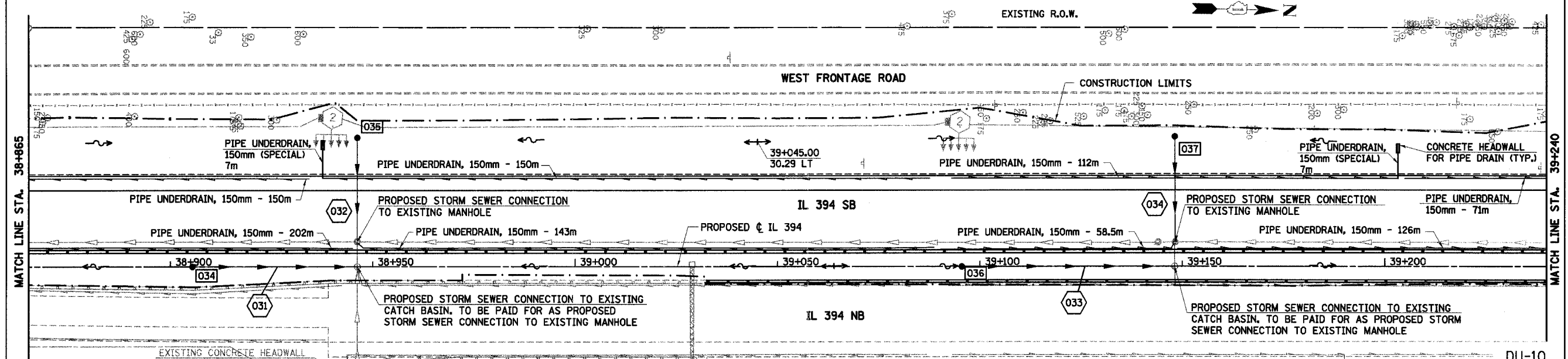
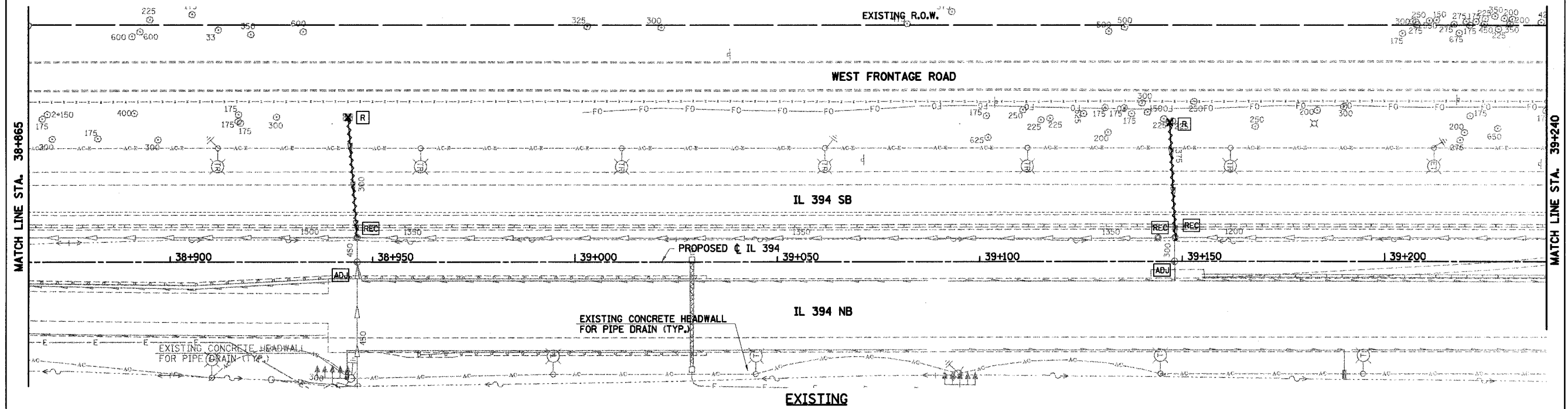

**LEGEND - PROPOSED**

- ~ PROPOSED STORM SEWER
- ~ PROPOSED SUMMIT
- ~ PROPOSED DITCH
- ~ PROPOSED SLOTTED DRAIN
- ~ PROPOSED SWALE
- PROPOSED INLET
- ◊ PROPOSED CATCH BASIN
- PROPOSED MANHOLE
- ⊠ PROPOSED MEDIAN DRAINAGE STRUCTURE
- ▲ PRECAST REINFORCED CONC. FLARED END SECTION

**NOTES:**

- ALL DIMENSIONS ARE IN METERS (m) UNLESS OTHERWISE NOTED.
- ALL PIPE SIZES IN MILLIMETERS (mm) UNLESS OTHERWISE NOTED. QUANTITY OF TRENCH BACKFILL FOR STORM SEWER REMOVAL IS PROVIDED IN SCHEDULE AT TOP OF PLAN SHEET AFTER LENGTH OF PIPE TO BE REMOVED. TRENCH BACKFILL QUANTITY BASED ON LENGTH OF PIPE REMOVED. IF EXISTING STORM SEWER IS REMOVED AND REPLACED, TRENCH BACKFILL WILL BE PROVIDED FOR PROPOSED STORM SEWER ONLY.

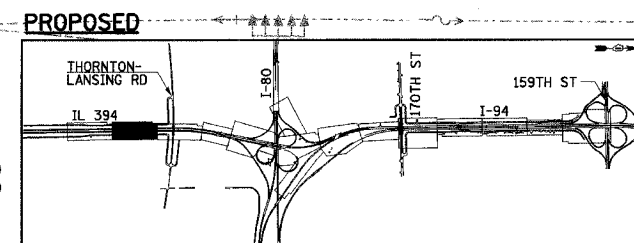

REVISIONS	
NAME	DATE

ILLINOIS DEPARTMENT OF TRANSPORTATION  
 I-94 EAST BOUND / IL 394 SOUTH BOUND  
**DRAINAGE AND UTILITIES**  
**IL 394**  
**STA. 38+865 TO STA. 39+240**  
 HORIZ SCALE: 1:500  
 VERT SCALE:  
 DATE: JULY 18, 2005  
 DRAWN BY: DKB  
 CHECKED BY: MAM

**HNTB**