

F.A.I. RTE	SECTION	COUNTY	TOTAL SHEETS	SHEET NO.
80/94		COOK	870	372
STA. 18+725		TO STA. 19+425		
FED ROAD DIST. NO.		ILLINOIS FED. AID PROJECT		

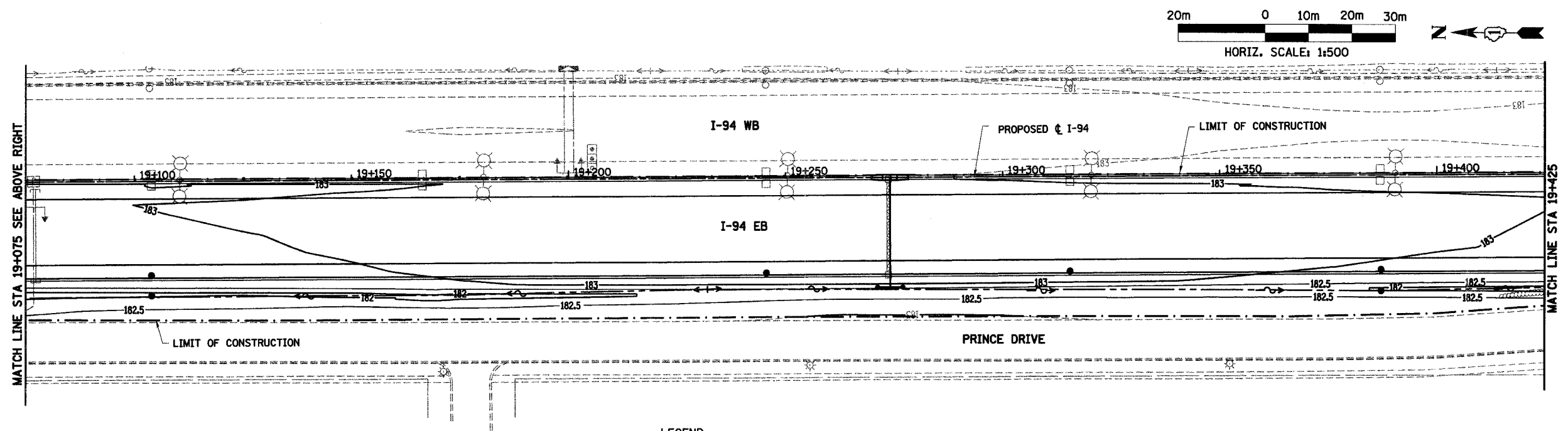

- LEGEND**
- 190--- EXISTING CONTOUR
 - - - - - EXISTING DITCH LINE
 - 190- PROPOSED CONTOUR
 - ~ ~ ~ PROPOSED DITCH FLOW
 - - - - - PROPOSED DITCH LINE
 - ==+== PROPOSED SWALE
 - ⊕ PROPOSED SUMMIT
 - ⊙ PROPOSED MANHOLE
 - PROPOSED INLET
 - ▲ PROPOSED CATCH BASIN
 - ▲ PROPOSED END SECTION

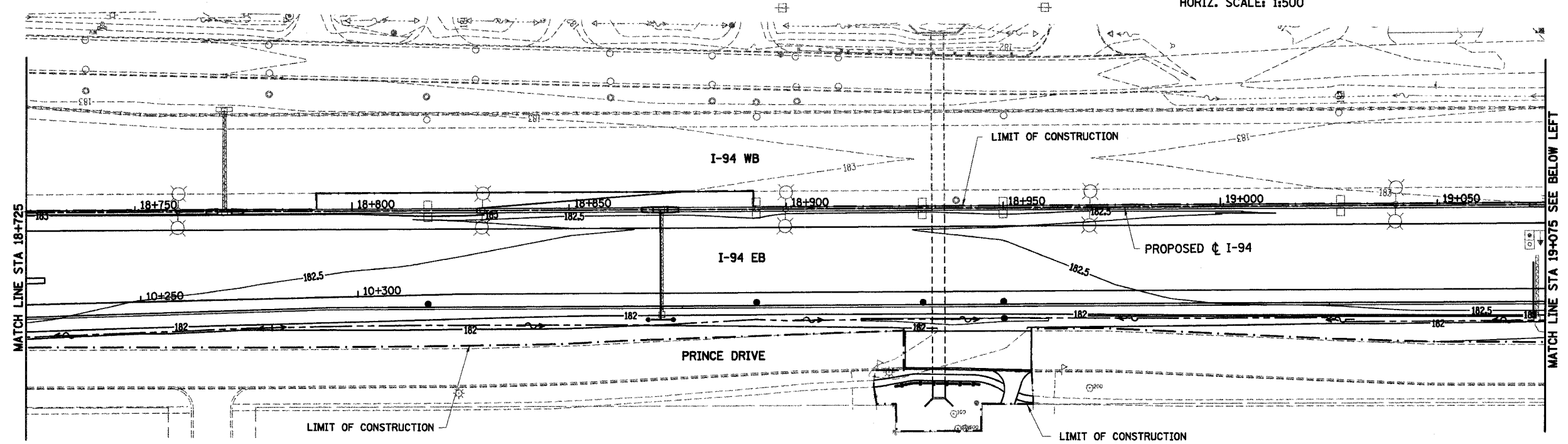
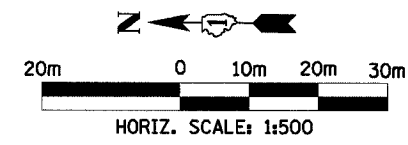
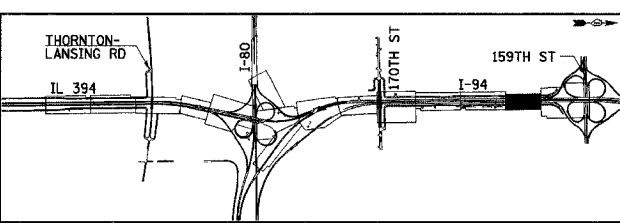

REVISIONS	
NAME	DATE

IG - 2

ILLINOIS DEPARTMENT OF TRANSPORTATION
I-94 EAST BOUND / IL 394 SOUTH BOUND

GRADING PLAN
IL-94
STA. 18+725 TO STA. 19+425

HORIZ SCALE: 1:500
VERT SCALE: 1:10
DATE: JULY 18, 2005

DRAWN BY: BAJ
CHECKED BY: JES

HNTB