

F.A.I. RTE	SECTION	COUNTY	TOTAL SHEETS	SHEET NO.
80/94		COOK	870	378
STA. 440+200		TO STA. 440+400		
FED ROAD DIST. NO.		ILLINOIS FED. AID PROJECT		

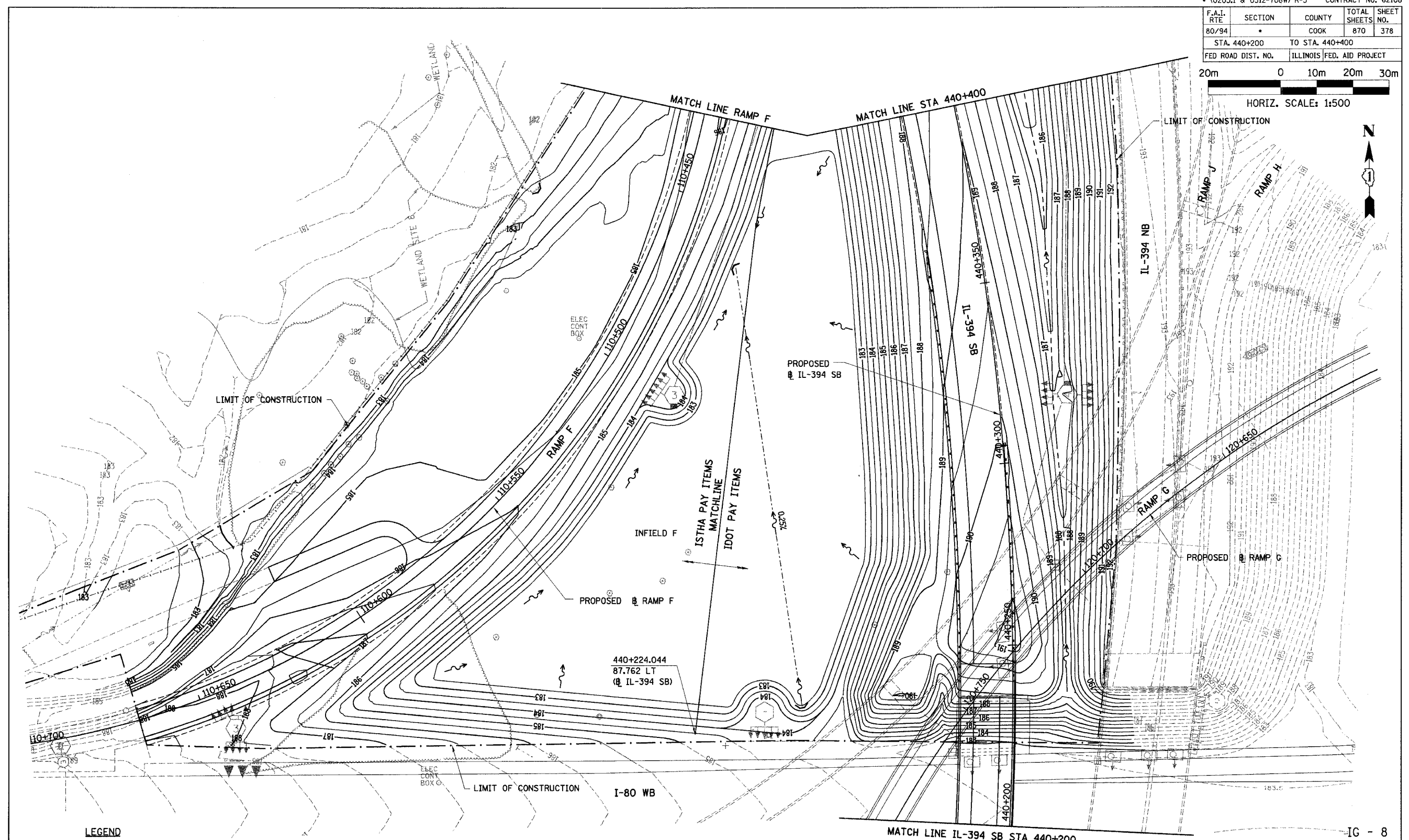

HORIZ. SCALE: 1:500



**LEGEND**

- 190 --- EXISTING CONTOUR
- 190 --- EXISTING DITCH LINE
- 190 --- PROPOSED CONTOUR
- 190 --- PROPOSED DITCH FLOW
- 190 --- PROPOSED DITCH LINE
- 190 --- PROPOSED SWALE
- 190 --- PROPOSED SUMMIT
- 190 --- PROPOSED MANHOLE
- 190 --- PROPOSED INLET
- 190 --- PROPOSED CATCH BASIN
- 190 --- PROPOSED END SECTION

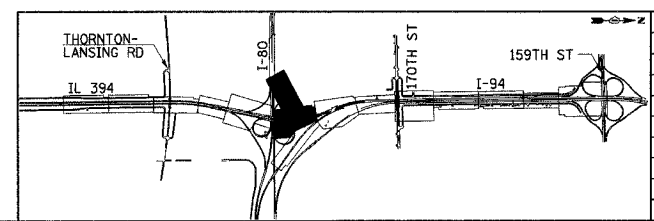

REVISIONS	
NAME	DATE

ILLINOIS DEPARTMENT OF TRANSPORTATION  
I-94 EAST BOUND / IL 394 SOUTH BOUND

**GRADING PLAN**  
IL-394  
STA. 440+200 TO STA. 440+400

HORIZ SCALE: 1:500  
VERT SCALE: 1:50  
DATE: JULY 18, 2005

DRAWN BY: BAJ  
CHECKED BY: JES

**HNTB**