

F.A.I. RTE	SECTION	COUNTY	TOTAL SHEETS	SHEET NO.
80/94	*	COOK	870	406
STA. 440+900 TO STA. 441+167.161		ILLINOIS FED. AID PROJECT		

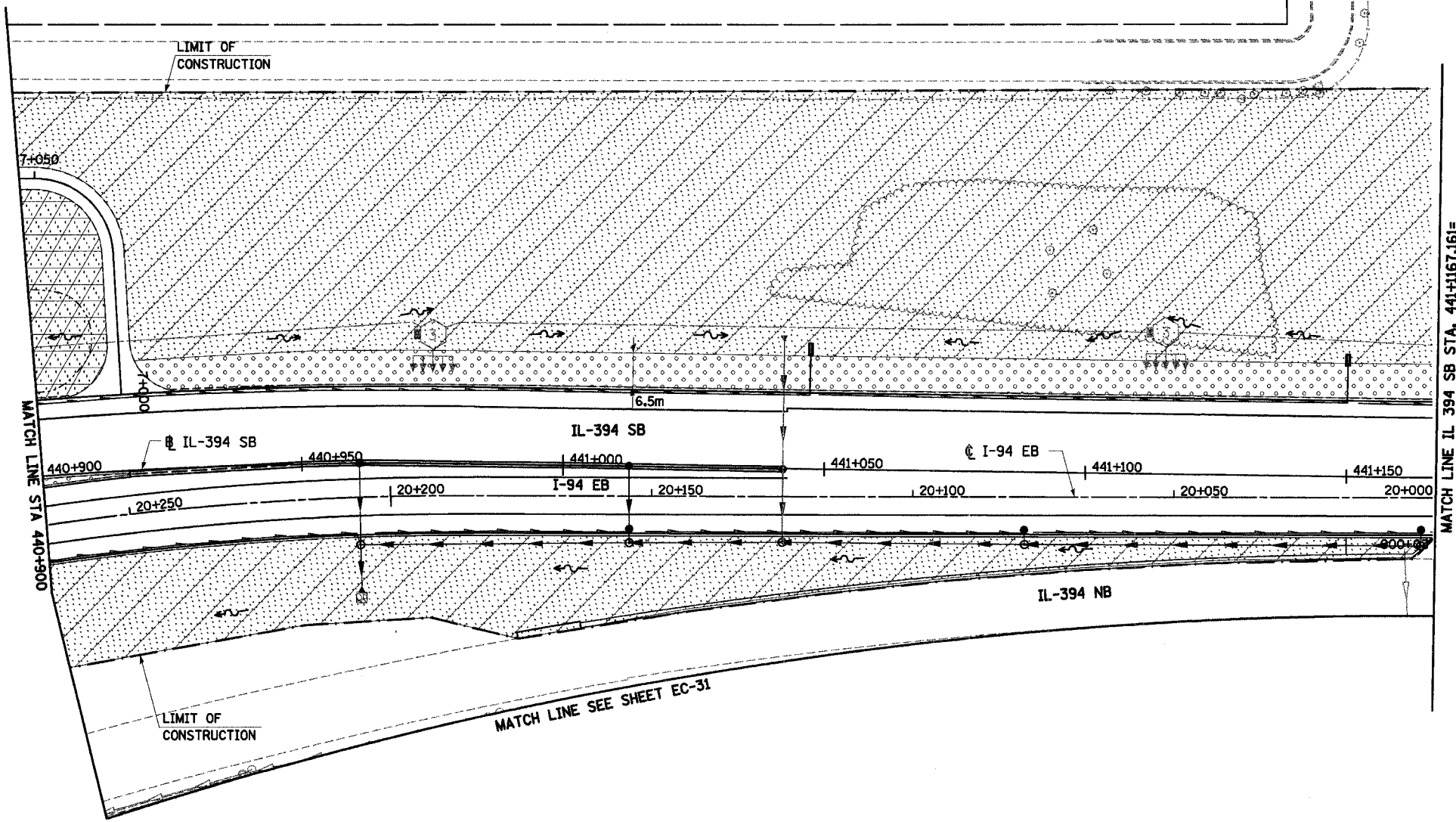

NOTES:

1. WORK THIS SHEET WITH THE EROSION AND SEDIMENT CONTROL GENERAL NOTES, LEGEND AND STRATEGY SHEETS.
2. ALL STATIONING AND OFFSET MEASUREMENTS OFF ϕ IL-394 SB UNLESS OTHERWISE NOTED.
3. ALL DIMENSIONS ARE IN METERS (m) UNLESS OTHERWISE NOTED.

FINAL CONDITION

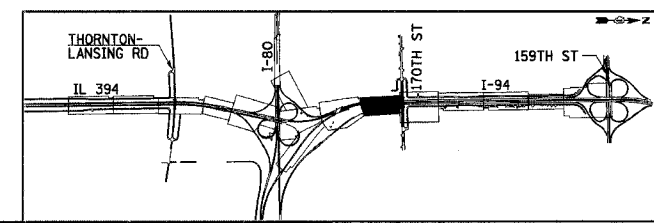

REVISIONS	
NAME	DATE

EC-25

ILLINOIS DEPARTMENT OF TRANSPORTATION
I-94 EAST BOUND / IL 394 SOUTH BOUND

EROSION CONTROL PLAN
IL 394 SB
STA. 440+900 TO STA. 441+167.161

HORIZ SCALE: 1:500
VERT SCALE:
DATE: JULY 18, 2005

DRAWN BY: JPH
CHECKED BY: MAM

HNTB