

STATE OF ILLINOIS  
DEPARTMENT OF TRANSPORTATION

ROUTE NO.	SECTION	COUNTY	TOTAL SHEETS	SHEET NO.	SHEET NO. 67
F. A. I. 80/94		COOK	870	581	91 SHEETS
ILLINOIS FED. AID PROJECT-			CONTRACT NO. 62108		
FED. ROAD DIST. NO. 1			02033.1 & 0312-708W R-3		

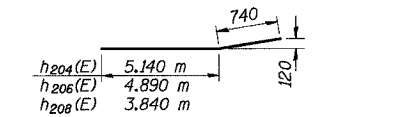

BAR h204(E), h206(E) or h208(E)

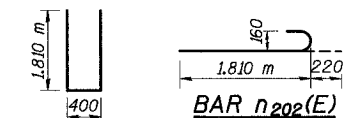

BAR n201(E)

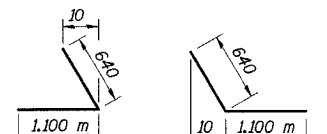

BAR h210(E)

BAR h211(E)

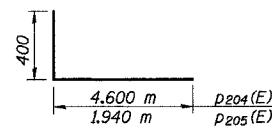

BAR p204(E), p205(E)

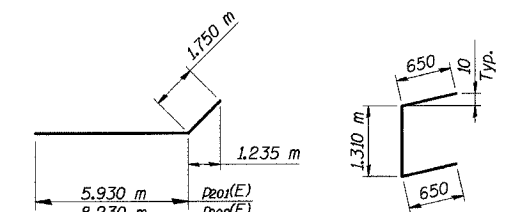

BAR p201(E) or p202(E)

BAR u201(E)

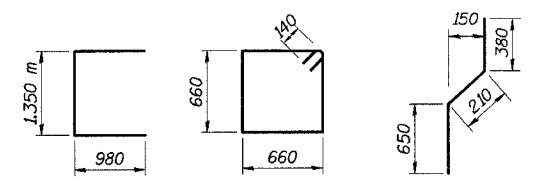

BAR s201(E)

BAR s202(E)

BAR v202(E)

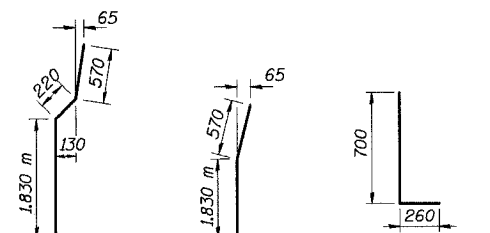

BAR v204(E)

BAR v206(E)

BAR v207(E)

SOUTH ABUTMENT  
BILL OF MATERIAL

Bar	No.	Size	Length (m)	Shape
h201(E)	20	#15	7.770	—
h202(E)	8	#20	7.850	—
h203(E)	1	#15	5.900	—
h204(E)	1	#15	5.880	—
h205(E)	15	#15	5.650	—
h206(E)	9	#15	5.630	—
h207(E)	15	#15	4.600	—
h208(E)	9	#15	4.580	—
h209(E)	2	#15	2.400	—
h210(E)	14	#15	1.740	—
h211(E)	14	#15	1.740	—
n201(E)	51	#20	4.020	—
n202(E)	18	#20	2.030	—
p201(E)	3	#25	7.680	—
p202(E)	3	#25	9.980	—
p203(E)	10	#25	10.400	—
p204(E)	15	#25	5.000	—
p205(E)	3	#25	2.340	—
p206(E)	2	#25	8.770	—
p207(E)	6	#25	6.000	—
p208(E)	6	#25	5.750	—
p209(E)	6	#25	4.700	—
p210(E)	2	#25	6.240	—
s201(E)	116	#15	3.310	—
s202(E)	58	#15	2.920	—
u201(E)	7	#15	2.610	—
v201(E)	128	#15	2.130	—
v202(E)	51	#15	1.240	—
v203(E)	51	#15	0.950	—
v204(E)	32	#20	2.620	—
v205(E)	38	#20	2.650	—
v206(E)	6	#20	2.400	—
v207(E)	8	#15	0.960	—
<b>ITEM UNIT QUANTITY</b>				
Structure Excavation	m <sup>3</sup>	226		
Concrete Structures	m <sup>3</sup>	74.8		
Controlled Low-Strength Material	m <sup>3</sup>	4.9		
Reinforcement Bars, Epoxy Coated	kg	4,880		
Furnishing Steel Piles HP 360x108	m	416		
Driving Steel Piles	m	416		
Test Pile Steel HP 360x108	Each	1		
Bar Splicers	Each	51		
Porous Granular Embankment (Special)	m <sup>3</sup>	94.5		

Reinforcement bars designated (E) shall be epoxy coated.

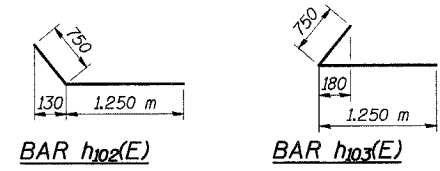

BAR h102(E)

BAR h103(E)

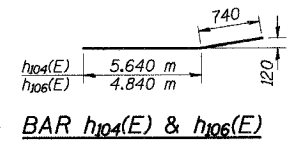

BAR h104(E) & h106(E)

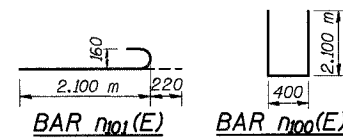

BAR n101(E)

BAR n102(E)

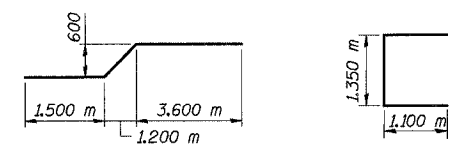

BAR p102(E)

BAR u101(E)

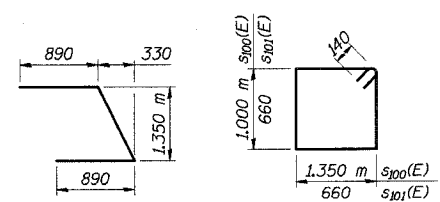

BAR u101(E)

BAR s100(E) & s101(E)

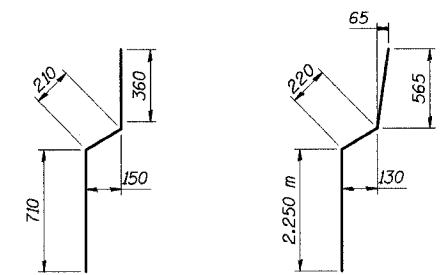

BAR v101(E)

BAR v104(E)

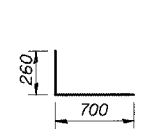

BAR v106(E)

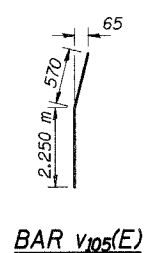

BAR v105(E)

NORTH ABUTMENT  
BILL OF MATERIAL

Bar	No.	Size	Length (m)	Shape
h100(E)	20	#15	10.500	—
h101(E)	8	#20	10.500	—
h102(E)	14	#15	2.000	—
h103(E)	14	#15	2.000	—
h104(E)	10	#15	6.380	—
h105(E)	14	#15	6.400	—
h106(E)	11	#15	5.580	—
h107(E)	15	#15	5.600	—
h108(E)	4	#15	2.400	—
h109(E)	2	#15	10.500	—
n100(E)	57	#20	4.600	—
n101(E)	18	#20	2.320	—
p100(E)	7	#25	11.000	—
p101(E)	7	#25	10.620	—
p102(E)	7	#25	6.440	—
p103(E)	4	#20	2.300	—
p104(E)	4	#20	6.970	—
p105(E)	12	#20	4.200	—
p106(E)	4	#20	3.600	—
p107(E)	6	#25	6.850	—
p108(E)	12	#25	6.050	—
p109(E)	4	#20	5.000	—
s100(E)	13	#15	4.980	—
s101(E)	67	#15	2.920	—
u100(E)	170	#15	3.550	—
u101(E)	7	#20	3.170	—
v100(E)	164	#15	2.700	—
v101(E)	69	#15	1.280	—
v102(E)	69	#15	1.000	—
v103(E)	45	#20	3.090	—
v104(E)	39	#20	3.040	—
v105(E)	6	#20	2.820	—
v106(E)	16	#15	0.960	—
<b>ITEM UNIT QUANTITY</b>				
Structure Excavation	m <sup>3</sup>	171		
Concrete Structures	m <sup>3</sup>	105.4		
Controlled Low-Strength Material	m <sup>3</sup>	5.1		
Reinforcement Bars, Epoxy Coated	kg	6,380		
Furnishing Steel Piles HP 360x108	m	531		
Driving Steel Piles	m	531		
Test Pile Steel HP 360x108	Each	2		
Bar Splicers	Each	69		
Porous Granular Embankment (Special)	m <sup>3</sup>	171.2		

Reinforcement bars designated (E) shall be epoxy coated.

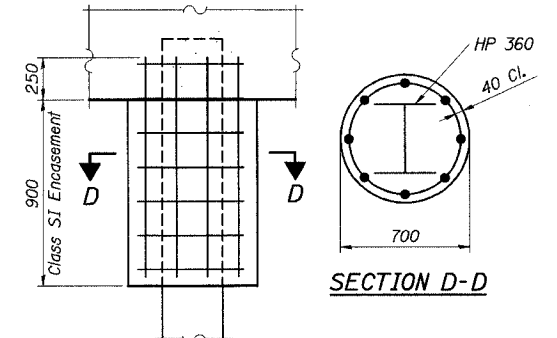

PILE ENCASEMENT DETAIL

Welded wire fabric 152x152-MW25.8xMW25.8 with a mass of 2.91 kg/m<sup>2</sup>. The cost of Excavation, Class SI Concrete Encasement and Reinforcement is included with Furnishing Piles. Forms for encasement may be omitted when soil conditions permit.

Notes:

1. Work this Sheet with Sheets 61 thru 66 of 91 Sheets.
2. All dimensions are in millimeters except as noted.

ILLINOIS DEPARTMENT OF TRANSPORTATION  
I-94 EAST BOUND / IL 394 SOUTH BOUND  
NORTH & SOUTH ABUTMENTS  
BILL OF MATERIAL  
SB IL ROUTE 394 OVER THORN CREEK  
F.A.P. 332 SECTION (02033.1 & 0312-708W) R-3  
COOK COUNTY  
STA. 440+704.350 STRUCTURE NO. 016-2800  
DATE JUL 18, 2005  
SCALE

HNTB

J:\km  
en\34662\CADD\SA\SN\_2800\cda\CTR\_19\_2800\abi\90094s\_2800.dgn  
22-AUG-2005 10:51

DESIGNED	TRL/MEA
CHECKED	MEA/TRL
DRAWN	LK
CHECKED	TRL/MEA