

F.A.I. RTE.	SECTION	COUNTY	TOTAL SHEETS	SHEET NO.
80/94		COOK	870	763
STA.		TO STA.		
FED ROAD DIST. NO.		ILLINOIS FED. AID PROJECT		

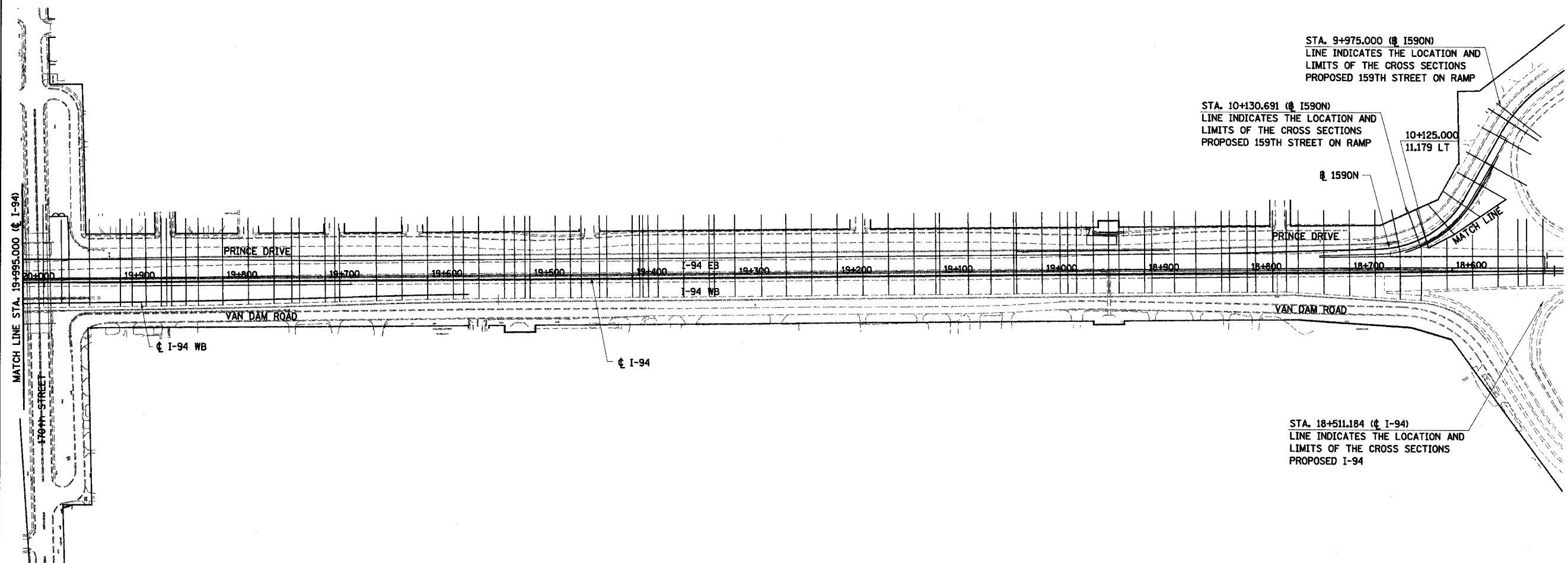

STA. 9+975.000 (± I590N)
 LINE INDICATES THE LOCATION AND LIMITS OF THE CROSS SECTIONS PROPOSED 159TH STREET ON RAMP

STA. 10+130.691 (± I590N)
 LINE INDICATES THE LOCATION AND LIMITS OF THE CROSS SECTIONS PROPOSED 159TH STREET ON RAMP

10+125.000
 11.179 LT

± I590N

± I-94

STA. 18+511.184 (± I-94)
 LINE INDICATES THE LOCATION AND LIMITS OF THE CROSS SECTIONS PROPOSED I-94

KM-3

ILLINOIS DEPARTMENT OF TRANSPORTATION
 I-94 EAST BOUND / IL 394 SOUTH BOUND

CROSS SECTION KEY MAP

HORIZ SCALE: 1 : 2000
 VERT SCALE: NONE
 DATE: JULY 18, 2005

DRAWN BY: BAJ/BJM
 CHECKED BY: JES

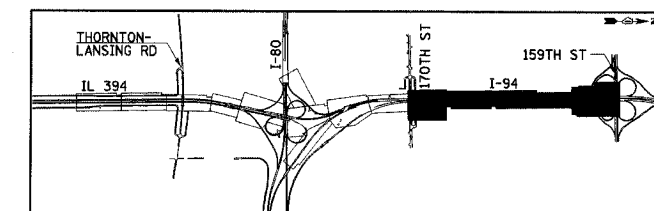

REVISIONS	
NAME	DATE