

F.A.I. RTE.	SECTION	COUNTY	TOTAL SHEETS	SHEET NO.
80/94	2003-089I	COOK	1207	452
STA.	TO STA.			
FED. ROAD DIST. NO.	ILLINOIS FED. AID PROJECT		CONTRACT • 62114	

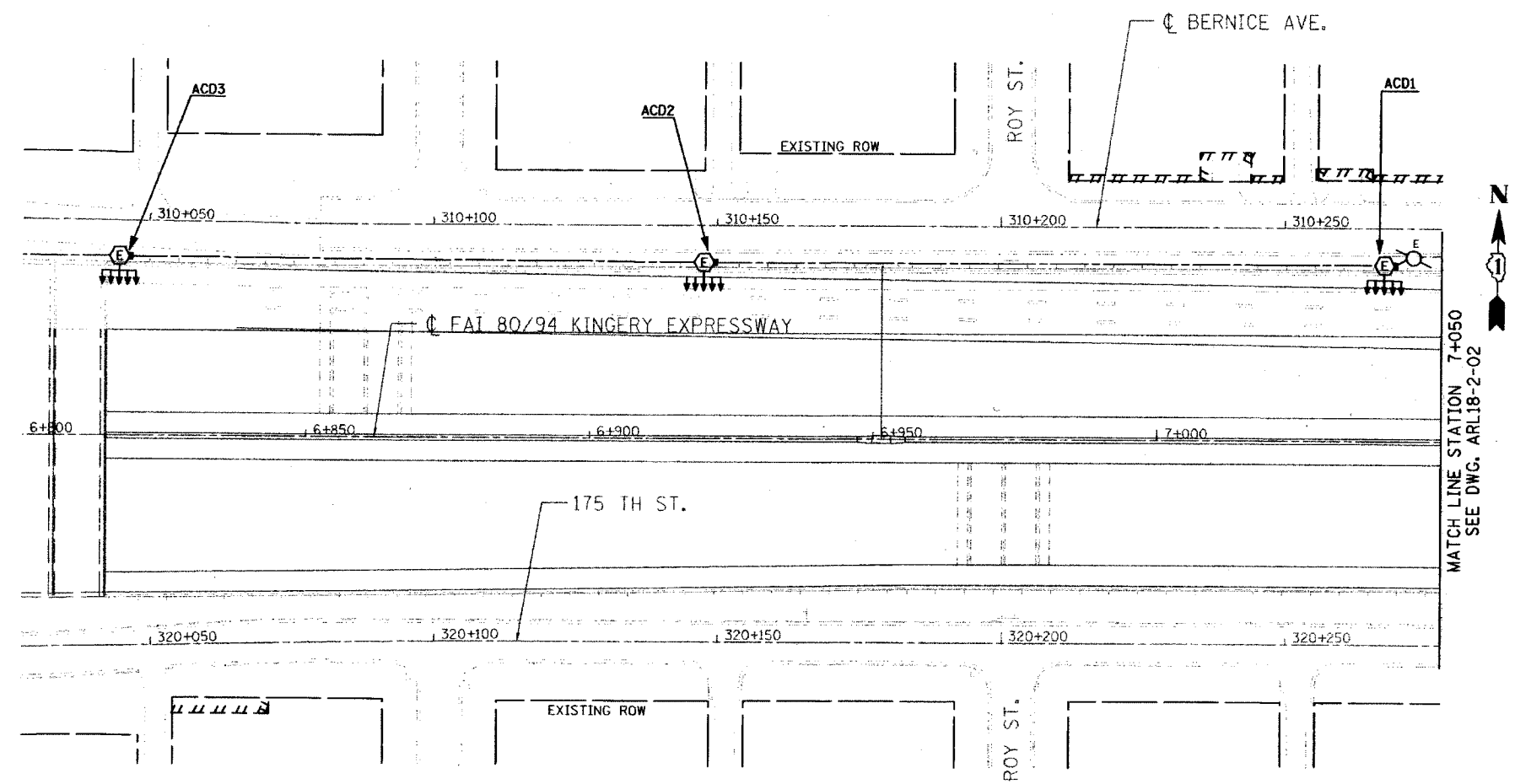

MATCH LINE STATION 7+050
SEE DWG. ARL18-2-02



Michael G. Kelly 07/13/05
11/20/05

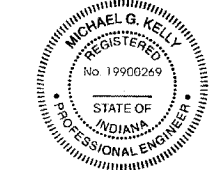

Michael G. Kelly 07/13/05
Exp. 07/31/06

ARL18-2-01

ILLINOIS DEPARTMENT OF TRANSPORTATION
I-80/94/US 6
KINGERY-BORMAN EXPRESSWAY
BURNHAM ROAD TO US 41
EXISTING LIGHTING PLAN
I-80/94/US 6
STA. 6+800 TO STA. 7+050
SCALE 1:500
DATE 07/18/05
DRAWN BY EAO/BC
CHECKED BY PKG/BC

GO GANDHI AND ASSOCIATES, INC.
ENGINEERS AND PLANNERS
200 S. MICHIGAN STREET
CHICAGO, ILLINOIS 60604 TEL: 312.774.5900

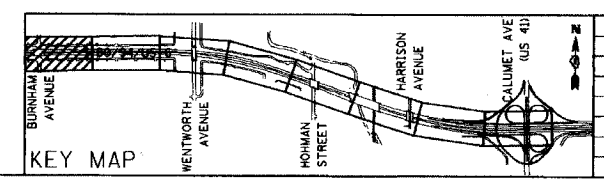

REVISIONS	
NAME	DATE

2:\projects\80-94\80-94\18-2\18-2-01.dwg
7/13/05
3:04:36 PM