

ROUTE NO.	SECTION	COUNTY	SHEETS	SHEET	SHEET NO. S-12
P.A.L.	2626.2-R-1	COOK	1207	832	20 SHEETS
DATE	DESIGNED BY	CHECKED BY	DRAWN BY	CHECKED BY	

CONTRACT NO. 62114 INDOT DES. NO. 0100987

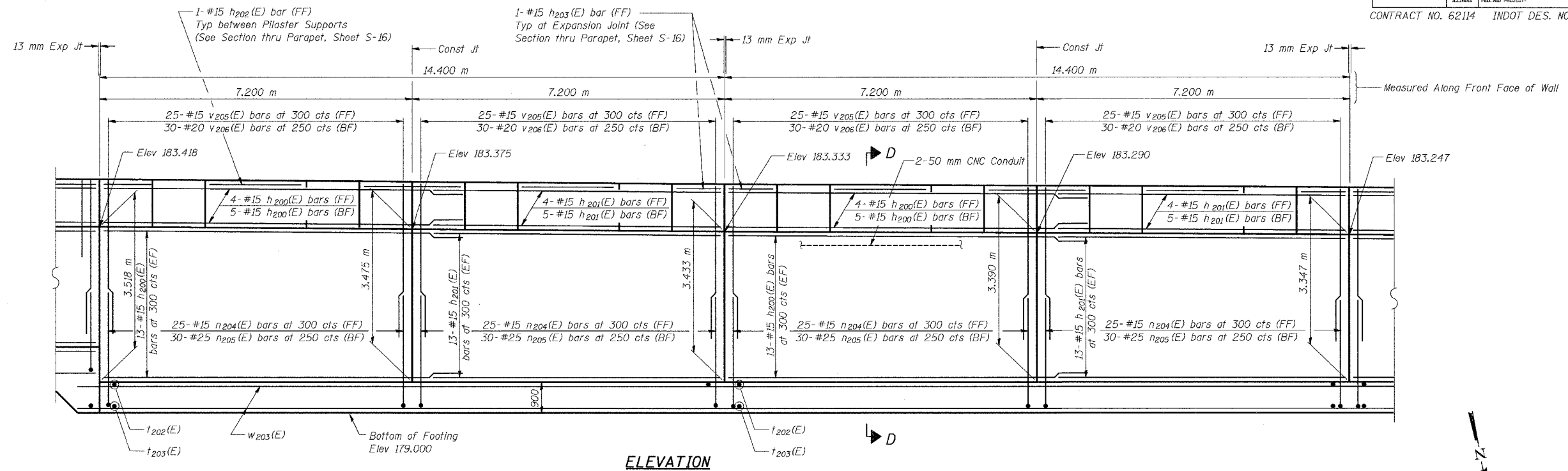

ELEVATION

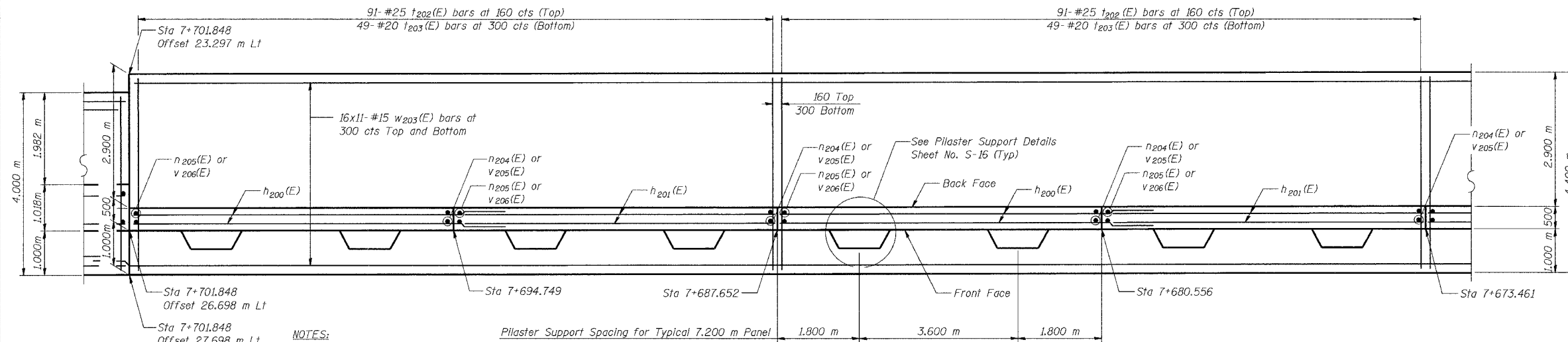

FOOTING PLAN

NOTES:
 See Sheet S-16 for Section D-D, Expansion Joint Detail, and Bill of Material.
 See Sheet S-17 for Rustication details.
 Stations are referenced to \odot I-80/94.
 Reinforcement bars designated (E) shall be epoxy coated.
 All dimensions are in millimeters (mm) except as noted.
 Bars indicated thus 20 x 3-#15 etc. Indicates 20 lines of bars with 3 lengths per line.
 See Electrical Drawings for Junction Box and Conduit Details.

DESIGNED	MJW
CHECKED	KFA
DRAWN	MJB
CHECKED	GSP

MINIMUM BAR LAPS
 #15 bars = 640
 #20 bars = 790

LEGEND
 BF = Back Face
 FF = Front Face
 EF = Each Face

ILLINOIS DEPARTMENT OF TRANSPORTATION
 I-80/94/US 6
 KINGERY-BORMAN EXPRESSWAY
 BURNHAM ROAD TO US 41

PLAN AND ELEVATION (10 OF 13)
SECTION 2626.2-R-1
COOK COUNTY
STATION 7+609.549 TO STATION 7+893.827
STRUCTURE NO. 016-W856
 DATE 07/05

AMERICAN
 CONSULTING ENGINEERS

FOR INFORMATION ONLY

13-11-100813a.mxd 07/25/05 07:35:29 PM