

|           |            |                      |       |       |                |
|-----------|------------|----------------------|-------|-------|----------------|
| ROUTE NO. | SECTION    | COUNTY               | SHEET | SHEET | SHEET NO. S-13 |
| I-80/94   | 2626.2-R-2 | LAKE COUNTY, INDIANA | 1207  | 929   | 29 SHEETS      |
| DRAWN     |            | FED. AID PROJECT:    |       |       |                |

CONTRACT NO. 62114 INDOT DES. NO. 0100987

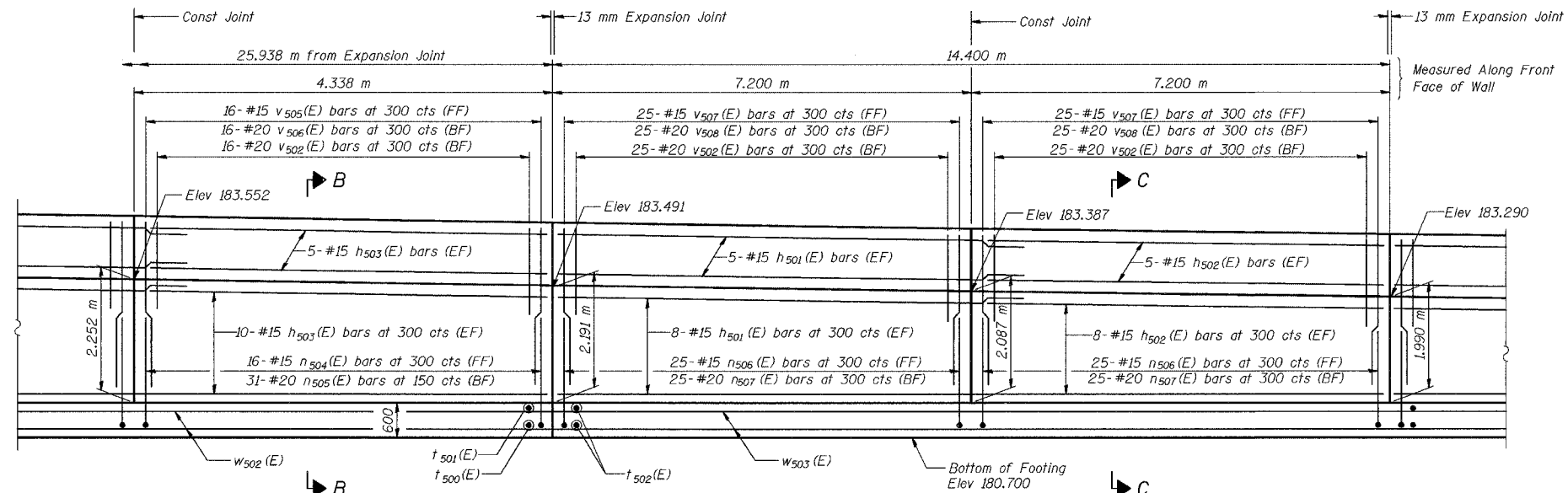

**ELEVATION**

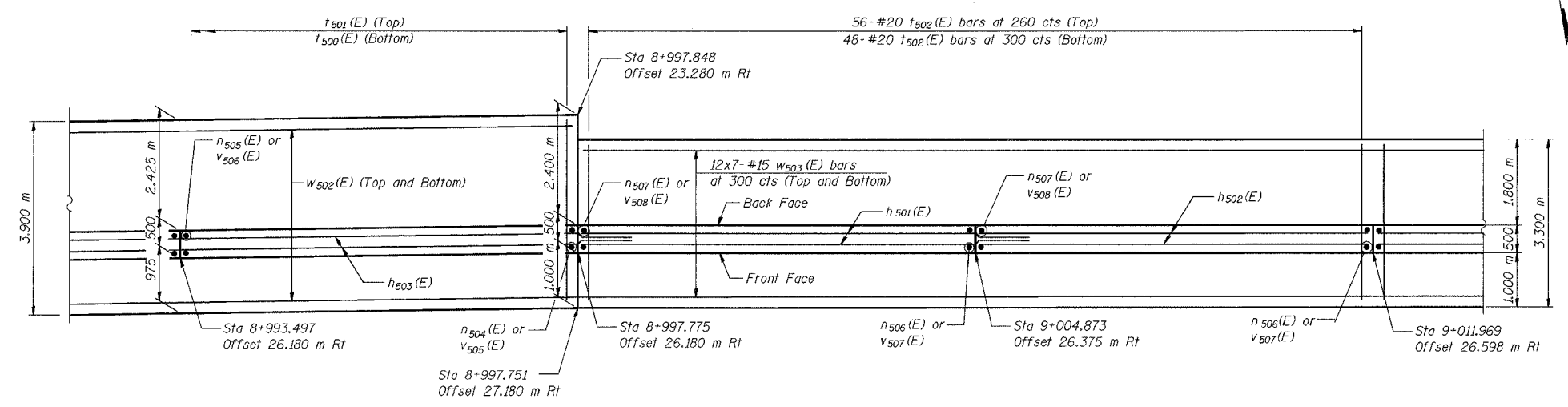

**FOOTING PLAN**

|          |     |
|----------|-----|
| DESIGNED | KFA |
| CHECKED  | BPS |
| DRAWN    | MJB |
| CHECKED  | GSP |

**MINIMUM BAR LAPS**  
 #15 bars = 640  
 #20 bars = 790

**LEGEND**  
 BF = Back Face  
 FF = Front Face  
 EF = Each Face

**NOTES:**  
 See Sheet S-19 for Section B-B and section C-C.  
 See Sheet S-20 for Expansion Joint Detail and Bill of Material.  
 See Sheet S-21 for Rustication details.  
 Stations are referenced to @ I-80/94.  
 Reinforcement bars designated (E) shall be epoxy coated.  
 All dimensions are in millimeters (mm) except as noted.  
 Bars indicated thus 20 x 3-#15 etc. indicates 20 lines of bars with 3 lengths per line.

ILLINOIS DEPARTMENT OF TRANSPORTATION  
 I-80/94/US 6  
 KINGERY-BORMAN EXPRESSWAY  
 BURNHAM ROAD TO US 41

**PLAN AND ELEVATION (11 OF 13)**  
**SECTION 2626.2-R-2**  
**LAKE COUNTY, INDIANA**  
**STATION 8+774.073 TO STATION 9+227.203**  
**STRUCTURE NO. 016-W861**

DATE 09/05

**AMERICAN**  
 CONSULTING ENGINEERS