

PLAN

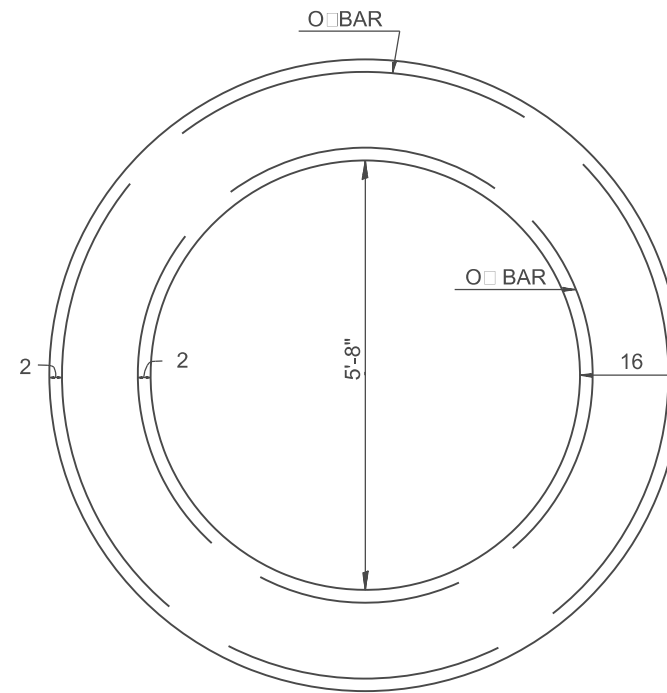

PLAN

(SHOWING REINFORCEMENT IN CONCRETE RING FOUNDATION)

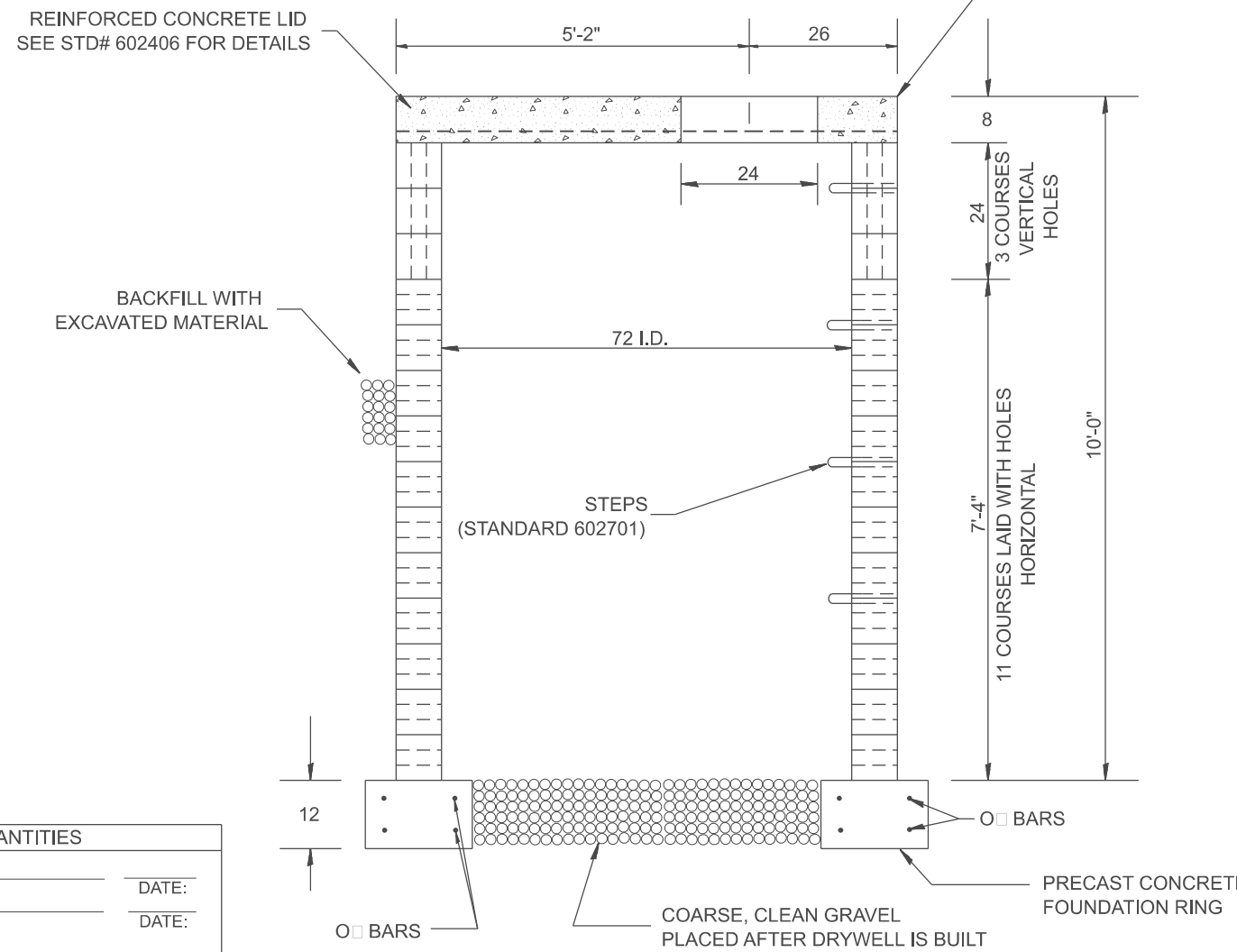

ELEVATION

GENERAL NOTES:

- The concrete blocks shall be 3 cell - 8"x8"x16". The top 3 courses of blocks shall be laid with the holes vertical. All other blocks shall be laid with the holes horizontal. All joints shall be mortar.
- The outside of the drywell shall be wrapped in a filter fabric conforming to Article 1080.03 of the Standard Specifications using a two (2) foot overlap at seam.
- Drywell to be provided with a TYPE 8 GRATE. (Standard 604036)

BILL OF MATERIALS FOR 1 DRYWELL

CONCRETE BLOCKS	=	196 EA.
FILTER FABRIC	=	26 SQ YD
TYPE 8 GRATE	=	1 EA.
STEPS PER STD# 602701	=	8 EA.
GRAVEL	=	1 CU YD
CONCRETE LID PER STD# 602406	=	1 EA.
CONCRETE FOUNDATION RING		
CLASS PC CONCRETE	=	1.1 CU YD
2 #4 '0' BARS LENGTH = 25'	=	35 LBS
2 #4 '0' BARS LENGTH = 19'	=	25 LBS

DESIGNER NOTES:
 1. INCLUDE DISTRICT SPECIAL PROVISION.
 2. INCLUDE STATE STANDARDS 602406, 602701 & 604036.
 3. THIS IS FOR SPECIAL APPLICATIONS: CHECK WITH YOUR PROJECT ENGINEER.

MODEL: SHT_PLAN
 FILE NAME: C:\Bentley\CONNECT\10110\organization\Chilid\DOT_Standards\Civil\DOT_Sheets.dwg

QUANTITIES	
CALC. BY:	DATE:
CHECKED BY:	DATE:
QUANTITY CALCULATIONS ARE ON FILE AT THE DISTRICT 4 OFFICE; BUREAU OF PROJECT IMPLEMENTATION; DOCUMENTATION SECTION	

USER NAME = Eric.Thomas	DESIGNED -	REVISED -
	DRAWN -	REVISED -
	CHECKED -	REVISED -
PLOT DATE = 12/7/2022	DATE -	REVISED -

STATE OF ILLINOIS
 DEPARTMENT OF TRANSPORTATION

DRYWELL

SCALE: NOT TO SCALE SHEET OF SHEETS STA. TO STA.

All dimensions are in inches unless otherwise noted.

F.A. RTE.	SECTION	COUNTY	TOTAL SHEETS	SHEET NO.
DISTRICT 4 DETAIL NO. 602601			CONTRACT NO.	
ILLINOIS FED. AID PROJECT				