

DATE	
BY	
PLAN	
NO.	
DATE	
BY	
PROFILE	
NO.	

DATE	
BY	
PROFILE	
NO.	



LEGEND

- BR APPR PVT CON (FLX)
- HMA SURF REM BUTT JT
- HOT-MIX ASPHALT SURFACE REMOVAL, 1 3/4" W/ BITUMINOUS MATERIALS (PRIME COAT), HOT-MIX ASPHALT SURFACE COURSE, MIX "D", N70, 1 3/4"
- PAVEMENT REM
- APPROACH SLAB REMOVAL 1 @ 44'-6" BY 20'-0"

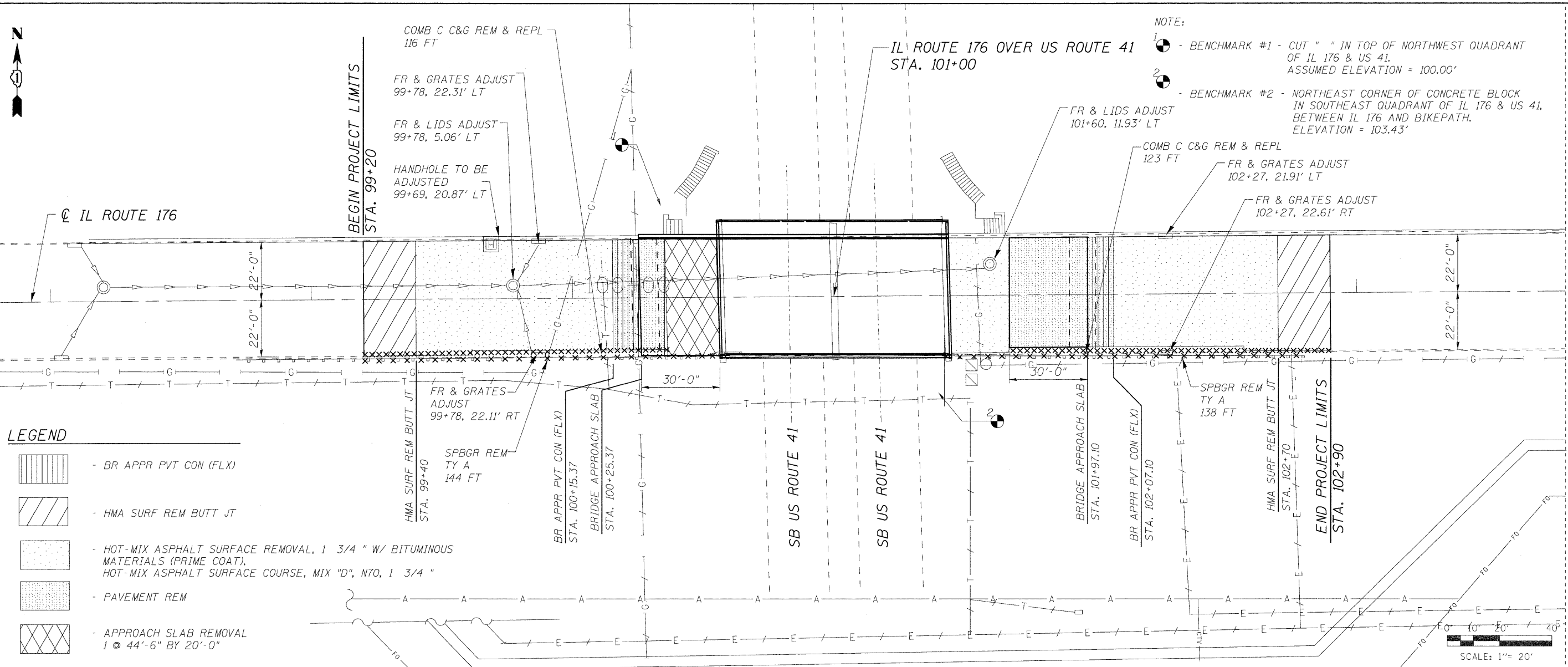

NOTE:
 1 - BENCHMARK #1 - CUT " " IN TOP OF NORTHWEST QUADRANT OF IL 176 & US 41. ASSUMED ELEVATION = 100.00'
 2 - BENCHMARK #2 - NORTHEAST CORNER OF CONCRETE BLOCK IN SOUTHEAST QUADRANT OF IL 176 & US 41. BETWEEN IL 176 AND BIKEPATH. ELEVATION = 103.43'

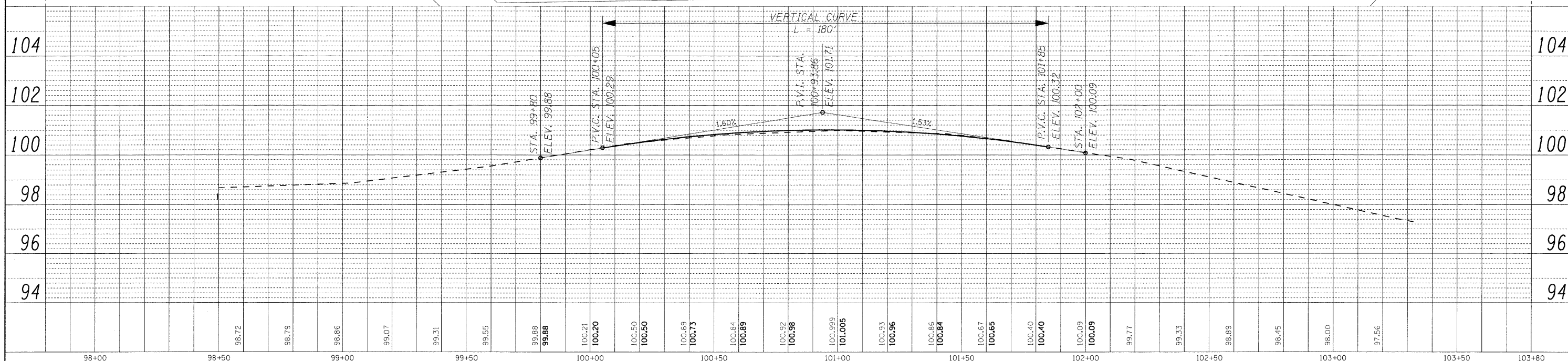

 CONSULTING ENGINEERS 1560 WALL ST, SUITE 222 NAPERVILLE, ILLINOIS 60563 PH 630/577-9100	DESIGNED - MJY	REVISED -	STATE OF ILLINOIS DEPARTMENT OF TRANSPORTATION	PLAN AND PROFILE IL ROUTE 176 (ROCKLAND AVE) OVER US ROUTE 41 (SKOKIE HWY)		F.A.U. RTE. 138	SECTION 125SB-1-R	COUNTY LAKE	TOTAL SHEETS 38	SHEET NO. 11
	DRAWN - ST, TSC	REVISED -		SCALE: 1" = 20'	SHEET NO. 11 OF 38 SHEETS	STA. 99+20 TO STA. 102+90	D-91-045-08 FED. ROAD DIST. NO. ILLINOIS FED. AID PROJECT		CONTRACT NO. 60D57	
CHECKED - MJY, DC	REVISED -									
DATE - 10/16/2009	REVISED -									