

NOTE:  
REFER TO HIGHWAY STANDARD 701601  
FOR ADVANCE SIGNING AND ADDITIONAL  
DETAILS NOT SHOWN

- CONSTRUCTION WORK ZONE
- DIRECTION OF TRAFFIC
- TEMPORARY CONCRETE BARRIER
- IMPACT ATTENUATOR TEMPORARY
- FLASHING ARROW BOARD
- TYPE III BARRICADE
- BARRICADE OR DRUM  
50' CTC ON TANGENTS  
20' CTC IN TAPER

NOTE:  
FIBER OPTIC CABLES ARE ATTACHED TO THE WEST SIDE OF THE  
SOUTHBOUND BRIDGE (SN 016-2512) FOR TRAFFIC SIGNAL INTERCONNECT.  
THERE ARE DRAIN PIPES ATTACHED TO THE BOTTOM OF THE DECK AND  
DIAPHRAGMS. THERE MAY BE ELECTRICAL CONDUIT IN THE DECK FOR  
THE LIGHTING ON THE BRIDGE.  
USE DIRECTION INDICATOR BARRICADES IN LANE CLOSURE TAPERS

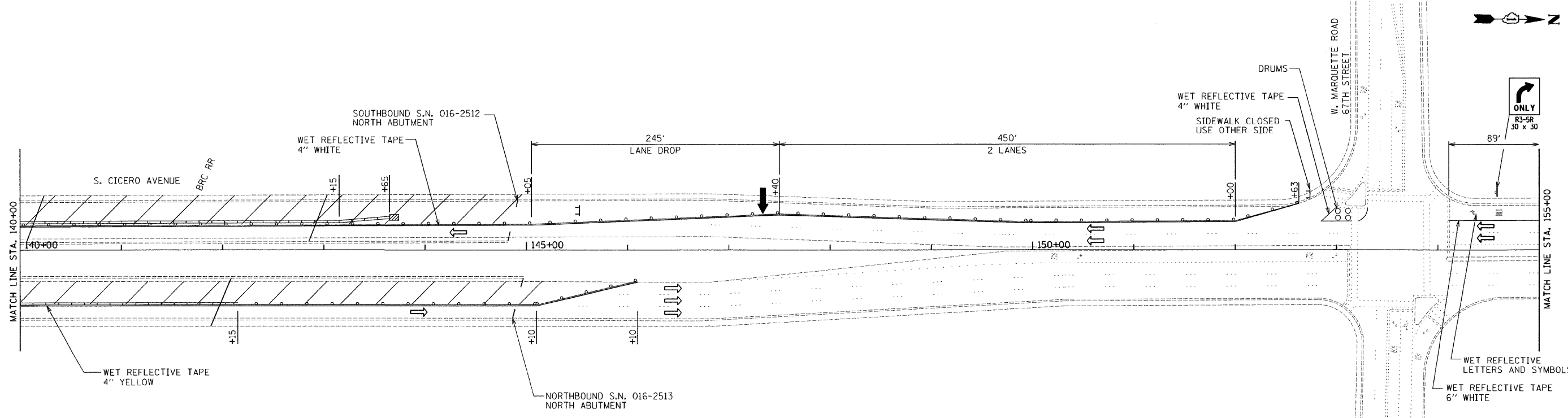
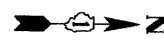

I:\p\2009\20090323-02\cod\site\00\116016-sth-stopeid.dgn  
 10/22/2009 10:58:04 AM

FILE NAME =	USER NAME = USER	DESIGNED - RS	REVISED -	<b>STATE OF ILLINOIS DEPARTMENT OF TRANSPORTATION</b>	<b>IL 50 (CICERO AVENUE) MAINTENANCE OF TRAFFIC STAGE 1</b>			F.A.P. RTE. 350	SECTION 50-1 VB-1-BR	COUNTY COOK	TOTAL SHEETS 33	SHEET NO. 6
		DRAWN - EF	REVISED -		SCALE: 50	SHEET NO. 1 OF 4 SHEETS	STA.	TO STA.	CONTRACT NO. 60H76			
		CHECKED -	REVISED -		ILLINOIS FED. AID PROJECT							
		DATE - 10/23/09	REVISED -									