

ROUTE	SECTION	COUNTY	TOTAL SHEETS	SHEET NUMBER
IL 394 NB & SB	2009-079 BP	COOK	26	8

CONTRACT NO 60116

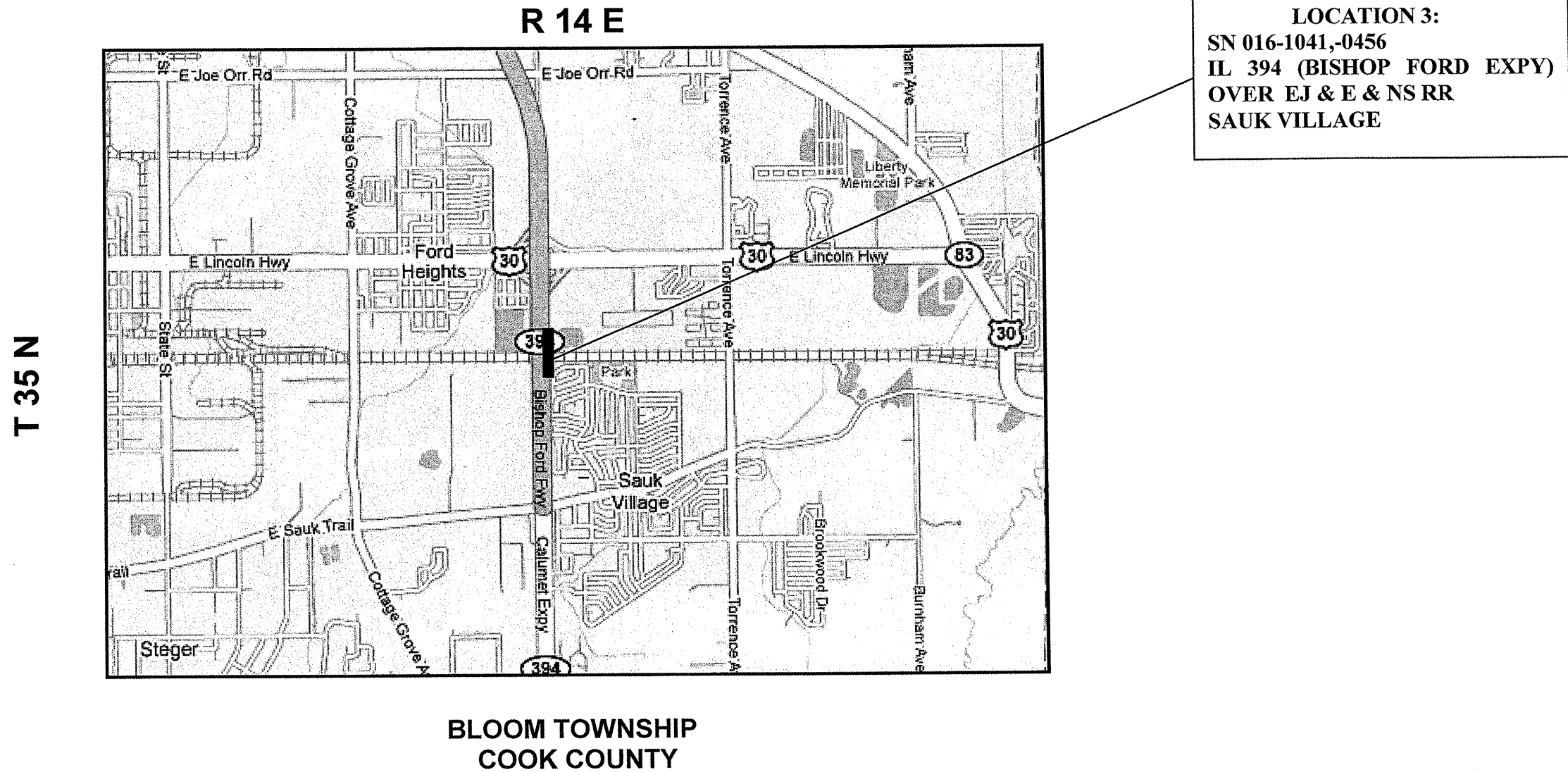

TRAFFIC DATA

2007 ADT = 19850

POSTED SPEED LIMIT = 55 MPH

ILLINOIS DEPARTMENT OF
TRANSPORTATION

LOCATION MAP

LOCATION 3: SN 016-1041, -0456