

RESTORATION OF WORK AREA.
 RESTORATION OF THE TRAFFIC SIGNAL WORK AREA SHALL BE INCIDENTAL TO THE RELATED PAY ITEM SUCH AS FOUNDATION, CONDUIT, HANDHOLE, TRENCH AND BACKFILL, ETC., AND NO EXTRA COMPENSATION SHALL BE ALLOWED. ALL ROADWAY SURFACES SUCH AS SHOULDER, MEDIAN, SIDEWALKS, PAVEMENT, ETC. SHALL BE REPLACED IN KIND. ALL DAMAGE TO MOWED LAWNS SHALL BE REPLACED WITH AN APPROVED SALT TOLERANT SOD, AND ALL DAMAGE TO UNMOWED FIELDS SHALL BE SEEDED IN ACCORDANCE WITH STANDARD SPECIFICATIONS 252 AND 250 RESPECTIVELY.

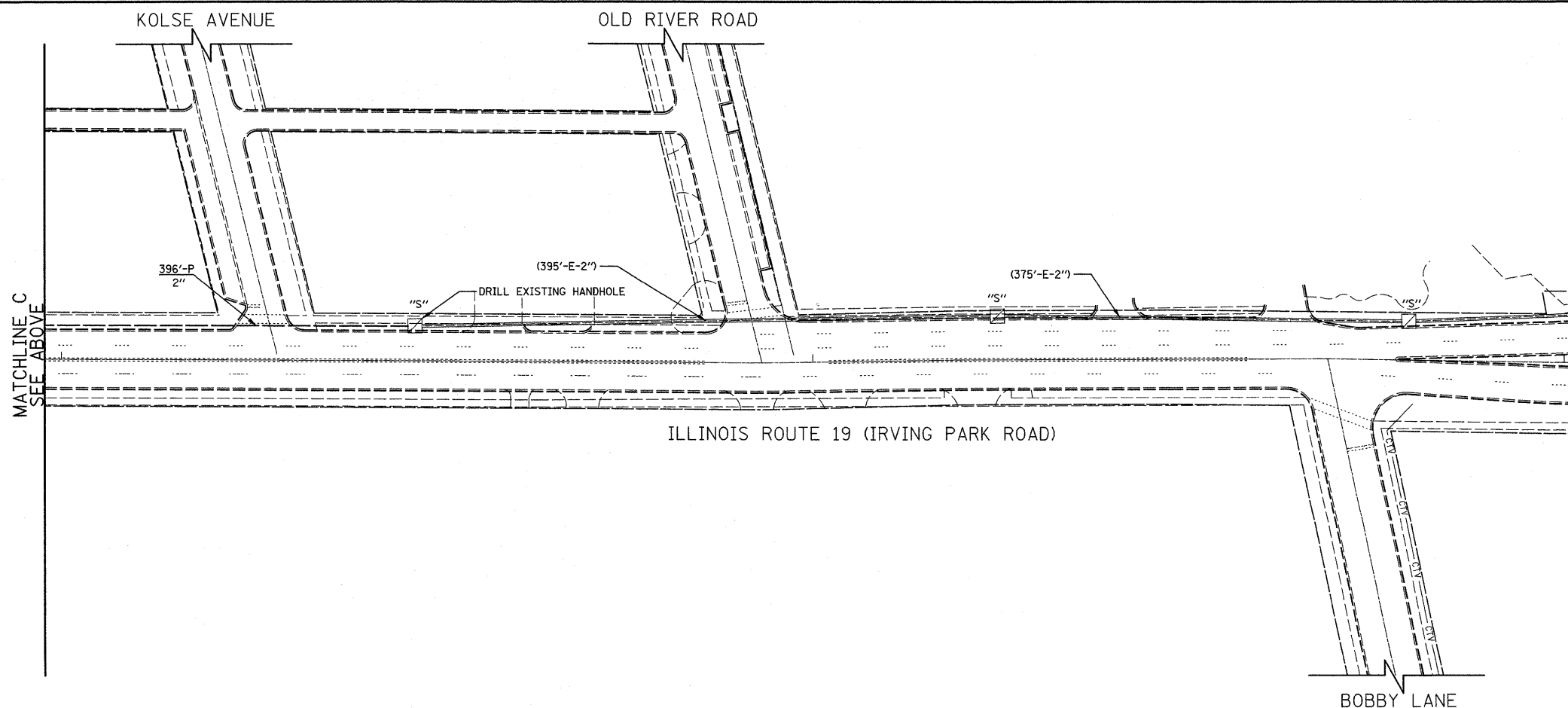
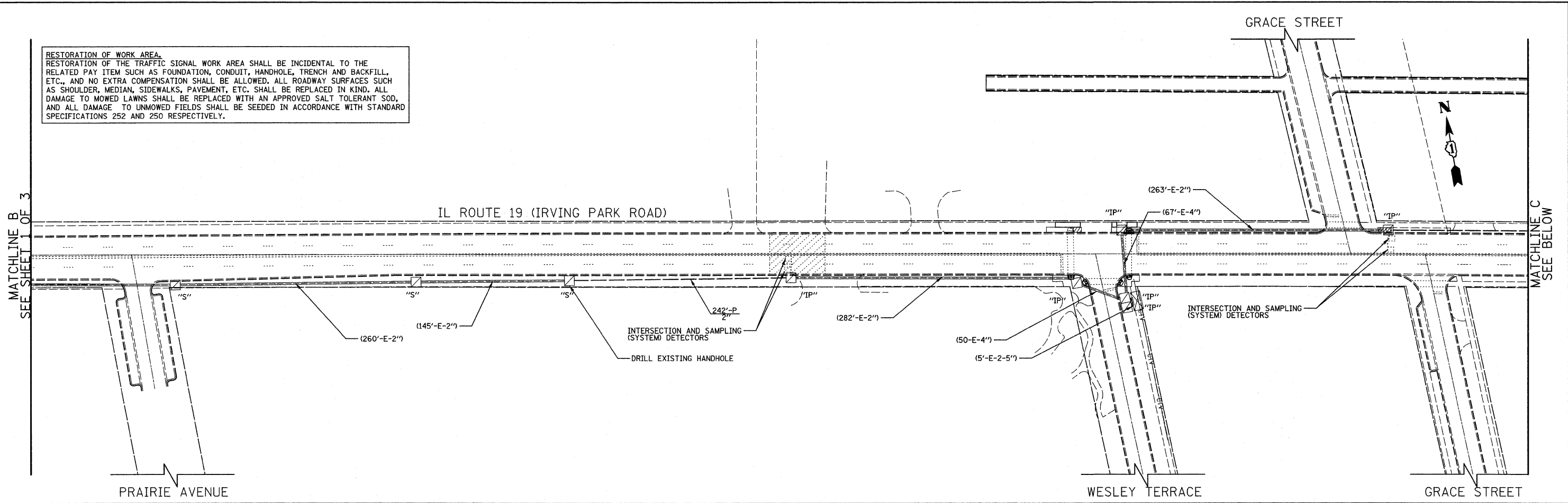

INTERCONNECT PLAN LEGEND

	EXISTING	PROPOSED
CONTROLLER		
HANDHOLE		
HEAVY DUTY HANDHOLE		
DOUBLE HANDHOLE		
G.S. CONDUIT IN TRENCH OR PUSHED		
DETECTOR LOOP		
SYSTEM	S	S
INTERSECTION	I	IP
UNIT DUCT		UD
COMMON TRENCH		CT

NOTE:
 THE TRAFFIC SIGNAL CONTROLLER EQUIPMENT FOR THIS PROJECT SHALL BE "ECONOLITE" TO MATCH THE EXISTING ADJACENT SYSTEM.

FILE NAME =	USER NAME = #USER#	DESIGNED - BRD	REVISED -	STATE OF ILLINOIS DEPARTMENT OF TRANSPORTATION	INTERCONNECT PLAN (SHEET 2 OF 3) IL ROUTE 19 (IRVING PARK RD.) - JUDD AV. TO DES PLAINES RIVER RD.		F.A.P. RTE. 345	SECTION 2009-085 TS	COUNTY COOK	TOTAL SHEETS 39	SHEET NO. 33	
#FILE#	PLOT SCALE = #SCALE#	DRAWN - JRT	REVISED -		SCALE: 1" = 50'	SHEET NO. 2 OF 3 SHEETS	STA. TO STA.	FED. ROAD DIST. NO. 7 ILLINOIS FED. AID PROJECT				
	PLOT DATE = #DATE#	CHECKED - JJE	REVISED -					CONTRACT NO. 60I27				
		DATE - 10/14/09	REVISED -									