

F.A.P. RTE.	SECTION	COUNTY	TOTAL SHEETS	SHEET NO.
3578	15VB-1-R-1	COOK	243	31
STA.		TO STA.		
FED. ROAD DIST. NO.		ILLINOIS	FED. AID PROJECT	
		CONTRACT NO. 62388		

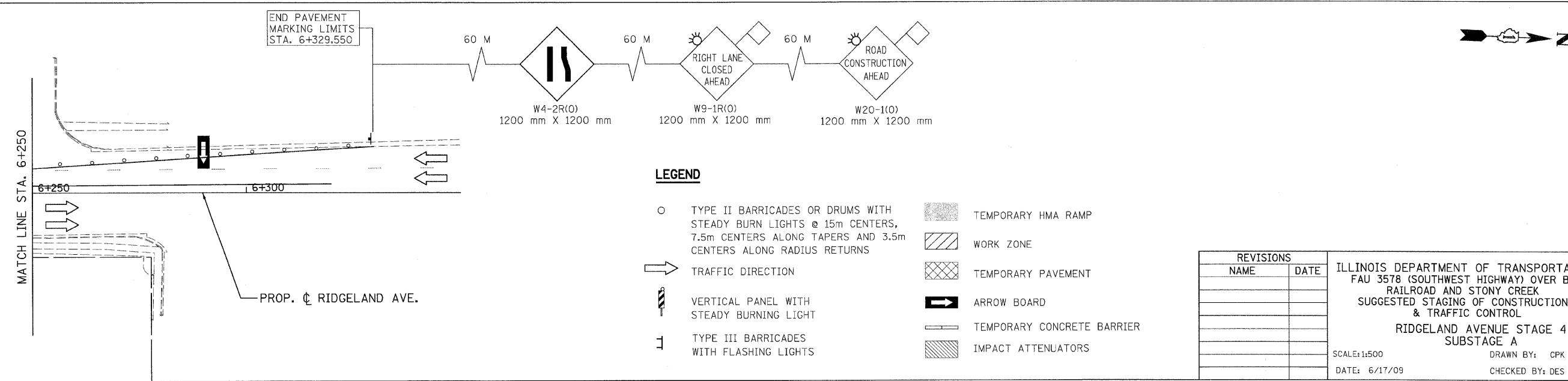
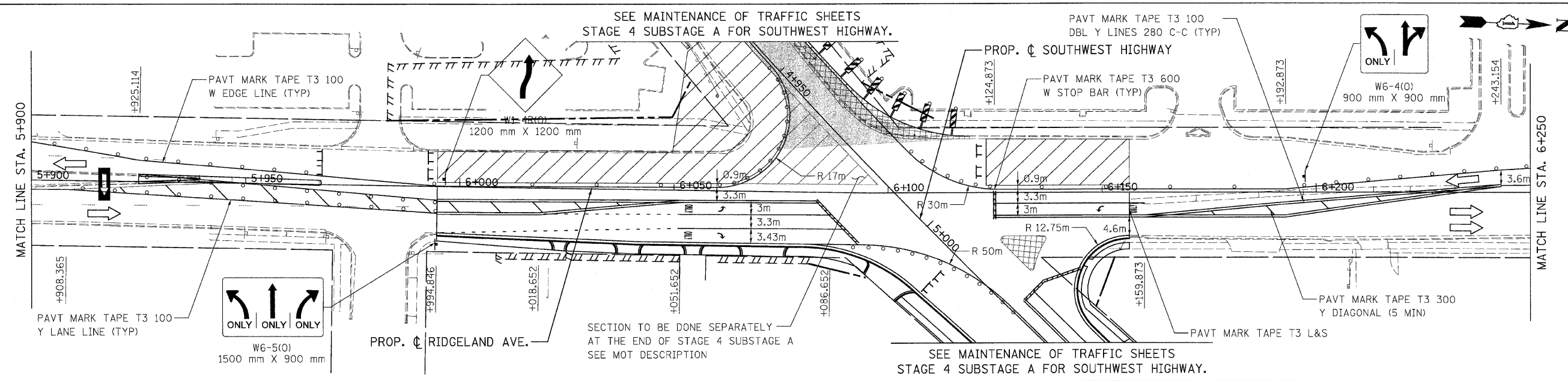
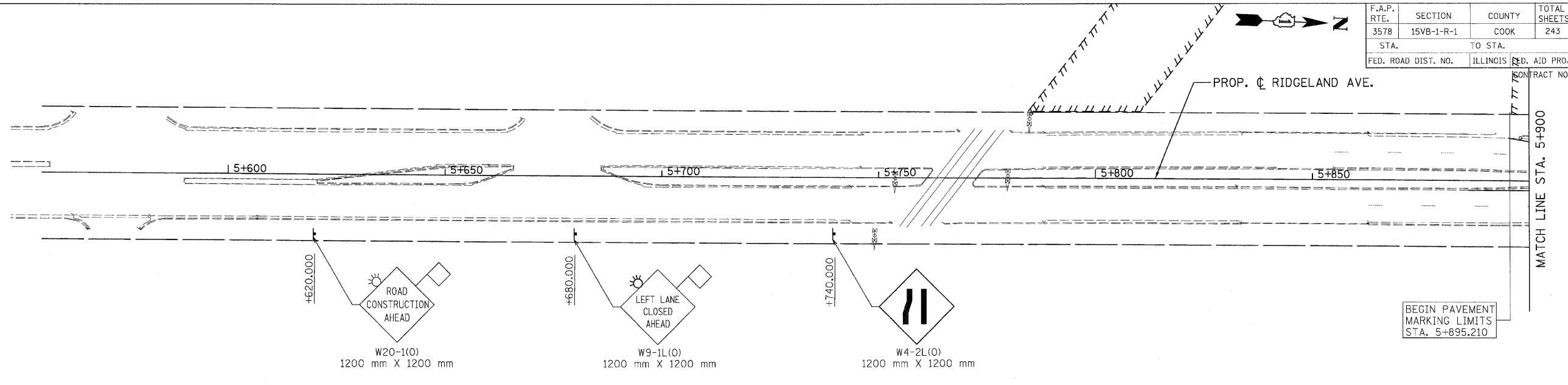

**LEGEND**

- TYPE II BARRICADES OR DRUMS WITH STEADY BURN LIGHTS @ 15m CENTERS, 7.5m CENTERS ALONG TAPERS AND 3.5m CENTERS ALONG RADIUS RETURNS
- ➔ TRAFFIC DIRECTION
- ▬ VERTICAL PANEL WITH STEADY BURNING LIGHT
- ⊥ TYPE III BARRICADES WITH FLASHING LIGHTS
- ▨ TEMPORARY HMA RAMP
- ▩ WORK ZONE
- ▧ TEMPORARY PAVEMENT
- ➡ ARROW BOARD
- ▬ TEMPORARY CONCRETE BARRIER
- ▨ IMPACT ATTENUATORS

REVISIONS	
NAME	DATE

ILLINOIS DEPARTMENT OF TRANSPORTATION  
 FAU 3578 (SOUTHWEST HIGHWAY) OVER B&O  
 RAILROAD AND STONY CREEK  
 SUGGESTED STAGING OF CONSTRUCTION  
 & TRAFFIC CONTROL  
 RIDGELAND AVENUE STAGE 4  
 SUBSTAGE A

SCALE: 1:500  
 DATE: 6/17/09  
 DRAWN BY: CPK  
 CHECKED BY: DES

PATRICK ENGINEERING INC. LISLE, ILLINOIS  
 tkoppen(Rdwy\_Lisle)  
 6/26/2009 1:35:07 AM  
 q:\DOT\9556-A0\Drawings\RDW\shfts\MOT\S.mot\_04\_10\_suba\_rdgind.dgn  
 PDF(Grey\_Large).plt