

F.A. RTE.	SECTION	COUNTY	TOTAL SHEETS	SHEET NO.
3578	15VB-1-R-1	COOK	243	36
STA.	TO STA.			
FED. ROAD DIST. NO.	ILLINOIS	FED. AID PROJECT	CONTRACT NO. 62388	

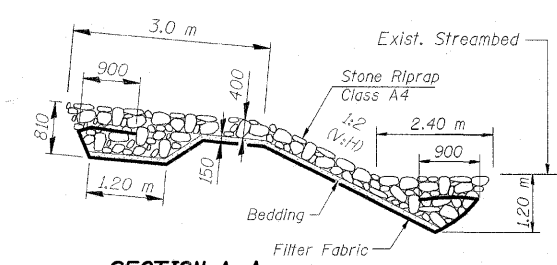
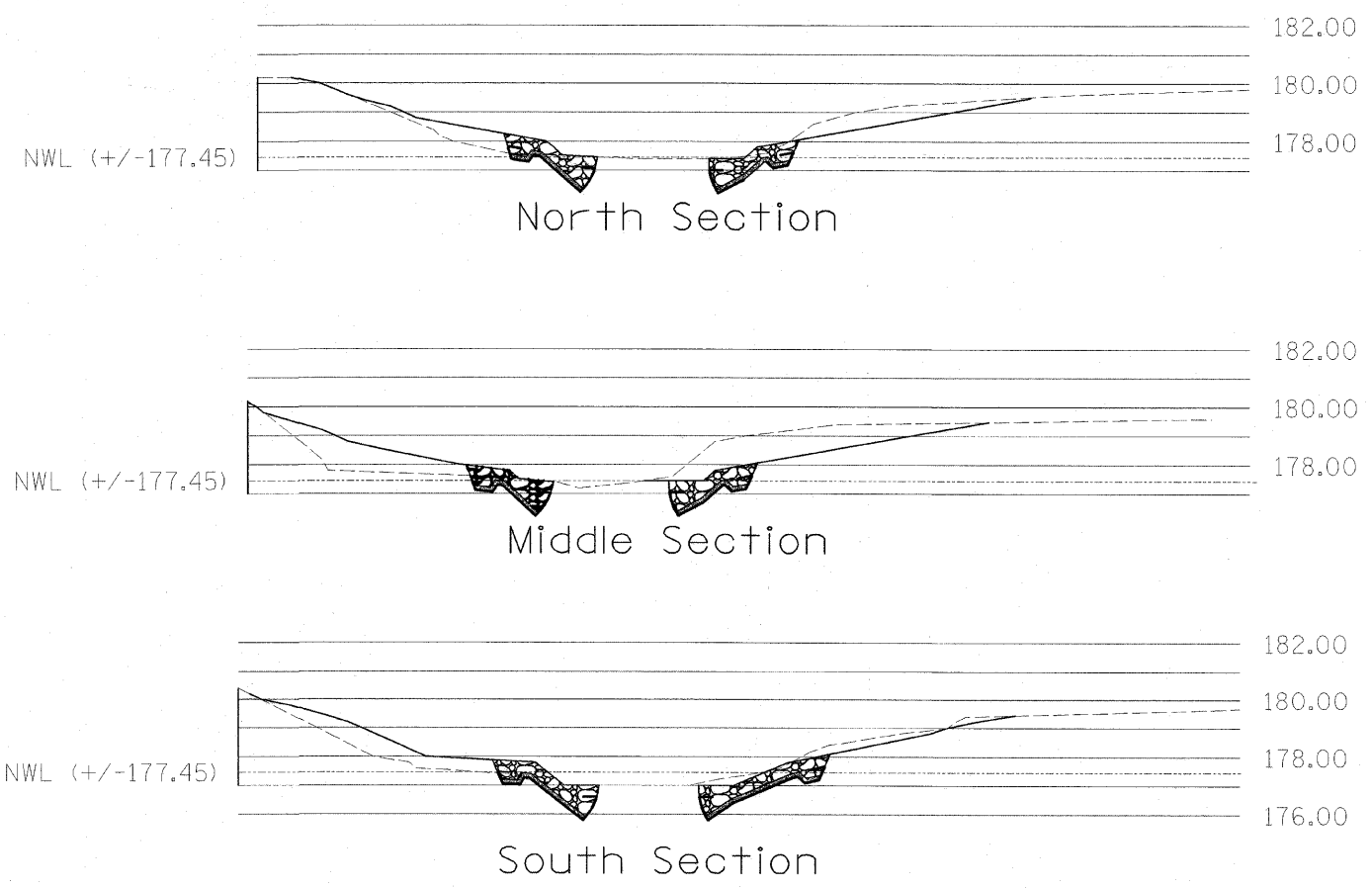
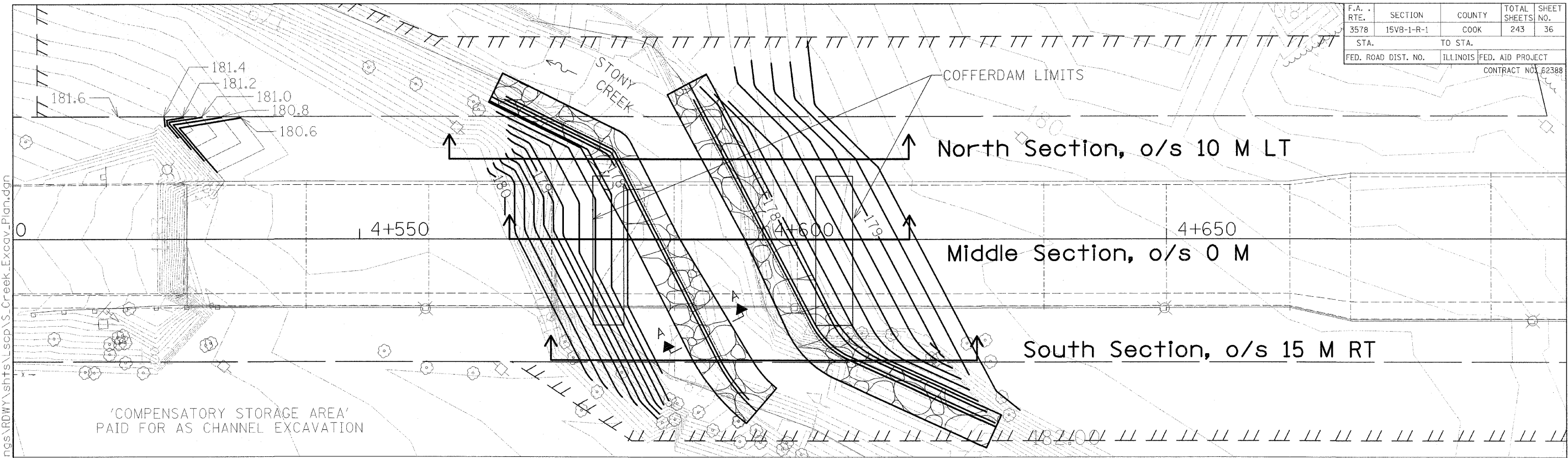

**CREEK GRADING BILL OF MATERIAL**

ITEM	UNIT	TOTAL
Channel Excavation	Cu. M	914
Stone Riprap, Class A4	Sq. M	838
Filter Fabric	Sq. M	732

REVISIONS		ILLINOIS DEPARTMENT OF TRANSPORTATION FAU 3578 (SOUTHWEST HIGHWAY) OVER B&O RAILROAD AND STONY CREEK PROPOSED GRADING PLAN FOR STONY CREEK
NAME	DATE	

SCALE: H=1:500  
V=1:2  
DATE: 05/04/09  
DRAWN BY: CDT  
CHECKED BY: ADJ

dsypien(l.isie)  
8/11/2009  
**PATRICK ENGINEERING INC.**  
LISLE, ILLINOIS

G:\DOT\9556-A0\Drawings\RDWY\shs\scop\S\_Creek\_Excav\_Plan.dgn  
12:17:50 PM  
24-0CE9400.plt