

F.A.U. RTE.	SECTION	COUNTY	TOTAL SHEETS	SHEET NO.
3578	15VB-1-R-1	COOK	243	49
STA.		TO STA.		
FED. ROAD DIST. NO.		ILLINOIS FED. AID PROJECT		
CONTRACT NO. 62388				

**JOINT LEGEND**

- (A) TRANSVERSE CONSTRUCTION JOINT,  
NO. 19 TIE BARS @ 375 CTS
- (B) LONGITUDINAL CONSTRUCTION JOINT,  
NO. 19 TIE BARS @ 600 CTS
- (C) LONGITUDINAL SAWED JOINT,  
NO. 19 TIE BARS @ 750mm EPOXY CTS

\*LONGITUDINAL CONSTRUCTION JOINT, (B),  
MAY BE USED AT NO ADDITIONAL COMPENSATION  
TO THE CONTRACTOR

tkoepfen(Rdwy\_Lis)le 6/26/2009 1:36:43 AM PDF(Grey\_Large).plt G:\DOT\9556-A0\Drawings\RDWY\shfts\DHIS\5\_INT\_01.dgn

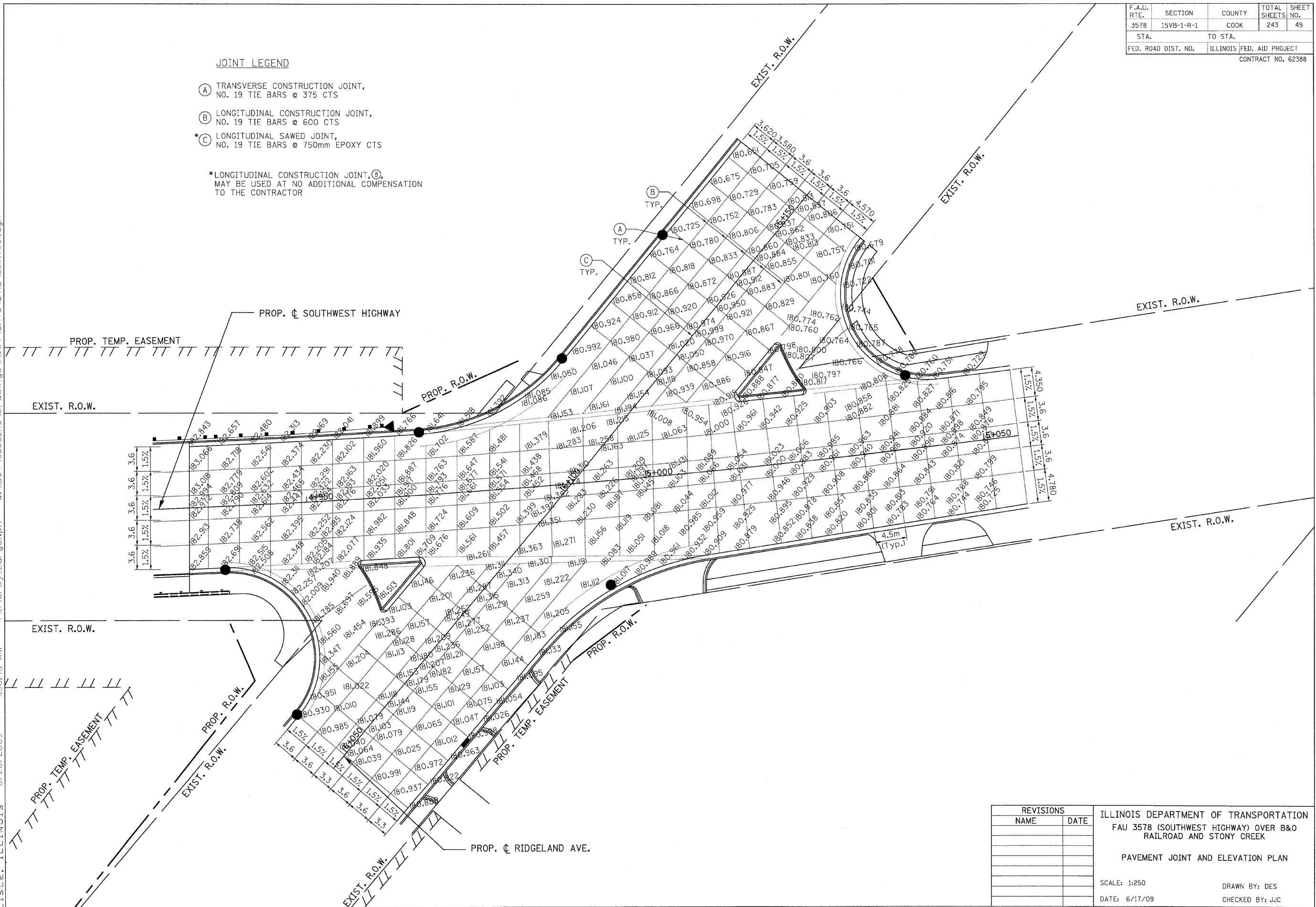

REVISIONS	
NAME	DATE

ILLINOIS DEPARTMENT OF TRANSPORTATION  
 FAU 3578 (SOUTHWEST HIGHWAY) OVER B&O  
 RAILROAD AND STONY CREEK  
 PAVEMENT JOINT AND ELEVATION PLAN  
 SCALE: 1:250  
 DATE: 6/17/09  
 DRAWN BY: DES  
 CHECKED BY: JJC

