

F.A.P. RTE.	SECTION	COUNTY	TOTAL SHEETS	SHEET NO.
3578	15VB-1-R-1	COOK	248	72
S/A.		TO STA.		
FED. ROAD DIST. NO.		ILLINOIS	FED. AID PROJECT	
CONTRACT NO. 62388				

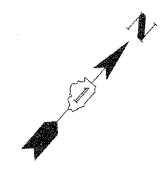

NOTES:

1. USE 18.30M LONG WOOD POLE AT THIS LOCATION TO PROVIDE A 15.2M MOUNTING HEIGHT.
2. USE 30.48M LONG WOOD POLE AT THIS LOCATION TO PROVIDE A 15.2M MOUNTING HEIGHT.
3. THE CONTRACTOR SHALL BE AWARE OF THE LONG LEAD TIME FOR ORDERING 100 FOOT TEMPORARY WOOD POLES.
4. THE EXISTING LIGHT POLES TO REMAIN SHALL BE WIRED AND FULLY OPERATIONAL AT ALL TIMES DURING AND AFTER CONSTRUCTION.

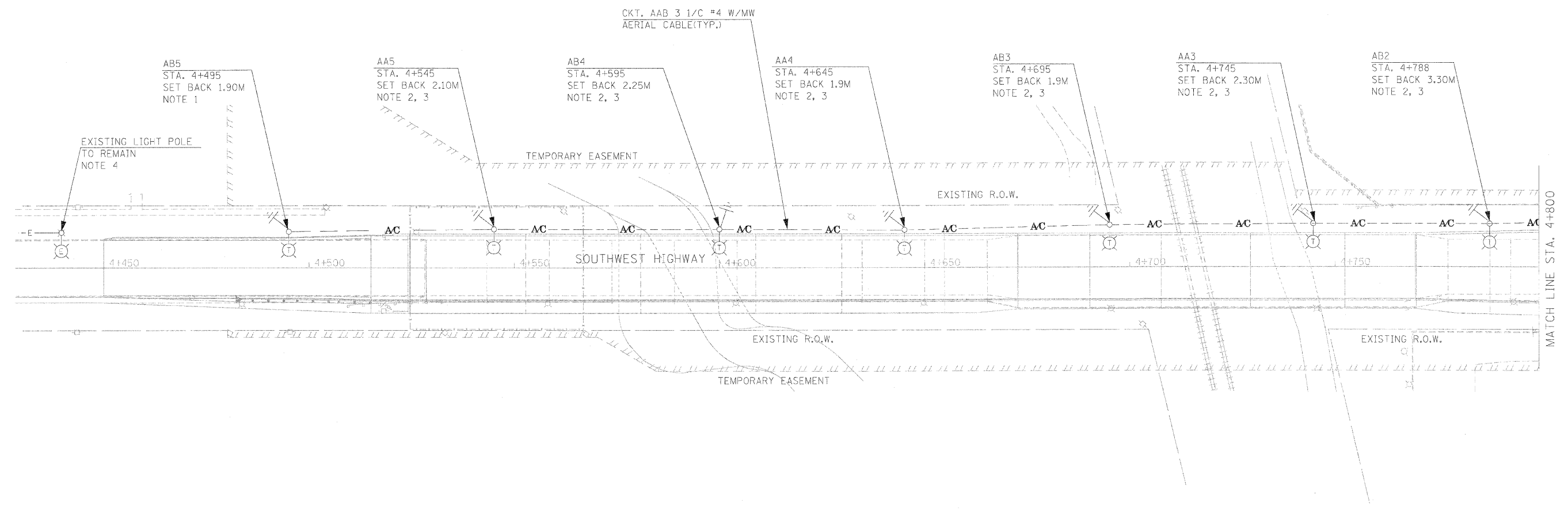

PATRICK
ENGINEERING INC.
LISLE, ILLINOIS

GA GANDHI AND ASSOCIATES, INC.
ENGINEERS AND PLANNERS
6035 N. NORTHWEST HIGHWAY
SUITE 306
CHICAGO, ILLINOIS 60631 TEL: (773) 774-5910

REVISIONS	
NAME	DATE

ILLINOIS DEPARTMENT OF TRANSPORTATION
FAU 3578 (SOUTHWEST HIGHWAY)
OVER B&O RAILROAD AND STONY CREEK
TEMPORARY ROADWAY LIGHTING
SHEET 1 OF 2
SCALE: 1:500
DATE: JUNE 17, 2009
DRAWN BY: RDP/KGP
CHECKED BY: PKG/MAE