

**NOTES:**

1. THE CONTRACTOR SHALL VERIFY IN THE FIELD THE CONNECTIONS AND WIRING OF ALL EXISTING LIGHT POLES TO BE REMOVED.
2. THE TEMPORARY LIGHTING SYSTEM MUST BE INSTALLED AND FULLY OPERATIONAL BEFORE ANY EXISTING LIGHTING UNITS ARE DISCONNECTED OR REMOVED.
3. THE CONTRACTOR SHALL DISCONNECT THE WIRING OF THE LIGHTING UNITS TO BE REMOVED AT THE CONTROLLER BEFORE THE LIGHTING UNITS ARE REMOVED.
4. THE CONTRACTOR SHALL KEEP THE EXISTING VILLAGE OF CHICAGO RIDGE LIGHTING CONTROLLER IN PLACE AND FULLY OPERATIONAL TO POWER THE EXISTING LIGHTS LOCATED OFF OF THE SOUTHWEST HIGHWAY BRIDGE. THE CONTRACTOR SHALL INSTALL ALL OF THE PROPOSED LIGHTING CONDUITS AND UNIT DUCTS TO POWER THE EXISTING LIGHT POLES THAT WILL REMAIN ON SOUTHWEST HIGHWAY BEFORE THE EXISTING CONTROLLER IS REMOVED AS SHOWN ON THESE PLANS.
5. THE CONTRACTOR SHALL DISCONNECT THE SERVICE FEEDER CABLES AT THE LIGHTING CONTROLLER, AND REMOVE THE EXISTING ELECTRIC SERVICE INSTALLATION EQUIPMENT. THAT SHALL NOT TAKE PLACE UNTIL THE EXISTING LIGHT POLES TO REMAIN HAVE BEEN CONNECTED TO THE NEW VILLAGE LIGHTING CONTROLLER, AND ARE FULLY OPERATIONAL.
6. ALL EXISTING CONDUITS AND UNIT DUCTS THAT ARE CONNECTED TO ANY EXISTING LIGHT POLES THAT ARE AFFECTED BY THE LIGHTING IMPROVEMENTS MUST BE FIELD VERIFIED BY THE CONTRACTOR. THIS IS DUE TO THE LACK OF AS BUILT LIGHTING PLANS THAT SHOW THE EXISTING UNDERGROUND WIRING, AND CONDUIT/UNIT DUCT ROUTING. MINOR FIELD ADJUSTMENTS AND/OR MODIFICATIONS MAYBE NECESSARY BASED ON THE FINDINGS BY THE CONTRACTOR, AND ANY CHANGES OR DEVIATION FROM THESE PLANS MUST BE APPROVED BY THE RESIDENT ENGINEER BEFORE ANY WORK CAN BEGIN.

F.A.P. RTE.	SECTION	COUNTY	TOTAL SHEETS	SHEET NO.
3578	15VB-1-R-1	COOK	248	74
STA.		TO STA.		
FED. ROAD DIST. NO.		ILLINOIS	FED. AID PROJECT	

CONTRACT NO. 62388

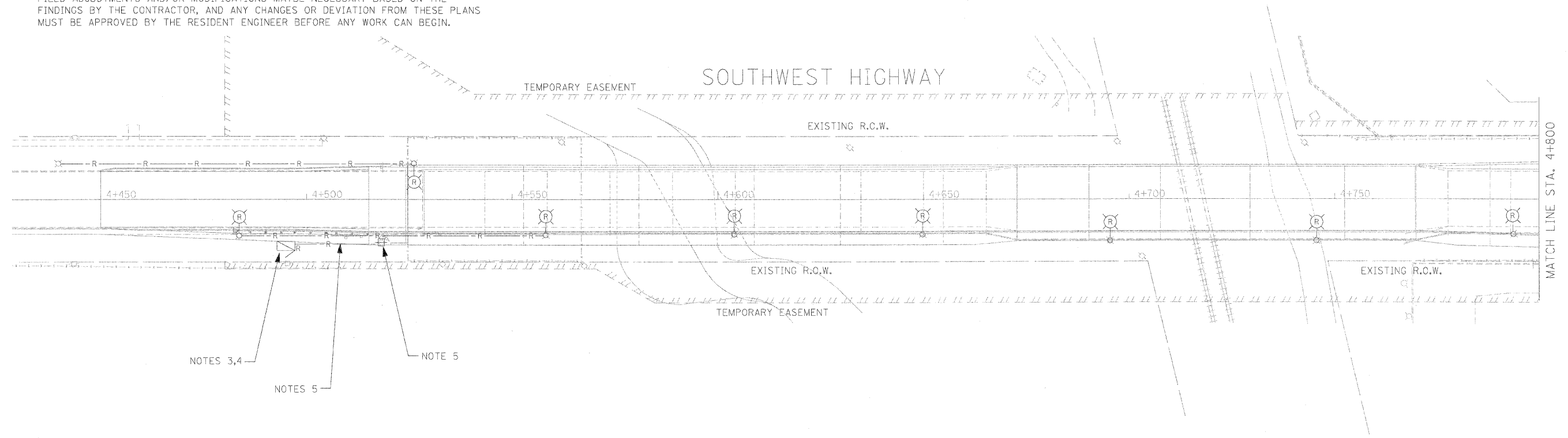
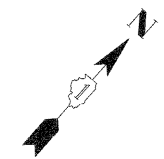

**PATRICK**  
ENGINEERING INC.  
LISLE, ILLINOIS

**GA**  
GANDHI AND ASSOCIATES, INC.  
ENGINEERS AND PLANNERS  
6035 N. NORTHWEST HIGHWAY  
SUITE 306  
CHICAGO, ILLINOIS 60631 TEL: (773) 774-5910

REVISIONS	
NAME	DATE

ILLINOIS DEPARTMENT OF TRANSPORTATION  
FAU 3578 (SOUTHWEST HIGHWAY)  
OVER B&O RAILROAD AND STONY CREEK  
  
LIGHTING REMOVAL PLAN  
SHEET 1 OF 2  
  
SCALE: 1:500  
DATE: JUNE 17, 2009  
DRAWN BY: RDP/KGP  
CHECKED BY: PKG/MAE