

F.A.P. RTE.	SECTION	COUNTY	TOTAL SHEETS	SHEET NO.
3578	15VB-1-R-1	COOK	248	76
STA. _____		TO STA. _____		
FED. ROAD DIST. NO. _____		ILLINOIS FED. AID PROJECT		
CONTRACT NO. 62388				

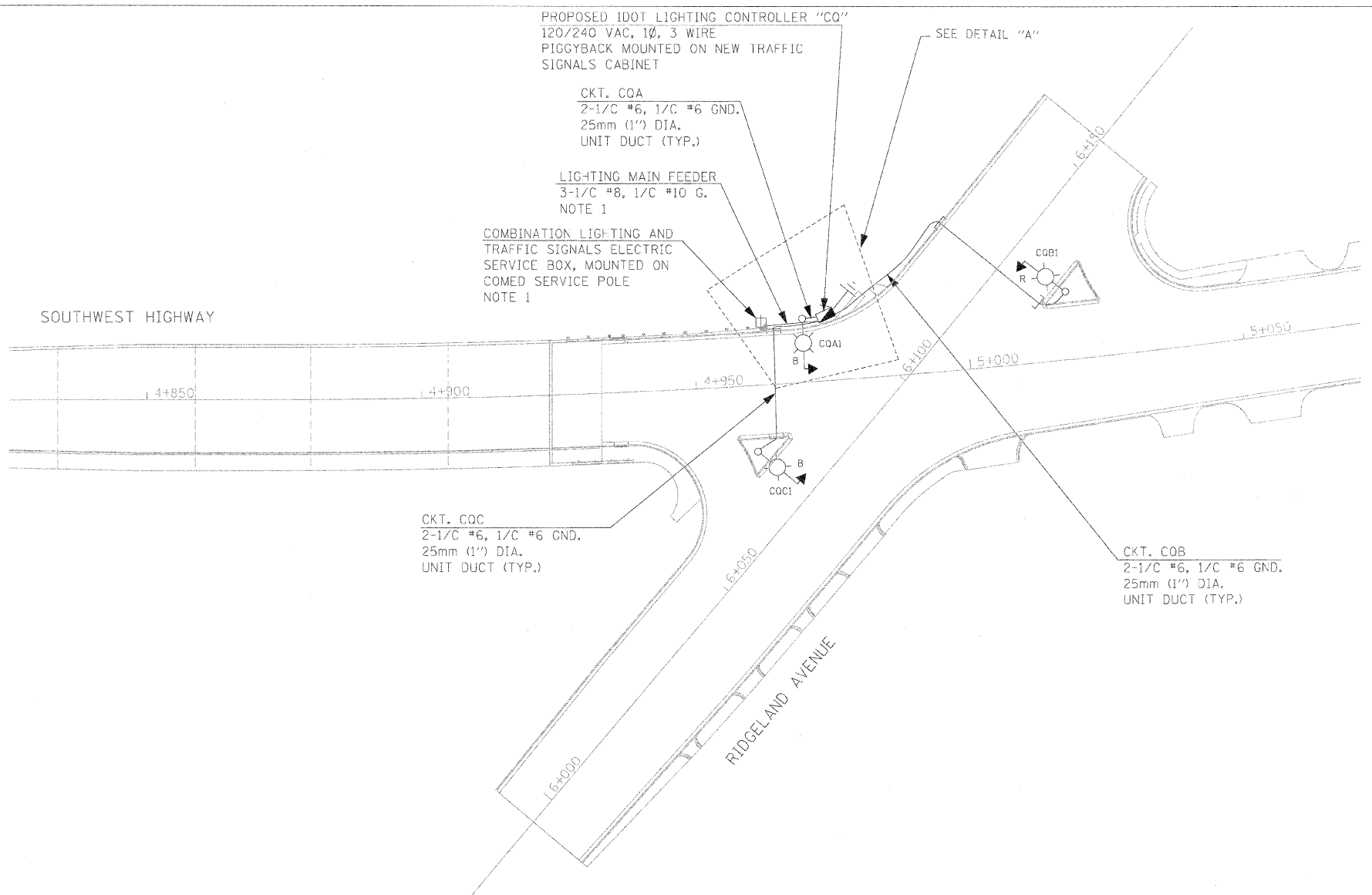

LOAD TABLE  
PROPOSED IDOT LIGHTING CONTROLLER "CO"

CIRCUIT	BLACK PHASE		CIRCUIT	RED PHASE	
	AMPS	WATTS		AMPS	WATTS
A	2.1	504	B	2.1	504
C	2.1	504			
TOTAL	4.2	1008	TOTAL	2.1	504

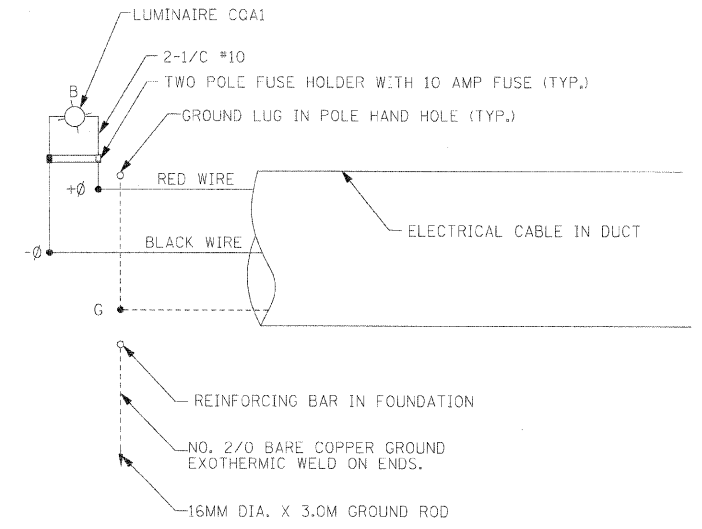

DETAIL "A"  
LUMINAIRE WIRING CONNECTION (TYP.)

**LEGEND**

- PROPOSED COMBINATION LIGHTING UNIT  
13.72M M.H., 4.5M M.A., 400W 240V HPS LUMINAIRE (BLACK PHASE)
- PROPOSED COMBINATION LIGHTING UNIT  
13.72M M.H., 4.5M M.A., 400W 240V HPS LUMINAIRE (RED PHASE)
- PROPOSED LIGHTING CONTROLLER, PEDESTAL MOUNTED
- ELECTRIC UTILITY POLE WITH COMBINATION LIGHTING AND TRAFFIC SIGNALS ELECTRIC SERVICE BOX
- ELECTRIC GROUND ROD

NOTE:  
1. THE SERVICE FEEDER CABLES ARE INSTALLED FROM THE COMED POLE MOUNTED COMBINATION LIGHTING AND TRAFFIC SIGNALS ELECTRIC SERVICE BOX. SEE DETAIL BE-230 FOR MORE INFORMATION.

REVISIONS	
NAME	DATE

ILLINOIS DEPARTMENT OF TRANSPORTATION  
FAU 3578 (SOUTHWEST HIGHWAY)  
OVER B&O RAILROAD AND STONY CREEK  
PROPOSED ROADWAY LIGHTING  
SINGLE LINE DIAGRAM  
IDOT CONTROLLER "CO"  
SCALE: 1:500  
DATE: JUNE 17, 2009  
DRAWN BY: RD-P/KGP  
CHECKED BY: PKG/MAE

**GA** GANDHI AND ASSOCIATES, INC.  
ENGINEERS AND PLANNERS  
6035 N. NORTHWEST HIGHWAY  
SUITE 306  
CHICAGO, ILLINOIS 60631 TEL: (773) 774-5910

**PATRICK**  
ENGINEERING INC.  
JULIE, ILLINOIS