

F.A.U. RTE.	SECTION	COUNTY	TOTAL SHEETS	SHEET NO.
3578	15V B-1-R-1	COOK	243	89
STA.		TO STA.		
FED. ROAD DIST. NO.		ILLINOIS	FED. AID PROJECT	
CONTRACT NO. 62388				

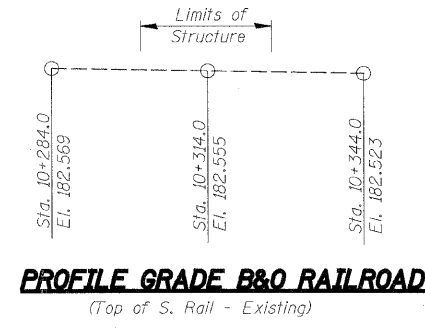
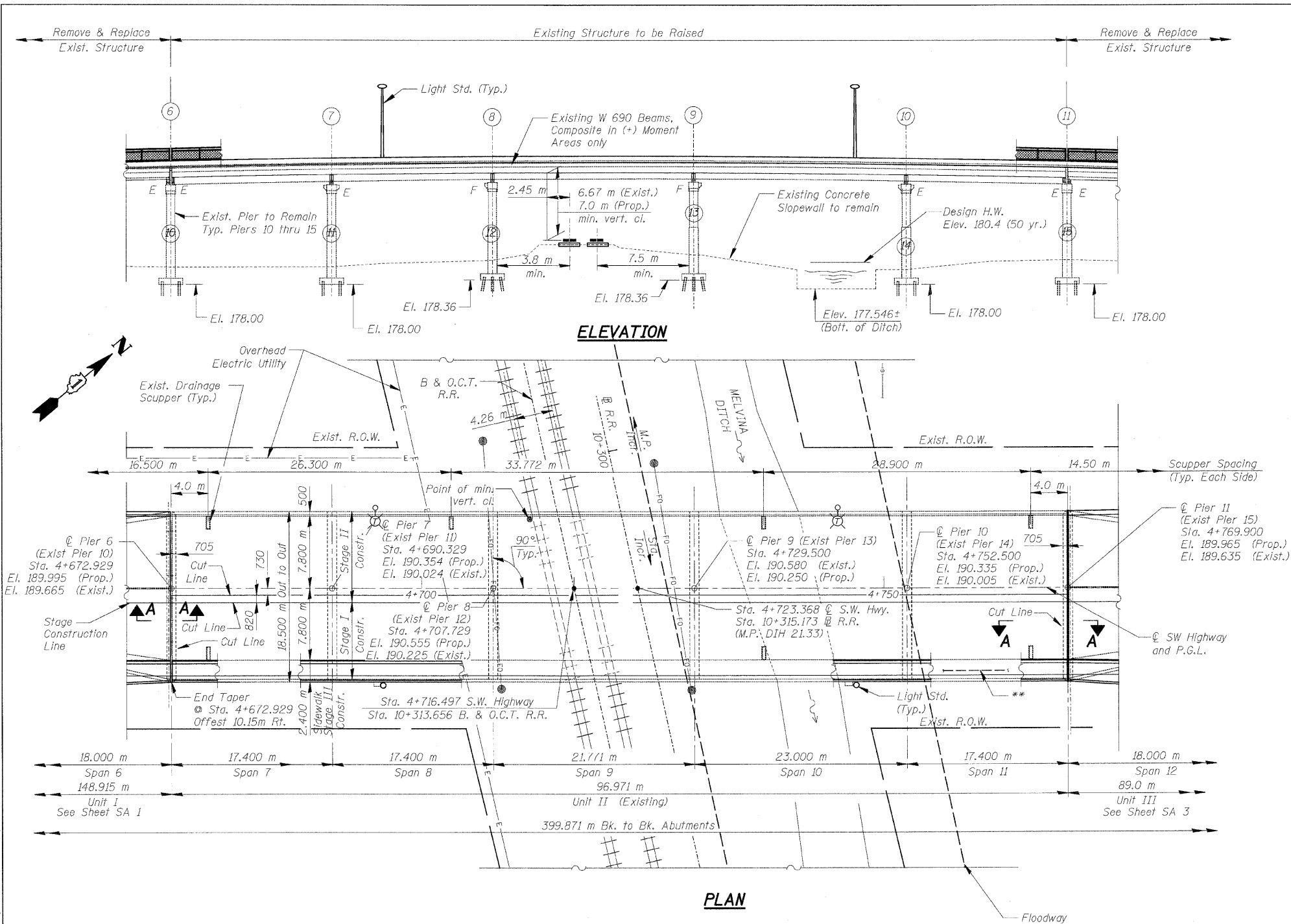

CONDUIT NOTE:

1. Install 50-mm (2-inch) Dia. PVC coated rigid conduit for future interconnect. The conduit shall be securely fastened to the bridge, see Section 811 of the Standard Specifications for conduit installation and support. The contractor shall provide expansion fittings or liquid tight flexible metal conduit loops to match the locations of the expansion joints in the bridge deck. Expansion fittings shall be capable of a 6-inch (150-mm) total movement. Pull boxes shall be furnished and installed in accordance with Section 813. The contractor shall provide pull boxes at a maximum spacing of 150-m with a minimum of one pull box provided between expansion fittings. The conduit shall extend beyond the ends of the approach slabs and daylight into the side slope. The ends of the conduit shall be capped.
2. See lighting plans for details of conduit for roadway lighting.

REVISIONS		ILLINOIS DEPARTMENT OF TRANSPORTATION GENERAL PLAN AND ELEVATION UNIT II SOUTHWEST HIGHWAY OVER B&O RAILROAD AND STONY CREEK FAU 3578 SECTION 15V B-1-R-1 STRUCTURE NUMBER 016-2771 COOK COUNTY STATION 4+716.497
NAME	DATE	
		SCALE: NONE DATE: 6/17/09
		DRAWN BY: E. Mroozek CHECKED BY: G. Hatlestad



G:\DOT\9556_A0\Drawings\STRUCT\02_pgez.dgn
 5/26/2009 1:37:33 AM
 kkeppert\rdwy.lisle