

F.A.U. RTE.	SECTION	COUNTY	TOTAL SHEETS	SHEET NO.
3578	15V B-1-R-1	COOK	243	97
STA.	TO STA.			
FED. ROAD DIST. NO.	ILLINOIS	FED. AID PROJECT		
	CONTRACT NO. 62388			

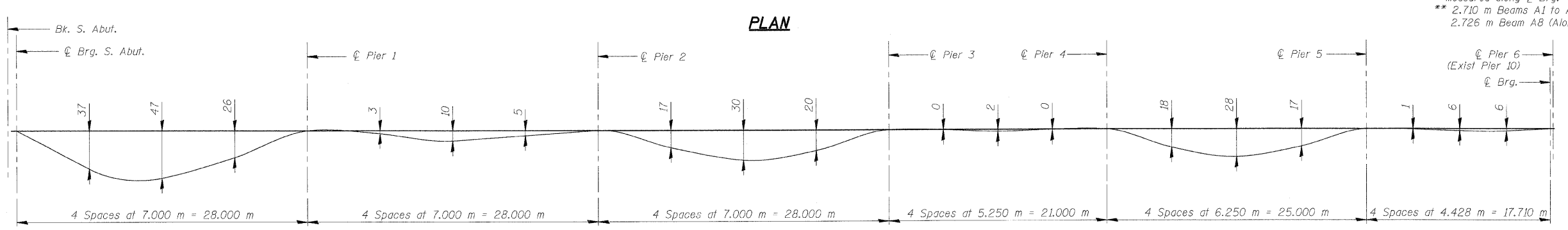

DEAD LOAD DEFLECTION DIAGRAM

(Includes the weight of concrete only)
 Note: The above deflections are not to be used in the field if the Engineer is working from the Theoretical Grade Elevations Adjusted for Dead Load Deflections as shown on sheets SA10 thru SA12.

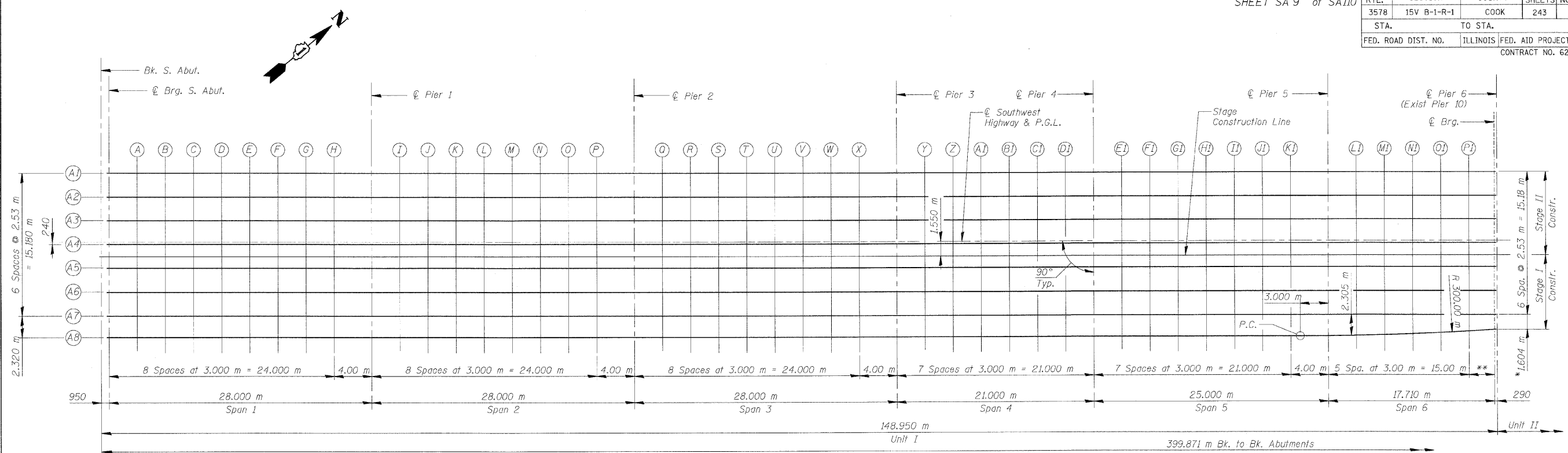
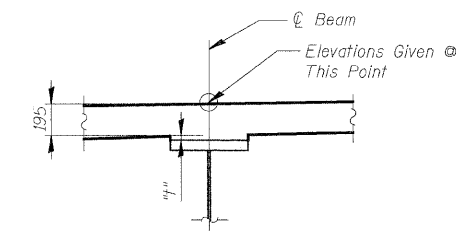

To determine "t", after all structural steel has been erected, elevations of the top flanges of the beams shall be taken at intervals shown on sheets SA9 thru SA11. These elevations subtracted from the "Theoretical Grade Elevations Adjusted For Dead Load Deflections" shown on sheets SA9 thru SA11, minus slab thickness, equals the fillet height "t" above top flange on girder.

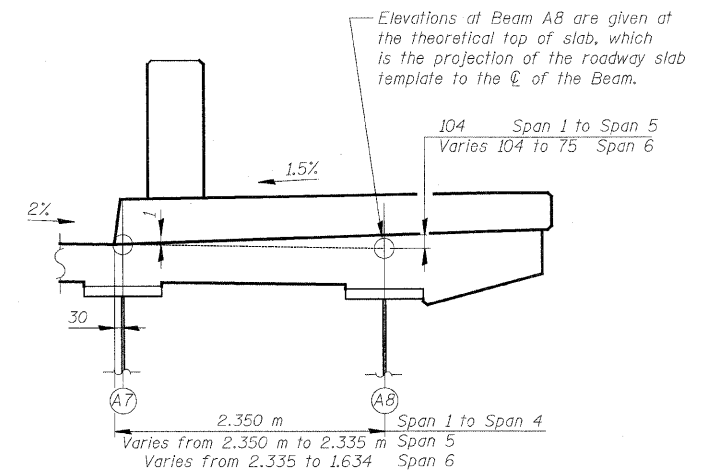

LOCATION OF ELEVATIONS AT FASCIA BEAM

REVISIONS		ILLINOIS DEPARTMENT OF TRANSPORTATION
NAME	DATE	
		TOP OF SLAB ELEVATIONS - UNIT I - A SOUTHWEST HIGHWAY OVER B&O RAILROAD AND STONY CREEK FAU 3578 SECTION 15V B-1-R-1 STRUCTURE NUMBER 016-2771 COOK COUNTY STATION 4+716.497 SCALE: NONE DRAWN BY: E. Mroozek DATE: 6/17/09 CHECKED BY: G. Hatlestad

G:\DOT\9556.A0\Drawings\STRUCT\09_Top_slab Elev UNIT I.A.dgn
 6/25/2009 10:58:50 AM
 tkp\pct\rdwy.L\lisa

