

**TYPE II ELASTOMERIC EXP. BRG.**

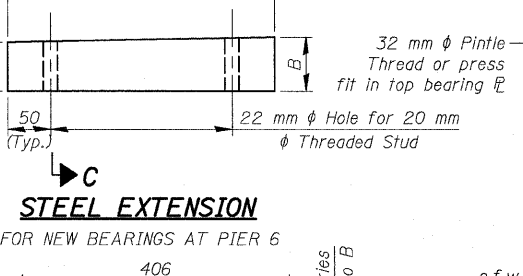

**TYPE II ELASTOMERIC EXP. BRG.**

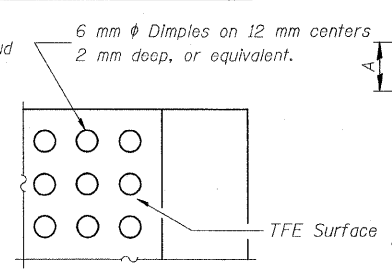
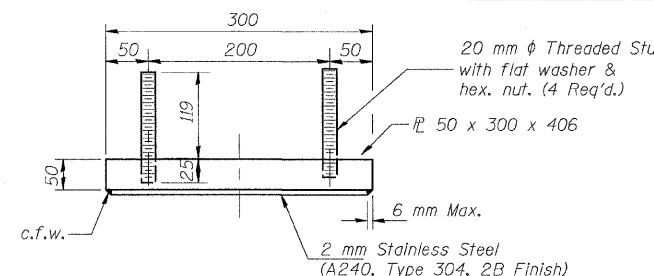
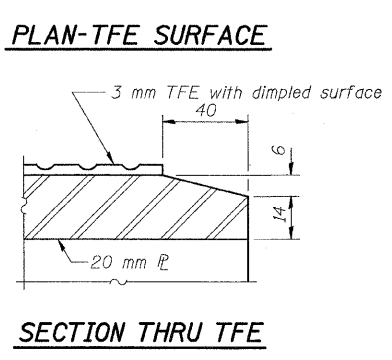
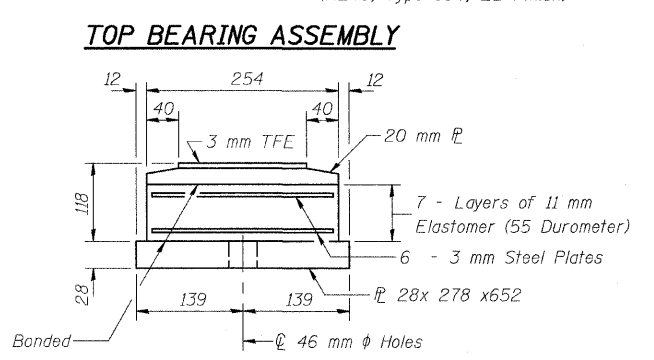
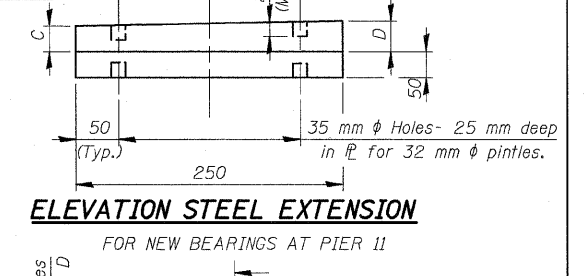
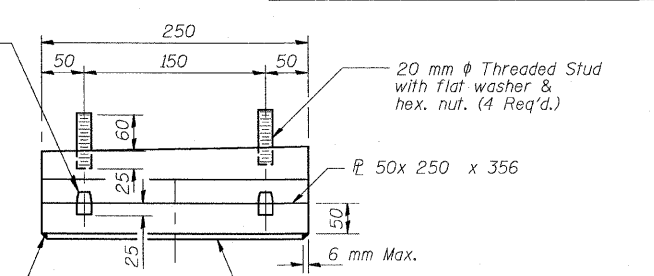

**SECTION C-C STEEL EXTENSION DIMENSIONS**

Bearing Location	Pier 6				Pier 11			
	A	B	C	D	A	B	C	D
Beam 1	39	49	33	43				
Beam 2	43	53	53	63				
Beam 3	45	55	34	44				
Beam 4	40	50	34	44				
Beam 5	32	42	34	44				
Beam 6	30	40	33	43				
Beam 7	24	34	33	43				
Beam 8	39	49	33	43				
Beam 9	-	-	55	65				
Beam 10	-	-	30	40				

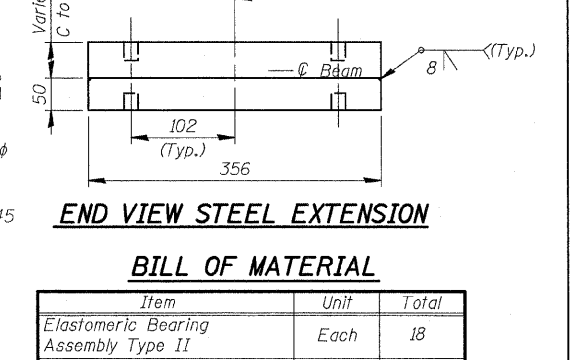
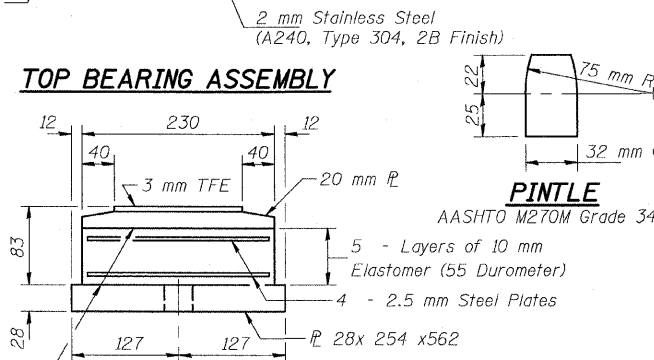

**BILL OF MATERIAL**

Item	Unit	Total
Elastomeric Bearing Assembly Type II	Each	18
Anchor Bolts, M24	Each	20
Anchor Bolts, M30	Each	16

- NOTES**
- Prior to ordering any material, the Contractor shall verify existing bridge seat elevations, all bearing height, and proposed bottom of beam elevations prior to fabrication of Steel Extensions.
  - Cost of steel extensions is included with Furnishing and Erecting Structural Steel.
  - See Sheet SA40 for Setting Anchor Bolts at Expansion Bearing.
  - See Sheet SA46 for Anchor Bolt Installation.

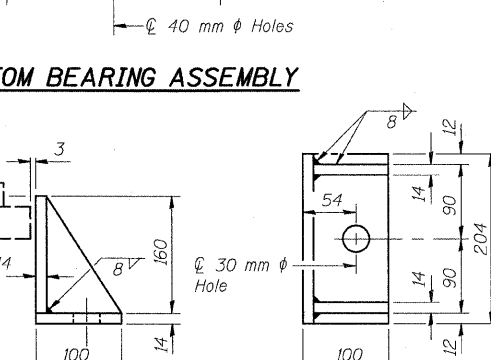
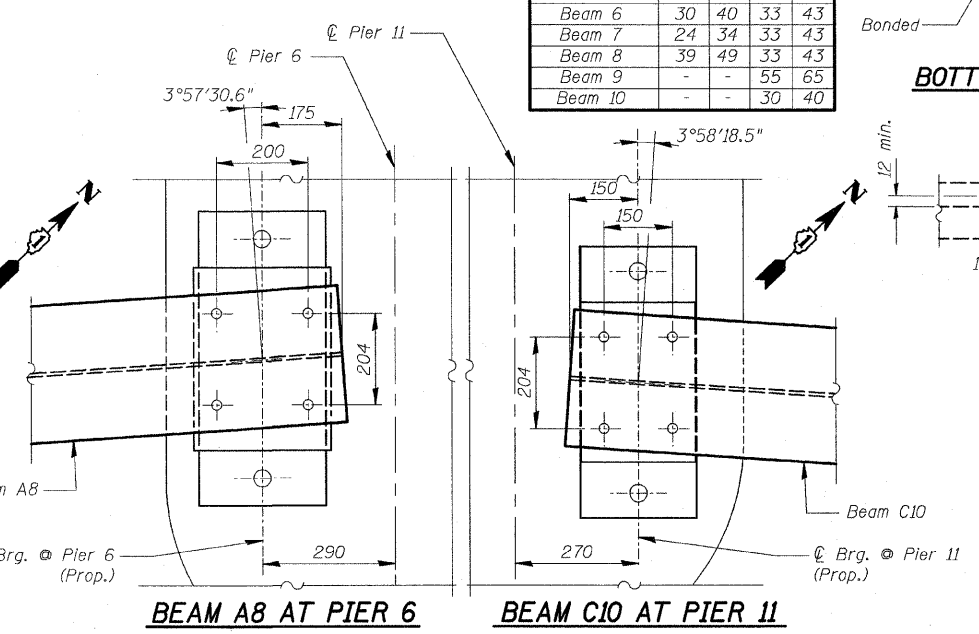
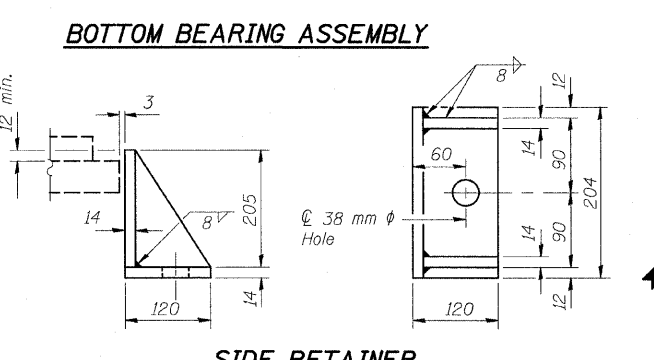

**REVISIONS**

NAME	DATE

**ILLINOIS DEPARTMENT OF TRANSPORTATION BEARING DETAILS PIERS 6 & 11**

**SOUTHWEST HIGHWAY OVER B&O RAILROAD AND STONY CREEK**

FAU 3578 SECTION 15V B-1-R-1  
STRUCTURE NUMBER 016-2771  
COOK COUNTY STATION 4+716.497

SCALE: NONE DRAWN BY: M. Tryon  
DATE: 6/17/09 CHECKED BY: G. Hattestad