

F.A.P. RTE.	SECTION	COUNTY	TOTAL SHEETS	SHEET NO.
326		McHENRY	502	187
STA. 9+35.22		TO STA. 142+08.53		
FED. ROAD DIST. NO. ILLINOIS FED. AID PROJECT				
• (105X & 106) WRS-2				

**LEGEND:**

- W— 12"— EXISTING WATER MAIN
- W— 12"— PROPOSED WATER MAIN
- - - - - EXISTING SANITARY SEWER
- - - - - PROPOSED SANITARY SEWER
- PROPOSED VALVE VAULT
- PROPOSED MANHOLE
- OR ○ EXISTING VALVE/MANHOLE
- PROPOSED FIRE HYDRANT
- EXISTING FIRE HYDRANT
- PROPOSED REDUCER
- PROPOSED PLUG
- ✕ REMOVE VALVE/MANHOLE
- ✕ REMOVE FIRE HYDRANT
- - - - - REMOVE SANITARY SEWER
- W— 12"— REMOVE WATER MAIN

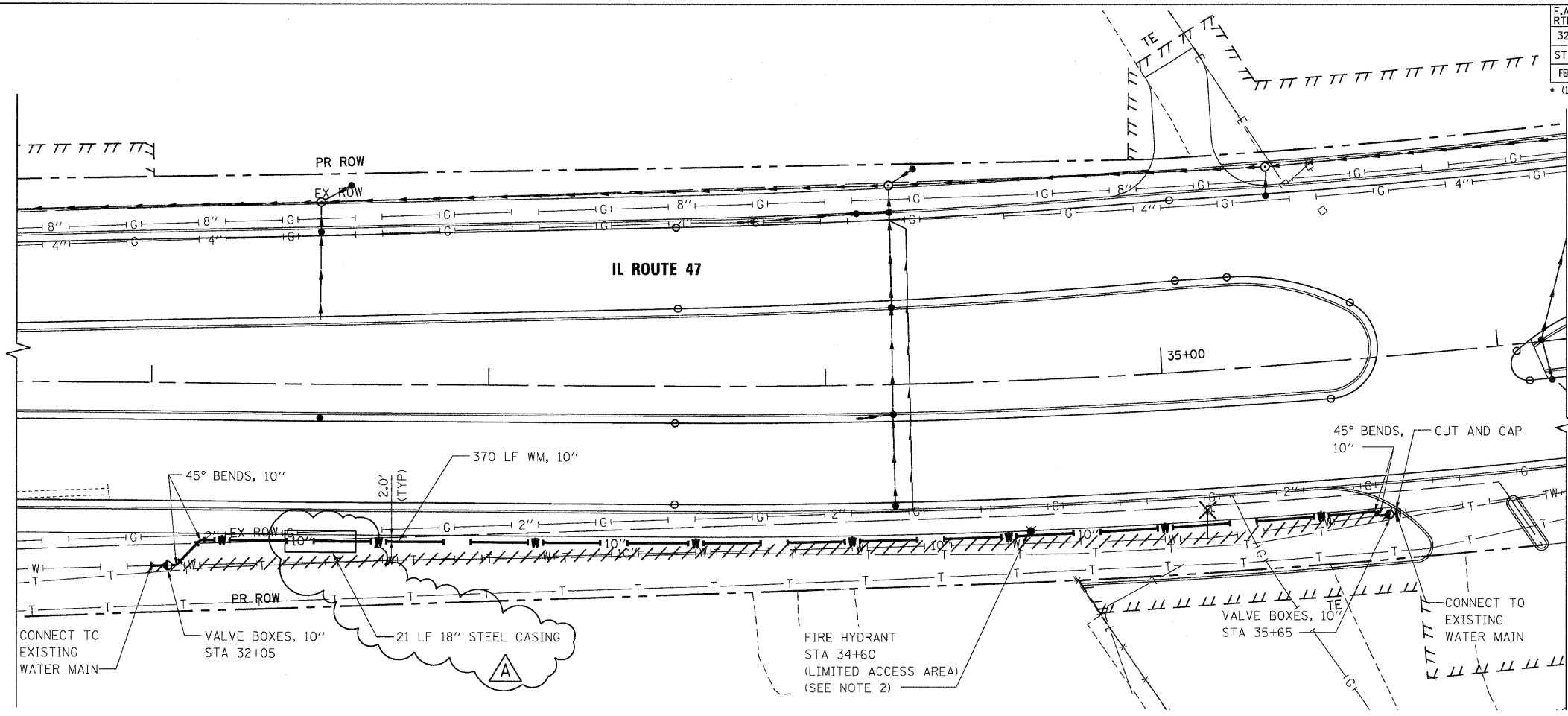

- NOTES:**
- REFER TO DRAINAGE AND UTILITIES PLAN SHEETS FOR ADDITIONAL INFORMATION.
  - INSTALLED FIRE HYDRANT SHALL BE LOCATED OUTSIDE PROPOSED SIDEWALK.
  - CONTRACTOR SHALL VERIFY MIN. 5' DEPTH OF COVER PROVIDED OVER PROPOSED WATER MAIN.

REVISIONS	
NAME	DATE
ADDENDUM A	12/21/09

PLAN	SURVEYED	DATE
	BY	
	DATE	
	BY	
	DATE	
	BY	
	DATE	

PROFILE	SURVEYED	DATE
	BY	
	DATE	
	BY	
	DATE	
	BY	
	DATE	

PLOT DATE = Thursday, December 17, 2009  
 FILE NAME = S:\11-CADD\108-187-187-187.dgn  
 PLOT SCALE = 20:1  
 USER NAME = 36198

