

STATE OF ILLINOIS
DEPARTMENT OF TRANSPORTATION

ROUTE NO.	SECTION	COUNTY	TOTAL SHEETS	SHEET NO.
FAP 326	★	McHENRY	502	330
FED. ROAD DIST. NO. 1	ILLINOIS	FED. AID PROJECT-	326	

Contract No. 62882
★ (105X & 106)WRS-2

LOADING HS20-44
Allow 50#/sq. ft. for future wearing surface.

DESIGN SPECIFICATIONS
2002 AASHTO Standard Specification
for Highway Bridges

DESIGN STRESSES

FIELD UNITS
f'c = 3,500 psi
fy = 60,000 psi (reinforcement)

SCOPE OF WORK

1. Remove Existing Single Span Bridge.
2. Construct New Reinforced Cast-in-Place Triple Cell Concrete Box Culvert

STATION 25+24.62
BUILT 200 BY
STATE OF ILLINOIS
F.A.P. RT. 326 SEC. (105X & 106)WRS-2
LOADING HS20
STRUCTURE NO. 056-0085

NAME PLATE
See Std. 515001

LEGEND

- Temporary Soil Retention System (TSRS)
- * Local cross slope around culvert ends
- ** Varies from 0'-0" at Sta 27+16.52 to 24'-0" at Sta 24+70.64
- *** At downstream End of Culvert
- † Dimensions taken from Tangent at Sta 25+24.62 and \odot Culvert Intersection
- †† Varies from 30'-0" at Sta 27+16.52 to 6'-0" at Sta 24+70.64
- SB-01 Soil Boring Location



Expiration Date: 11-30-
Date:

Stanley Consultants INC.
6001 West Higgins Road, Suite 730, Chicago, Illinois 00681-2801
www.stanleyconsultants.com
Illinois Firm Registration No. 1184-001633

GENERAL PLAN
IL ROUTE 47 OVER
S. BRANCH KISHWAUKEE RIVER
F.A.P. 326 - SECT. (105X & 106)WRS-2
McHENRY COUNTY
STATION 25+24.62
STRUCTURE NO. 056-0085

Bench Mark: BM #8 - Southeast corner of IL Route 47 bridge. Elev 877.46

Existing Structure: S.N. 056-0026 originally built in 1931, widened and reconstructed in 1966. Superstructure is a single span cast-in-place concrete slab. Substructure elements are closed abutments on spread footings. Back to back abutment dimension is 28'-8³/₈", width out to out is 46'-6".

Structure to be removed and replaced using staged construction.

Precast alternate is not allowed.

No Salvage.

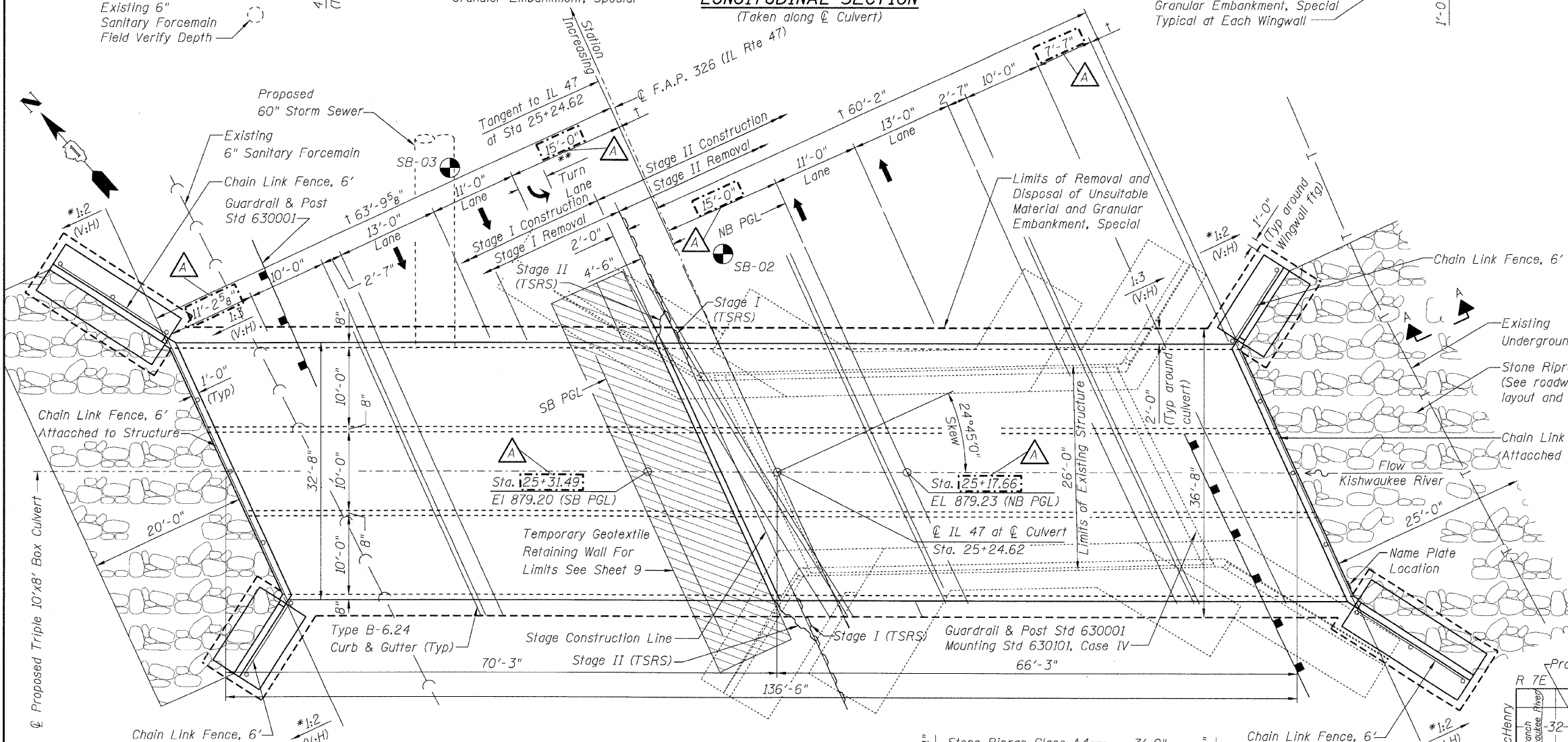
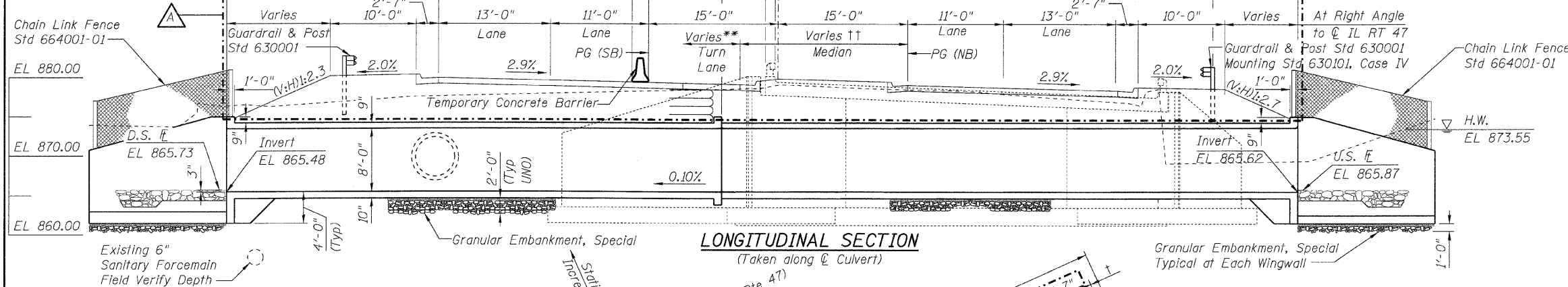

PLAN

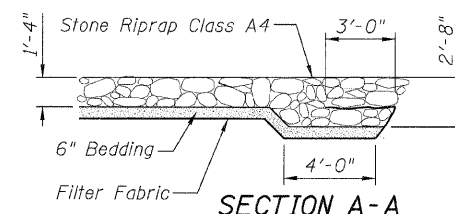

SECTION A-A

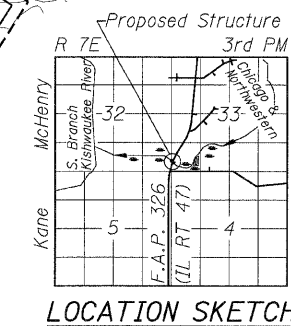

LOCATION SKETCH

DESIGNED -	NDR
CHECKED -	DSE
DRAWN -	RTT
CHECKED -	DSE
DATE -	Aug 5, 2009