

F.A.P. RTE.	SECTION	COUNTY	TOTAL SHEETS	SHEET NO.
326	*	McHENRY	502	17
STA. 9+35.22		TO STA.142+08.53		
FED. ROAD DIST. NO.		ILLINOIS FED. AID PROJECT		
* (105X & 106) WRS-2				

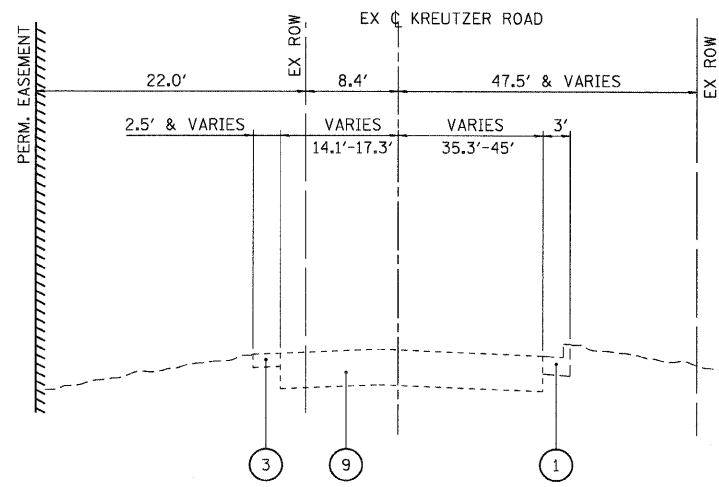

EXISTING KREUTZER ROAD
STA 330+42.14 TO STA 332+03.30

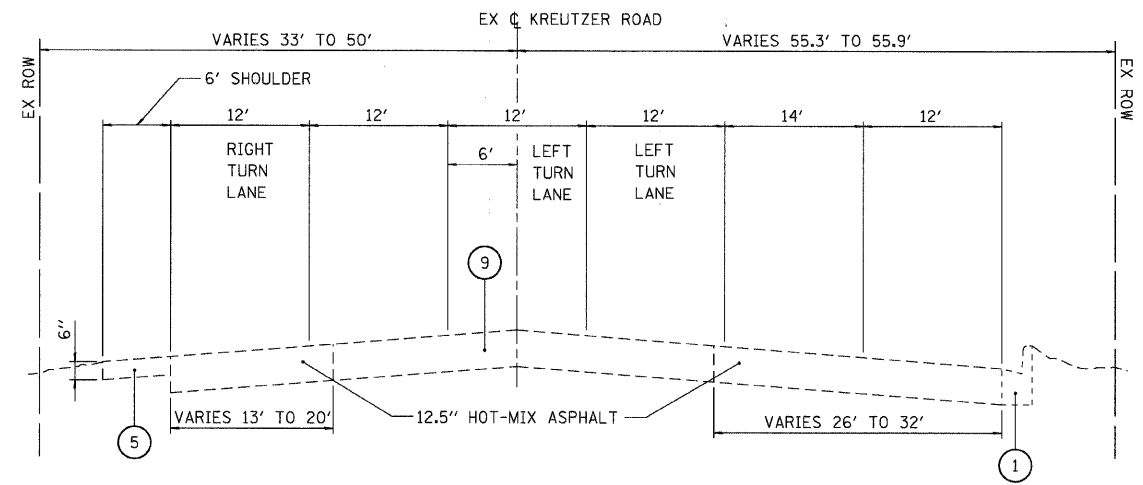

EXISTING KREUTZER ROAD
STA 199+94.60 TO STA 203+00.00

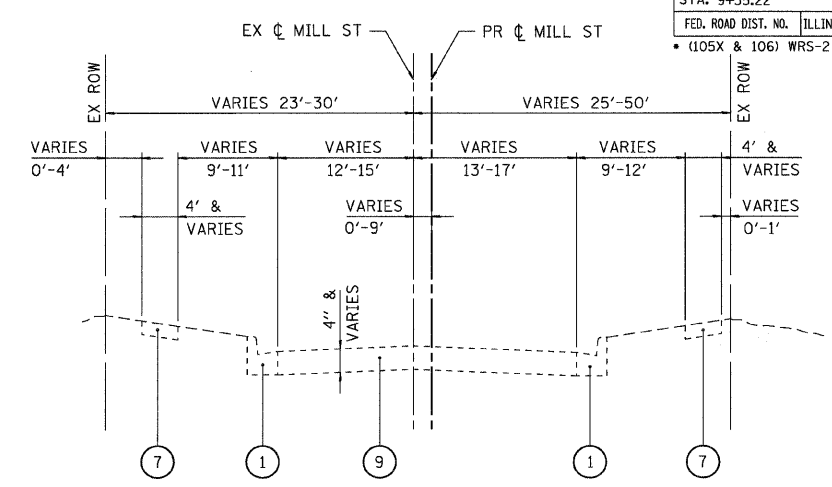

EXISTING MILL STREET
STA 394+11.69 TO STA 405+33.40

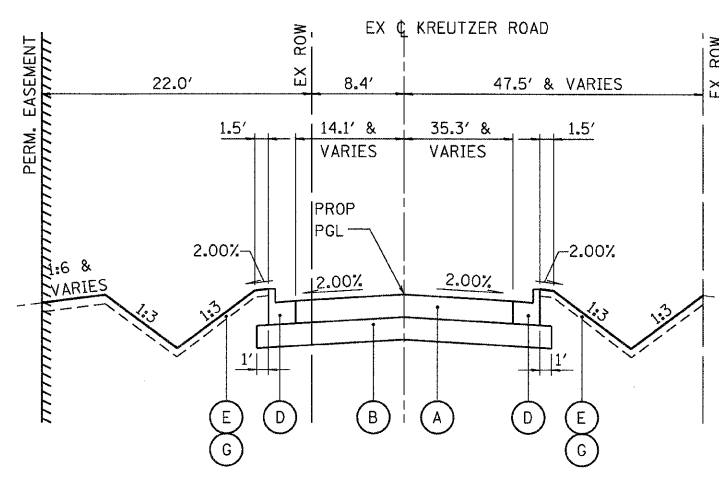

PROPOSED KREUTZER ROAD
STA 330+42.14 TO STA 332+03.30

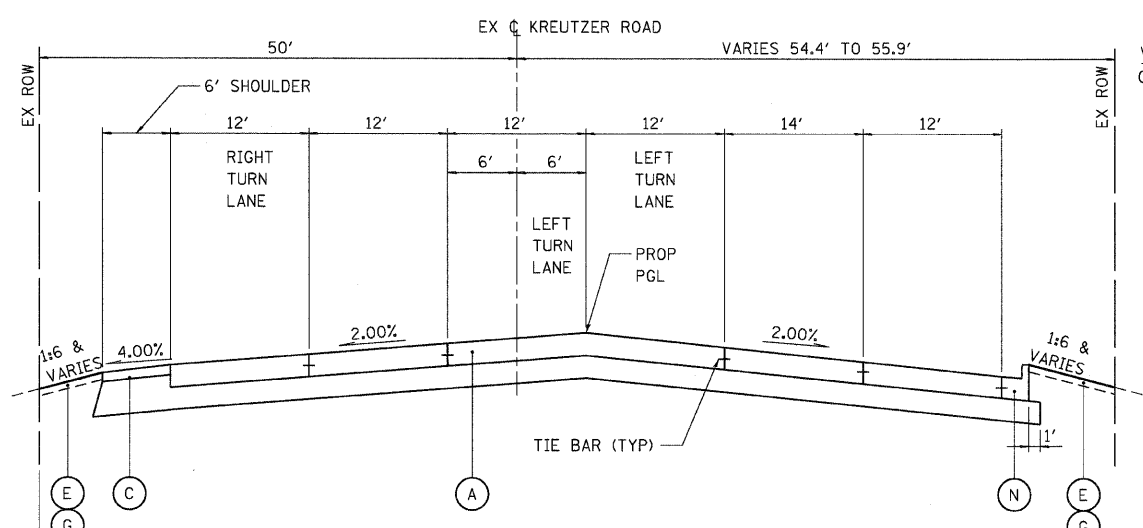

PROPOSED KREUTZER ROAD
STA 199+94.60 TO STA 203+00.00

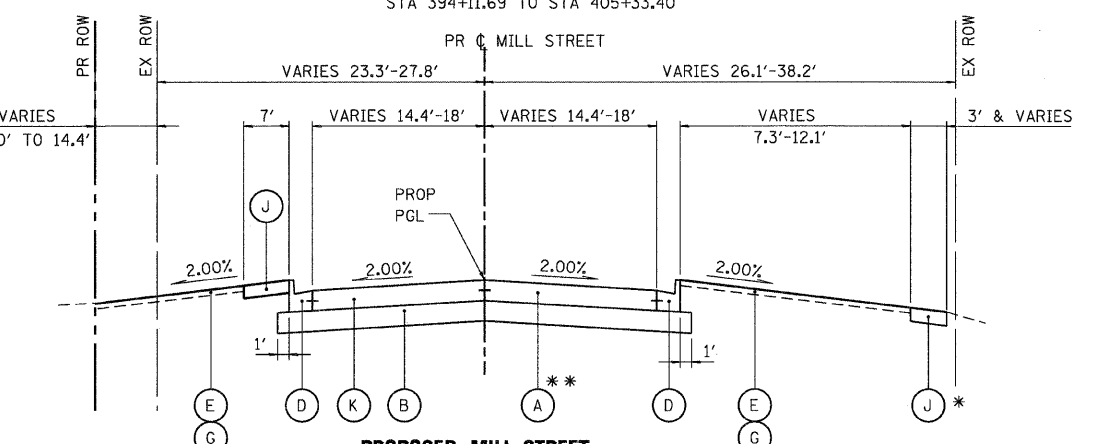

PROPOSED MILL STREET
STA 394+11.69 TO STA 401+66.30
STA 405+18.75 TO STA 405+33.40
** STA 398+66.82 TO STA 401+47.15
* SIDEWALK OMISSION:
STA 394+11.69 TO STA 399+31.23

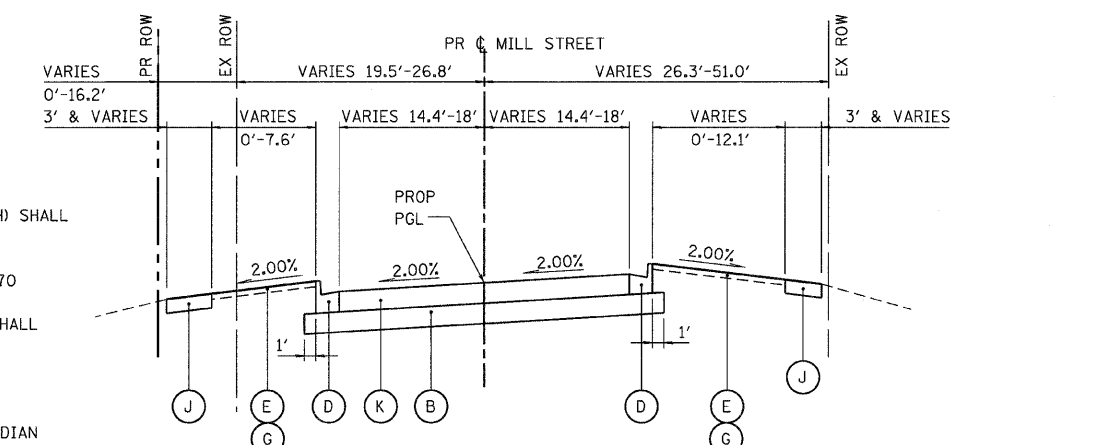

PROPOSED MILL STREET
STA 401+66.30 TO STA 405+18.75

EXISTING LEGEND

- 1 COMBINATION CURB AND GUTTER
- 2 COMPOSITE PAVEMENT BITUMINOUS OVERLAY, VARIES 3"-9", P.C.C. PAVEMENT, VARIES 7"-10"
- 3 AGGREGATE SHOULDER, VARIES 2"-15"
- 4 GRASS MEDIAN
- 5 BITUMINOUS SHOULDER, 4"-8"
- 6 P.C.C. PAVEMENT, 9.75"
- 7 P.C.C. SIDEWALK
- 8 P.C.C. MEDIAN
- 9 BITUMINOUS PAVEMENT, VARIES 7.5"-14.5"

PROPOSED LEGEND

- A 10" JOINTED P.C.C. PAVEMENT
- B AGGREGATE SUBGRADE, 12" (SEE NOTE 3)
- C HMA SHOULDER, 8"
- D COMBINATION CONCRETE CURB AND GUTTER, TYPE B-6.24
- E SODDING, SALT TOLERANT
- F HMA SHOULDER, 6"
- G TOPSOIL FURNISH AND PLACE, 4"
- H CONCRETE MEDIAN, TYPE SB-6.12
- I CONCRETE MEDIAN, TYPE SB-6 (SPECIAL)
- J P.C.C. SIDEWALK, 5"

- K HMA PAVEMENT (FULL DEPTH), 9 1/2" (SEE NOTE 1)
- L HMA PAVEMENT (FULL DEPTH), 12" (SEE NOTE 2)
- M ESCAPE AREA MEDIAN
- N COMBINATION CONCRETE CURB AND GUTTER, TYPE B-6.12
- O P.C.C. BASE COURSE, 8 1/4"
- P POLYMERIZED HMA SURFACE COURSE, MIX F, N90, 1 3/4"
- Q POLYMERIZED HMA BINDER COURSE, IL-19.0, N90, 2 1/4"
- R CONCRETE MEDIAN, TYPE SB-6.24
- S STEEL PLATE BEAM GUARDRAIL, TYPE A
- T RETAINING WALL
- U COMBINATION CONCRETE CURB AND GUTTER, TYPE B-6.24 (SPECIAL)
- V CONCRETE CURB, TYPE B

NOTES:

1. THE 9 1/2-INCH HMA PAVEMENT (FULL-DEPTH) SHALL CONSIST OF:
2-INCH HMA SURFACE COURSE, MIX "D", N70
7 1/2-INCH HMA BINDER COURSE, IL 19.0, N70
2. THE 12-INCH HMA PAVEMENT (FULL-DEPTH) SHALL CONSIST OF:
2-INCH HMA SURFACE COURSE, MIX "D", N70
10-INCH HMA BINDER COURSE, IL 19.0, N70
3. ADDITIONAL SUBGRADE THICKNESS BELOW MEDIAN AREA AND SHOULDER SHALL BE INCLUDED IN THE COST OF THE PAY ITEM FOR AGGREGATE SUBGRADE, 12" AND SHALL NOT BE PAID FOR SEPARATELY.
4. SEE TURN LANE MEDIAN DETAILS SHEET FOR TYPICAL LAYOUT AND DESIGN OF MEDIANS ADJACENT TO LEFT TURN LANES.

PLOT DATE = Friday, August 07, 2009
 FILE NAME = S:\11-CADD\01-mh\A171.dgn
 SCALE = 1/8" = 1'-0"
 USER NAME = JBS



REVISIONS	
NAME	DATE

ILLINOIS DEPARTMENT OF TRANSPORTATION
ILLINOIS ROUTE 47
EXISTING AND PROPOSED TYPICAL SECTIONS
SHEET 5 OF 9

SCALE: VERT. NO SCALE
 HORIZ. DATE: 8/5/2009

DRAWN BY: E.D.
 CHECKED BY: B.S.