

F.A.P. RTE.	SECTION	COUNTY	TOTAL SHEETS	SHEET NO.
326	105X106)WRS-2	McHENRY	502	27A
STA. 9+35.22		TO STA.142+08.53		
FED. ROAD DIST. NO.		ILLINOIS	FED. AID PROJECT	

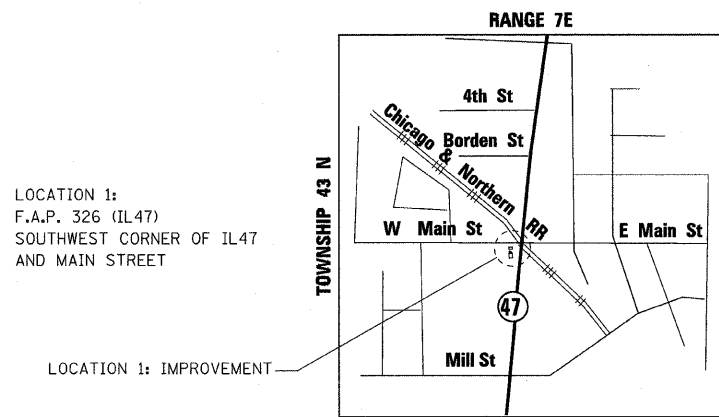

LOCATION 1:
F.A.P. 326 (IL47)
SOUTHWEST CORNER OF IL47
AND MAIN STREET

LOCATION 1: IMPROVEMENT



DESCRIPTION:
DEMOLITION OF TWO COMMERCIAL BUILDINGS;
ONE AUTO CENTER BUILDING, AND ONE GAS STATION CANOPY

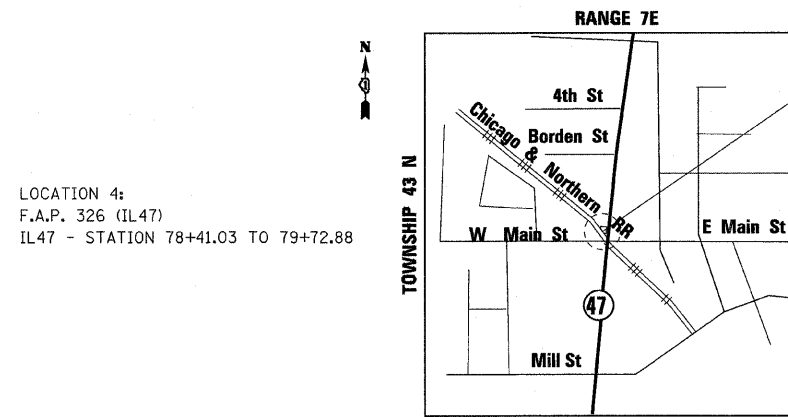

LOCATION 4:
F.A.P. 326 (IL47)
IL47 - STATION 78+41.03 TO 79+72.88

LOCATION 4: IMPROVEMENT

DESCRIPTION:
DEMOLITION OF TWO COMMERCIAL BUILDINGS

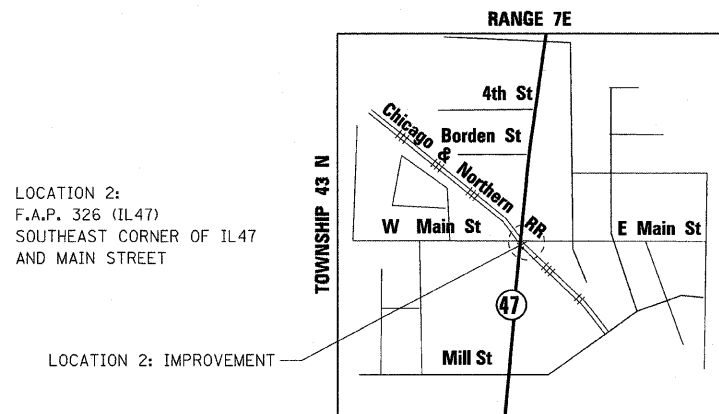

LOCATION 2:
F.A.P. 326 (IL47)
SOUTHEAST CORNER OF IL47
AND MAIN STREET

LOCATION 2: IMPROVEMENT



DESCRIPTION:
DEMOLITION OF ONE COMMERCIAL BUILDING

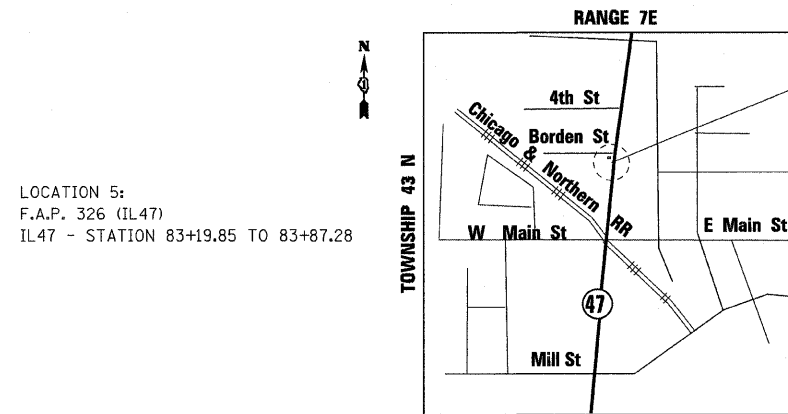

LOCATION 5:
F.A.P. 326 (IL47)
IL47 - STATION 83+19.85 TO 83+87.28

LOCATION 5: IMPROVEMENT

DESCRIPTION:
DEMOLITION OF ONE RESIDENTIAL BUILDING

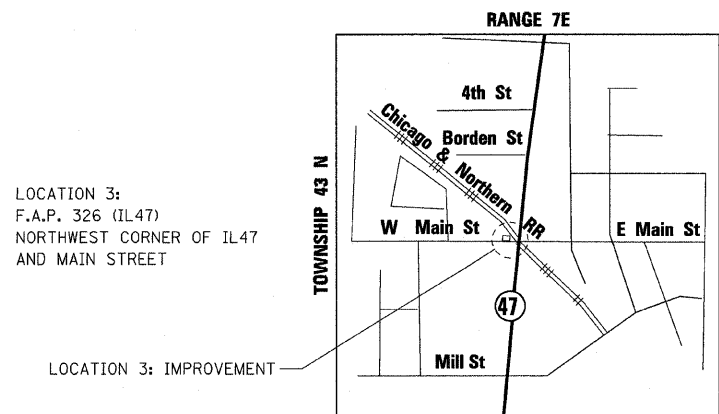

LOCATION 3:
F.A.P. 326 (IL47)
NORTHWEST CORNER OF IL47
AND MAIN STREET

LOCATION 3: IMPROVEMENT



DESCRIPTION:
DEMOLITION OF ONE COMMERCIAL BUILDING

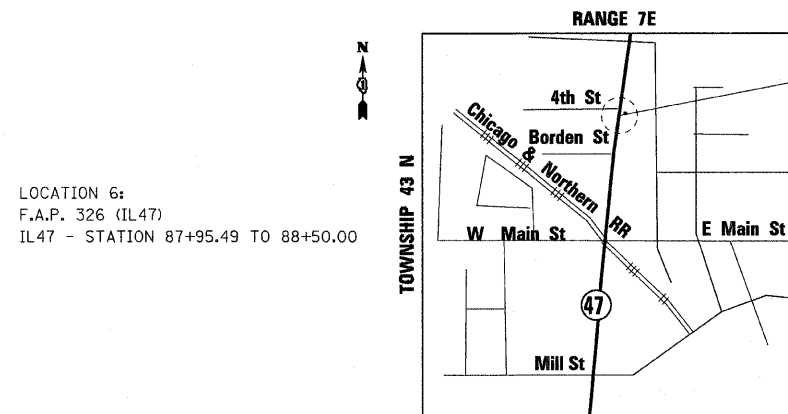

LOCATION 6:
F.A.P. 326 (IL47)
IL47 - STATION 87+95.49 TO 88+50.00

LOCATION 6: IMPROVEMENT

DESCRIPTION:
DEMOLITION OF ONE COMMERCIAL BUILDING



PLOT DATE = Tuesday, October 27, 2009
FILE NAME = S:\11-CADD\01-sh\11027A-demo_location.dgn
PLOT SCALE = 50%
USER NAME =



REVISIONS	
NAME	DATE

ILLINOIS DEPARTMENT OF TRANSPORTATION
ILLINOIS ROUTE 47
LOCATION DESCRIPTION DETAILS

SCALE: VERT. 1"=50'
HORIZ. DATE: 10/27/2009

DRAWN BY: E.D.
CHECKED BY: A.A.C.