

F.A.P. RTE.	SECTION	COUNTY	TOTAL SHEETS	SHEET NO.
326		McHENRY	502	60
STA. 9+35.22		TO STA. 142+08.53		
FED. ROAD DIST. NO.		ILLINOIS FED. AID PROJECT		
• (105X & 106) WRS-2				

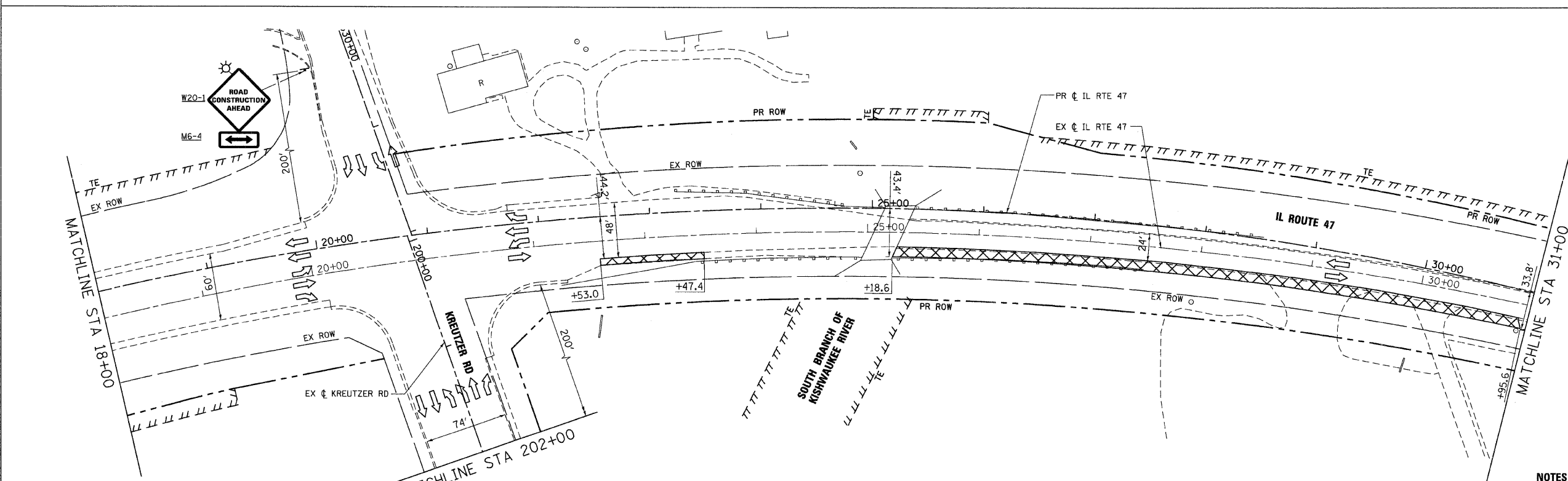
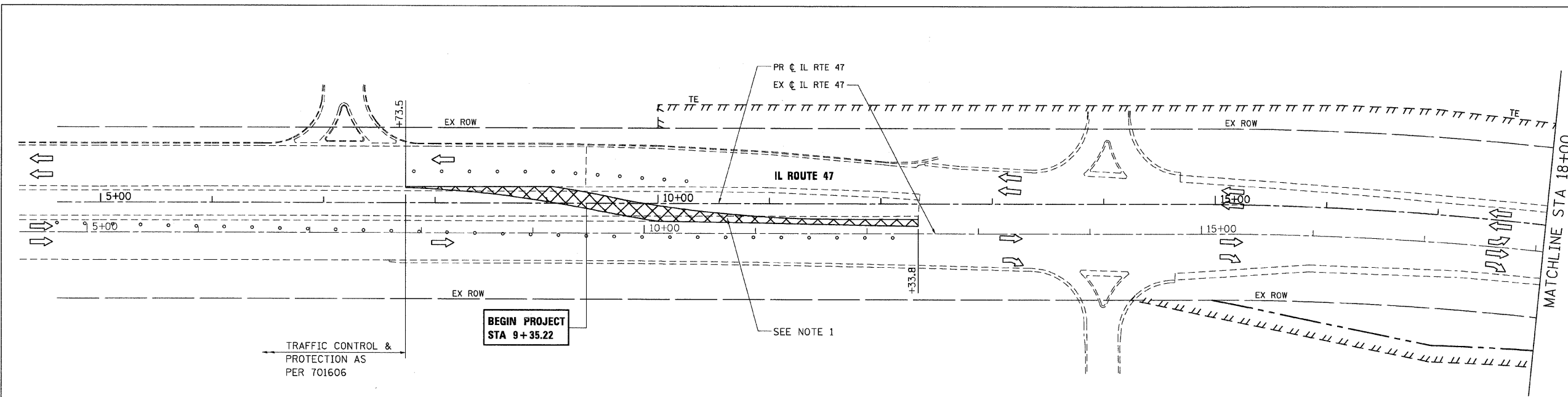

- NOTES:**
- SEE MOT STAGE 1 FOR TEMPORARY CROSSOVER GEOMETRY.
 - ALL EXISTING PAVEMENT MARKINGS SHALL REMAIN IN PLACE.
 - MAINTENANCE OF TRAFFIC IN AREAS OF TEMPORARY PAVEMENT WIDENING AT THE OUTSIDE EDGES OF PAVEMENT SHALL BE IN ACCORDANCE WITH IDOT STANDARD 701326.
 - ALL STATION/OFFSET AND DIMENSIONS FOR IL RTE 47 REFERENCE THE PROPOSED CENTERLINE.

REVISIONS	
NAME	DATE

ILLINOIS DEPARTMENT OF TRANSPORTATION
ILLINOIS ROUTE 47
MAINTENANCE OF TRAFFIC - PRE-STAGE
SHEET 1 OF 8

SCALE: VERT. 1"=50'
 HORIZ. 1"=50'
 DATE: 8/5/2009
 DRAWN BY: E.D.
 CHECKED BY: A.A.C.

Stanley Consultants INC.
 850 West Higgins Road, Suite 730, Chicago, Illinois 60631-2801
 www.stanleygroup.com
 Illinois State Registration No. BA-00533
 (773) 593-3524

PLOT DATE = Wednesday, August 05, 2009
 FILE NAME = S:\11-CADD\11-11-09\11066_mct_pre.sh100.dgn
 PLOT SCALE = 1/8"=1'
 USER NAME = 3630