

F.A.P. RTE.	SECTION	COUNTY	TOTAL SHEETS	SHEET NO.
326		McHENRY	502	64
STA. 9+35.22		TO STA. 142+08.53		
FED. ROAD DIST. NO.		ILLINOIS	FED. AID PROJECT	
• (105X & 106) WRS-2				

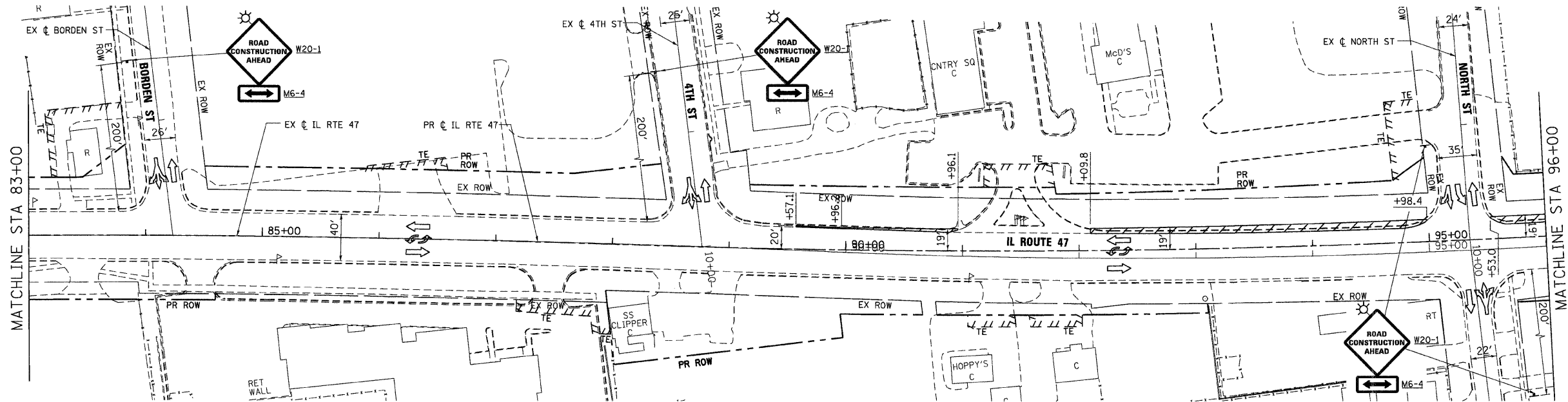

- NOTES:**
1. ALL EXISTING PAVEMENT MARKINGS SHALL REMAIN IN PLACE.
  2. MAINTENANCE OF TRAFFIC IN AREAS OF TEMPORARY PAVEMENT WIDENING SHALL BE IN ACCORDANCE WITH IDOT STANDARD 701502.
  3. ALL STATION/OFFSET AND DIMENSIONS FOR IL RTE 47 REFERENCE THE PROPOSED CENTERLINE.

SEE MOT - PRE-STAGE SHEET 6 OF 8  
FOR CONTINUATION  
MATCHLINE STA 98+00

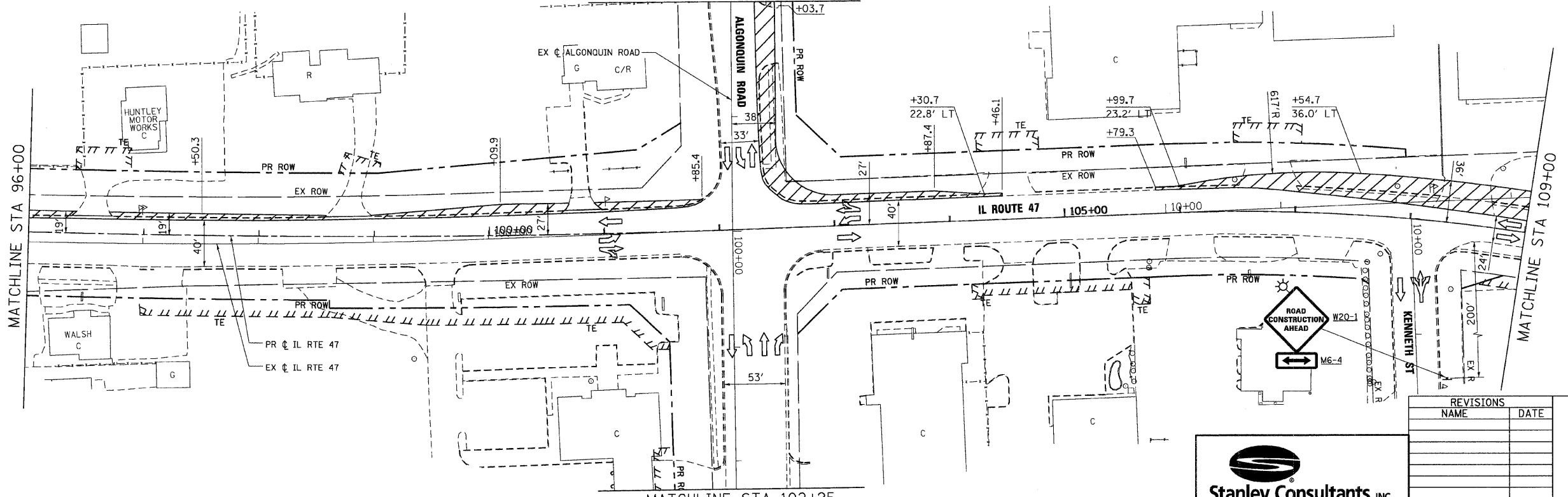
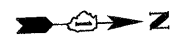

MATCHLINE STA 102+25  
SEE MOT - PRE-STAGE SHEET 6 OF 8  
FOR CONTINUATION

850 West Higgins Road, Suite 730, Chicago, Illinois 60631-2801  
www.stanleygrp.com  
Illinois Firm Registration No. 04-00633  
(773) 697-2524

REVISIONS	
NAME	DATE

ILLINOIS DEPARTMENT OF TRANSPORTATION  
**ILLINOIS ROUTE 47**  
MAINTENANCE OF TRAFFIC - PRE-STAGE  
SHEET 5 OF 8

SCALE: VERT. 1"=50'  
HORIZ. DATE: 8/5/2009  
DRAWN BY: E.D.  
CHECKED BY: A.A.C.

PLOT DATE = Wednesday, August 05, 2009  
FILE NAME = S:\11-CADD\11-ent\1064\_mot\_pre-sta105.dgn  
PLOT SCALE = 5/8"=1'  
USER NAME = 3636