

F.A.P. RTE.	SECTION	COUNTY	TOTAL SHEETS	SHEET NO.
326		McHENRY	502	67
STA. 9+35.22		TO STA. 142+08.53		
FED. ROAD DIST. NO.		ILLINOIS	FED. AID PROJECT	
• (105X & 106) WRS-2				

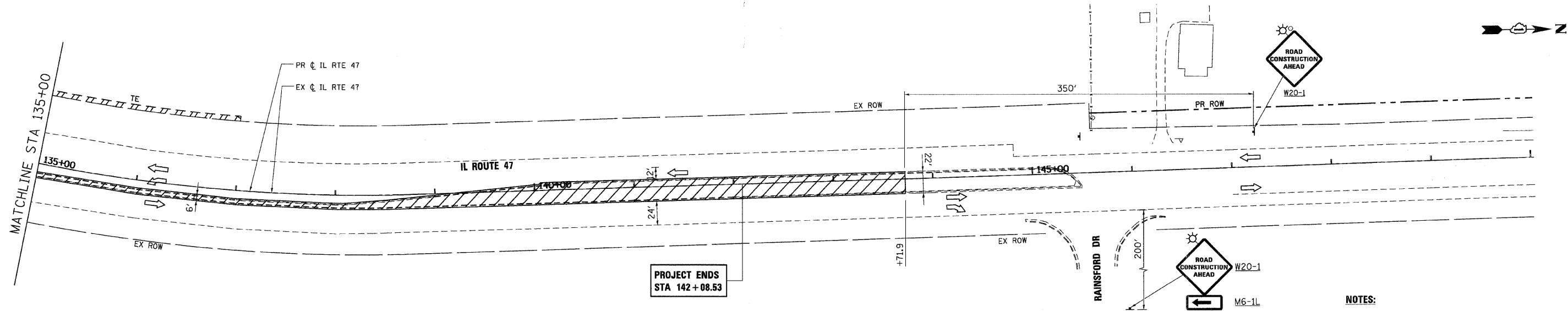

- NOTES:**
1. ALL EXISTING PAVEMENT MARKINGS SHALL REMAIN IN PLACE.
  2. MAINTENANCE OF TRAFFIC IN AREAS OF TEMPORARY PAVEMENT WIDENING SHALL BE IN ACCORDANCE WITH IDOT STANDARDS 701502 AND 701701.
  3. ALL STATION/OFFSET AND DIMENSIONS FOR IL RTE 47 REFERENCE THE PROPOSED CENTERLINE.

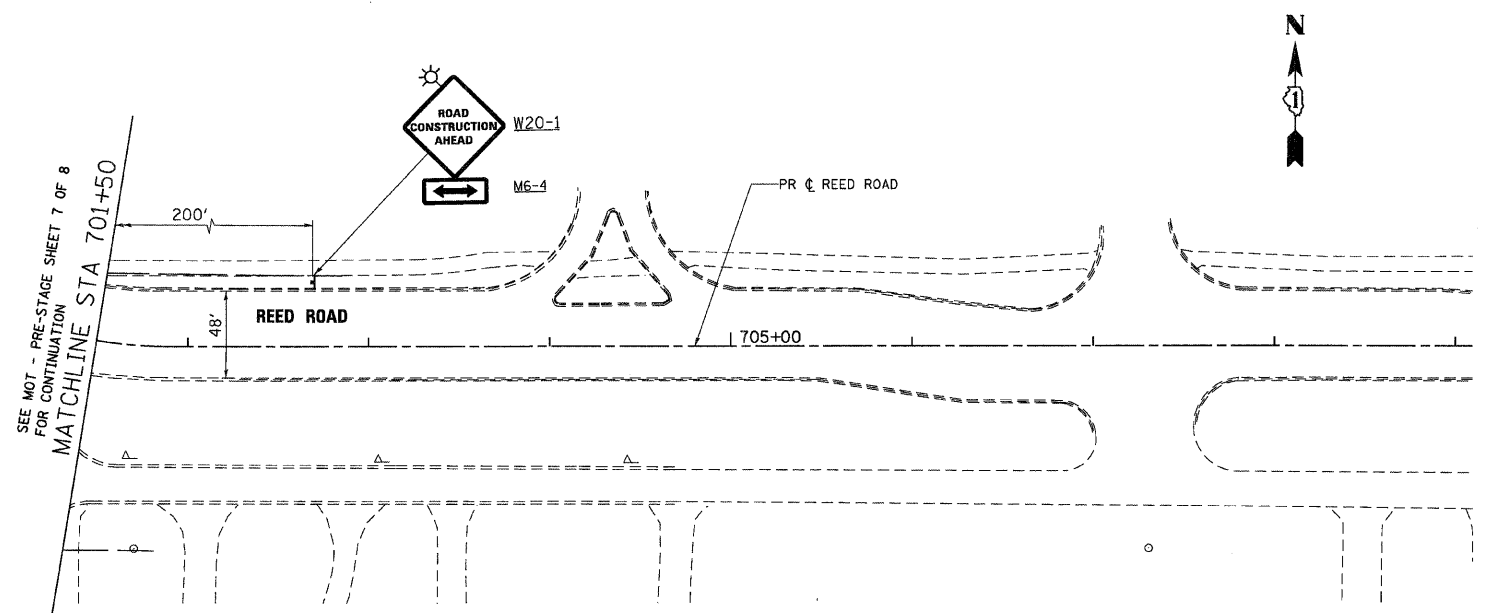
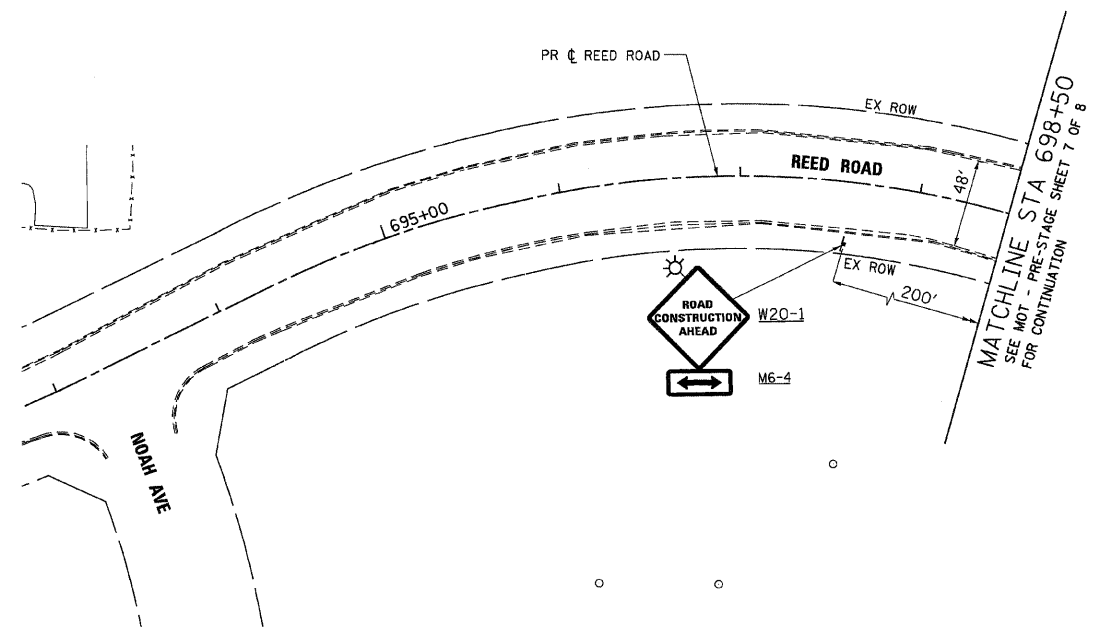

PLOT DATE = Wednesday, August 05, 2009  
 FILE NAME = S:\11-CADD\11-11-08\11-11-08\11-11-08.dgn  
 PLOT SCALE = 1/8"=1'-0"  
 USER NAME = jrb



REVISIONS	
NAME	DATE

ILLINOIS DEPARTMENT OF TRANSPORTATION  
**ILLINOIS ROUTE 47**  
**MAINTENANCE OF TRAFFIC - PRE-STAGE**  
**SHEET 8 OF 8**

SCALE: VERT. 1"=50'  
 HORIZ. 1"=100'  
 DATE: 8/5/2009  
 DRAWN BY: E.D.  
 CHECKED BY: A.A.C.