

F.A.P. RTE.	SECTION	COUNTY	TOTAL SHEETS	SHEET NO.
326		McHENRY	502	76
STA. 9+35.22		TO STA. 142+08.53		
FED. ROAD DIST. NO.		ILLINOIS FED. AID PROJECT		
(105X & 106) WRS-2				

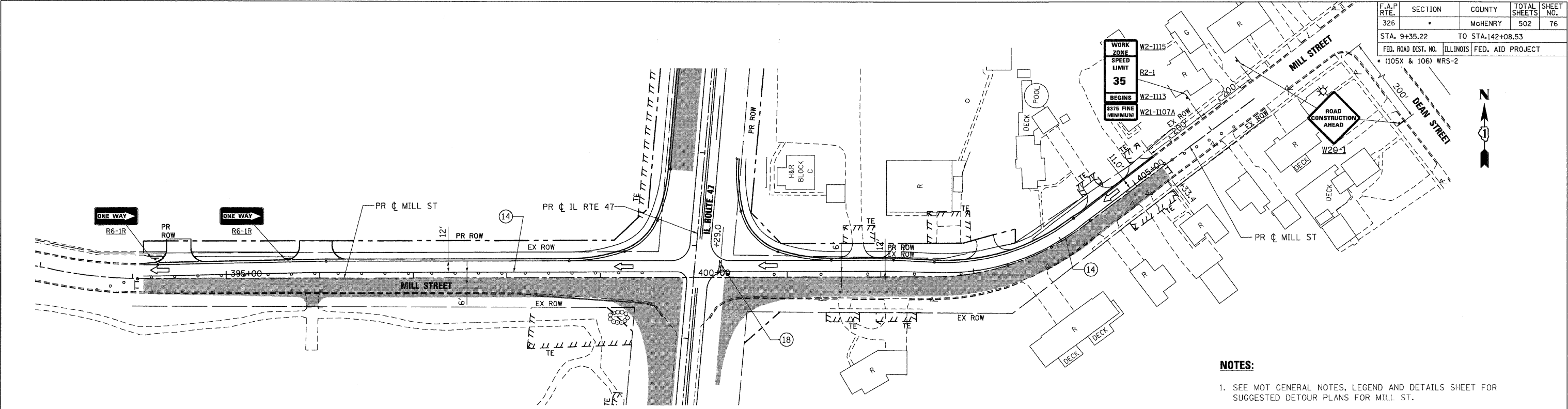

MILL STREET

- NOTES:**
1. SEE MOT GENERAL NOTES, LEGEND AND DETAILS SHEET FOR SUGGESTED DETOUR PLANS FOR MILL ST.
 2. TEMPORARY PAVEMENT MARKINGS FROM STAGE 1 ALONG IL RTE 47 SHALL REMAIN IN PLACE. SEE MOT - STAGE 1 SHEET 3 OF 7 FOR ADDITIONAL INFORMATION.
 3. SEE TEMPORARY RAILROAD CROSSING GATE DETAIL ON MOT DETAIL SHEET FOR ADDITIONAL INFORMATION.

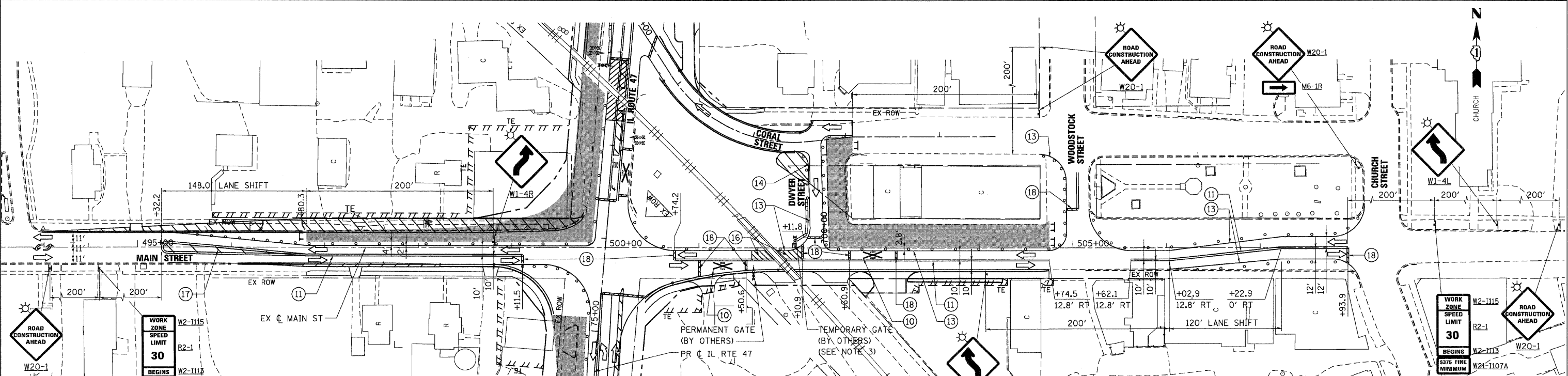

MAIN STREET

REVISIONS	
NAME	DATE

ILLINOIS DEPARTMENT OF TRANSPORTATION
MILL STREET & MAIN STREET
 MAINTENANCE OF TRAFFIC - STAGE 1B
 SHEET 1 OF 4

850 West Higgins Road, Suite 730, Chicago, Illinois 60631-2001
 www.stanleygroup.com
 Illinois State Registration No. 04-00533
 (773) 631-3024

SCALE: VERT. 1"=50'
 HORIZ. 1"=100'
 DATE: 8/5/2009
 DRAWN BY: E.D.
 CHECKED BY: A.A.C.

PLOT DATE = Wednesday, August 05, 2009
 FILE NAME = S:\11-CADD\11-11-09\11-11-09-11-11-09-11-11-09.dwg
 PLOT SCALE = 1/8"=1'-0"
 USER NAME = 3839