

F.A.P. RTE.	SECTION	COUNTY	TOTAL SHEETS	SHEET NO.
326		McHENRY	502	79
STA. 9+35.22		TO STA. 142+08.53		
FED. ROAD DIST. NO.		ILLINOIS FED. AID PROJECT		
* (105X & 106) WRS-2				

SEE MOT STAGE 1B SHEET 3 OF 4 FOR CONTINUATION

MATCHLINE STA 97+00

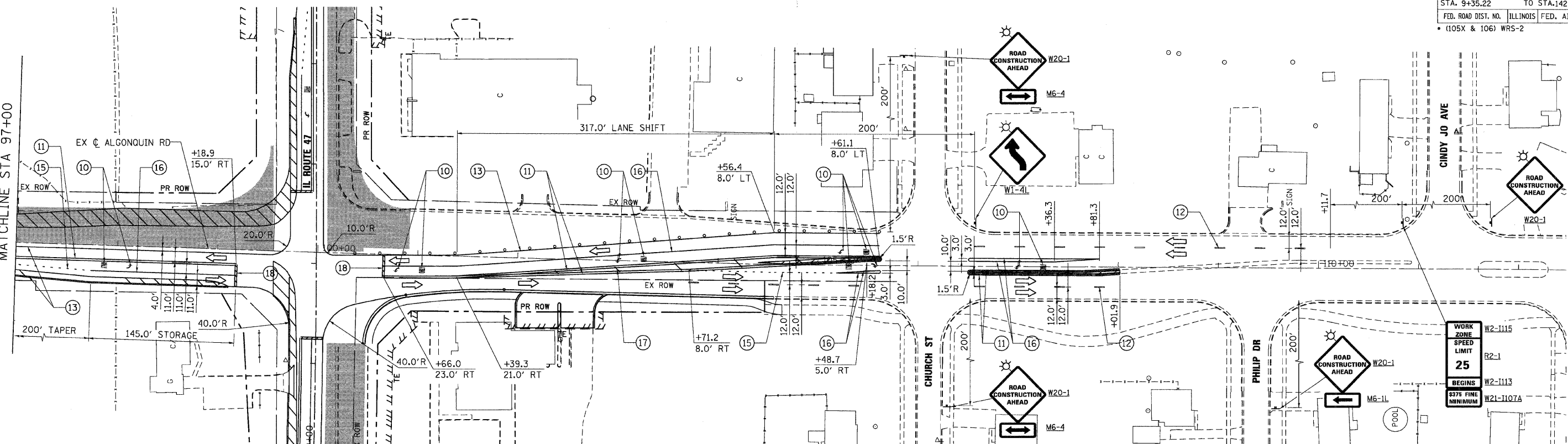

**ALGONQUIN ROAD**

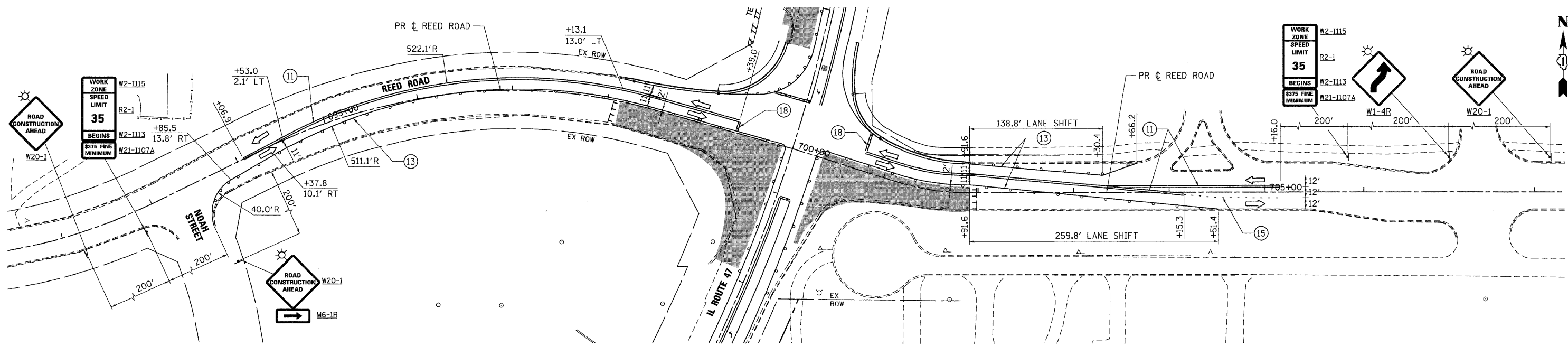

**REED ROAD**

**NOTES:**

1. TEMPORARY PAVEMENT MARKINGS FROM STAGE 1 ALONG IL RTE 47 SHALL REMAIN IN PLACE. SEE MOT - STAGE 1 SHEET 5 OF 8 AND SHEET 7 OF 8 FOR ADDITIONAL INFORMATION.

**Stanley Consultants INC.**  
 850 West Higgins Road, Suite 730, Chicago, Illinois 60631-2801  
 www.stanleygroup.com  
 Illinois State Registration No. 04-00633  
 (773) 631-3624

REVISIONS	
NAME	DATE

ILLINOIS DEPARTMENT OF TRANSPORTATION  
**ALGONQUIN ROAD AND REED ROAD**  
 MAINTENANCE OF TRAFFIC - STAGE 1B  
 SHEET 4 OF 4

SCALE: VERT. 1"=50'  
 HORIZ. 1"=50'  
 DATE: 8/5/2009  
 DRAWN BY: E.D.  
 CHECKED BY: A.A.C.

PLOT DATE = Wednesday, August 05, 2009  
 FILE NAME = S:\11-CA00\B11\mht\1079\_mot\_s1b\_04.dgn  
 PLOT SCALE = 5/8"=1'  
 USER NAME = 3859