

F.A.P. RTE.	SECTION	COUNTY	TOTAL SHEETS	SHEET NO.
326		McHENRY	502	86
STA. 9+35.22		TO STA.142+08.53		
FED. ROAD DIST. NO.		ILLINOIS FED. AID PROJECT		
• (105X & 106) WRS-2				

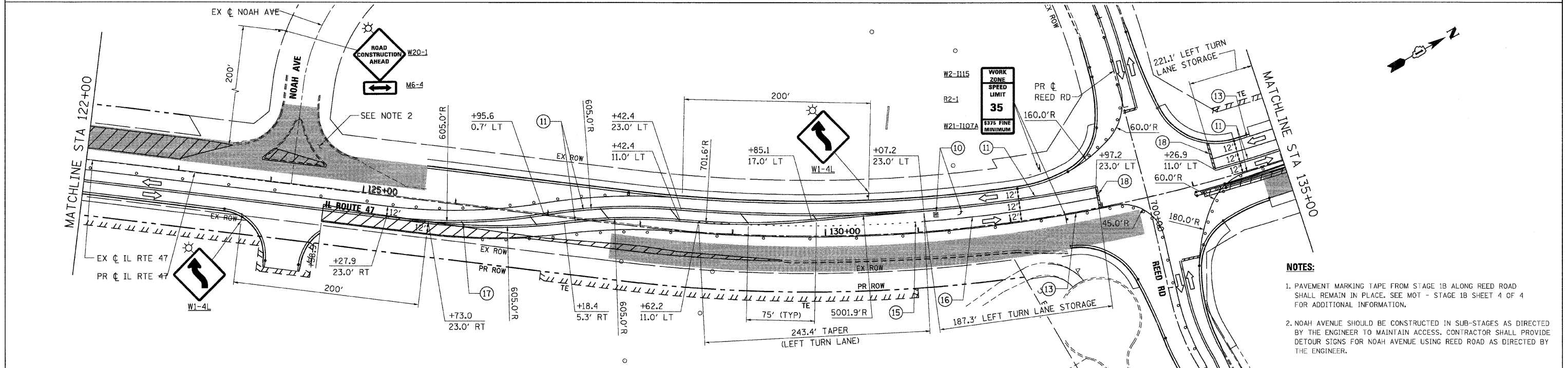
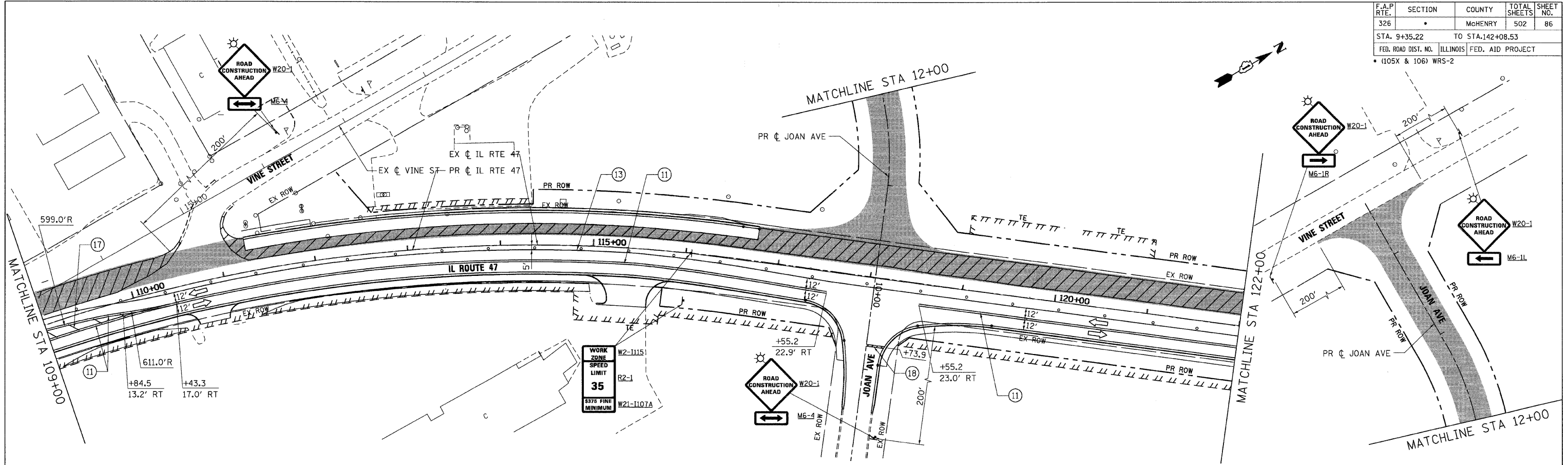

- NOTES:**
- PAVEMENT MARKING TAPE FROM STAGE 1B ALONG REED ROAD SHALL REMAIN IN PLACE. SEE MOT - STAGE 1B SHEET 4 OF 4 FOR ADDITIONAL INFORMATION.
 - NOAH AVENUE SHOULD BE CONSTRUCTED IN SUB-STAGES AS DIRECTED BY THE ENGINEER TO MAINTAIN ACCESS. CONTRACTOR SHALL PROVIDE DETOUR SIGNS FOR NOAH AVENUE USING REED ROAD AS DIRECTED BY THE ENGINEER.

REVISIONS	
NAME	DATE

Stanley Consultants INC.
 850 West Higgins Road, Suite 730, Chicago, Illinois 60631-2801
 www.stanleygroup.com
 Illinois Firm Registration No. 04-00533
 (773) 693-3524

ILLINOIS DEPARTMENT OF TRANSPORTATION
ILLINOIS ROUTE 47
 MAINTENANCE OF TRAFFIC - STAGE 2
 SHEET 6 OF 7

SCALE: VERT. 1"=50'
 HORIZ. DATE: 8/5/2009
 DRAWN BY: E.D.
 CHECKED BY: A.A.C.

PLOT DATE = Wednesday, August 05, 2009
 FILE NAME = S:\11-CADD\11-mt\086_mct.txd_ah\086.dgn
 PLOT SCALE = 50:1
 USER NAME = 3890