

F.A.P. RTE.	SECTION	COUNTY	TOTAL SHEETS	SHEET NO.
326		McHENRY	502	96
STA. 9+35.22		TO STA. 142+08.53		
FED. ROAD DIST. NO.		ILLINOIS FED. AID PROJECT		
• (105X & 106) WRS-2				

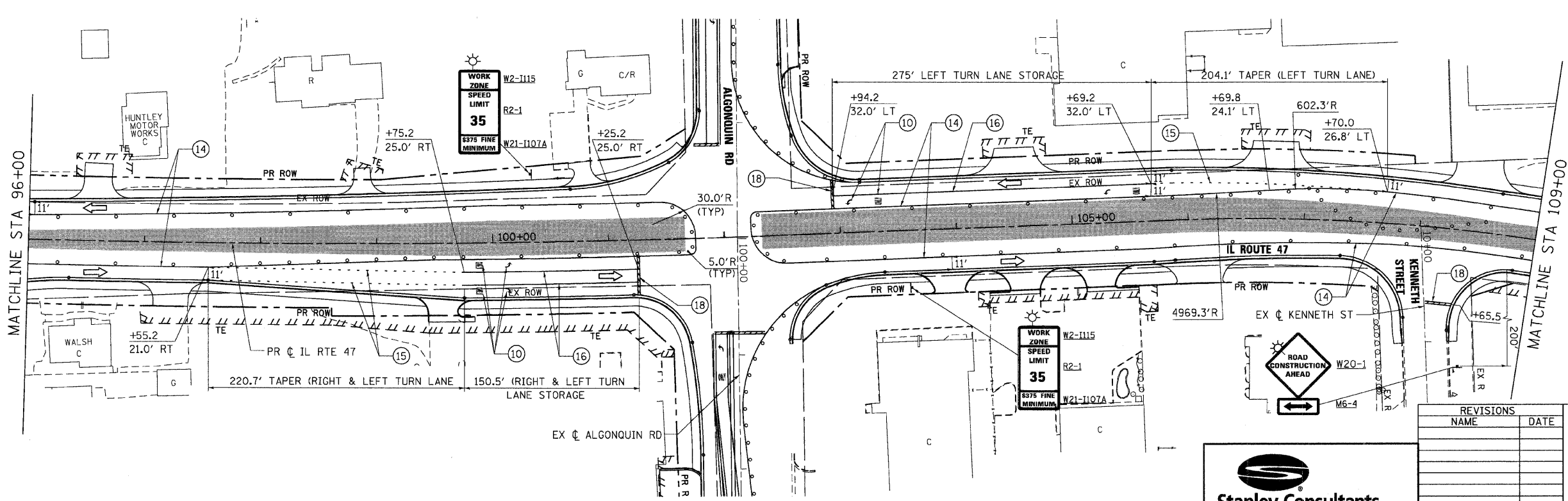
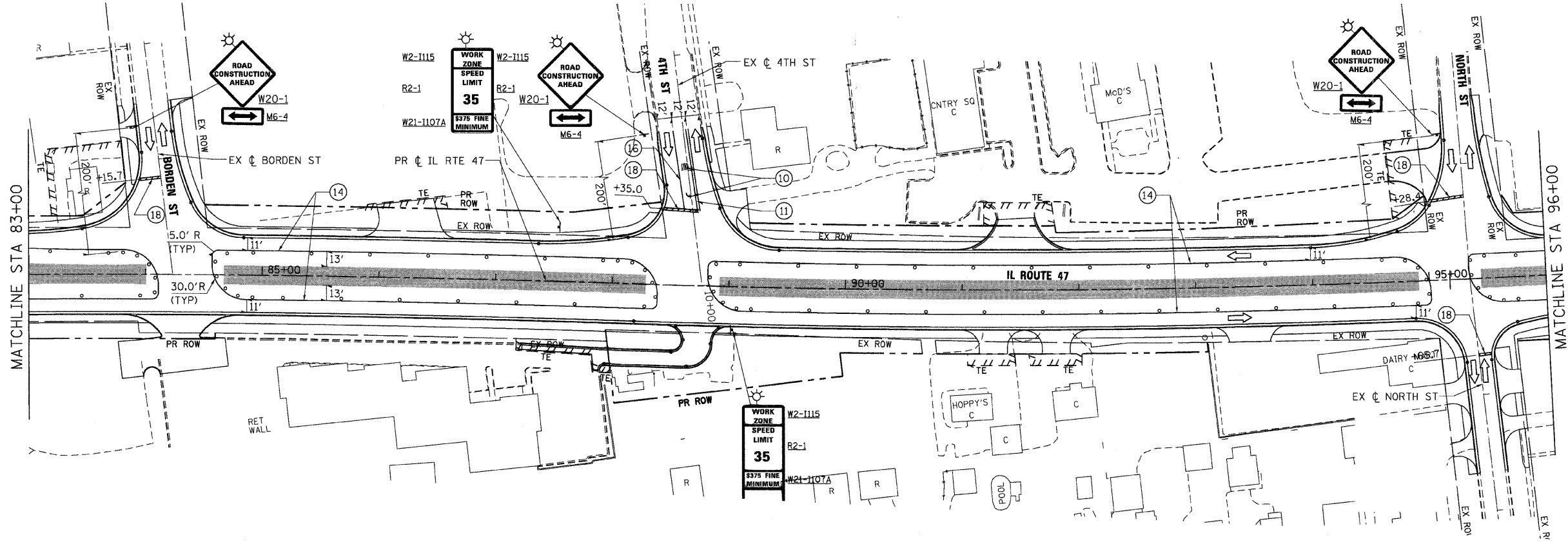

**NOTES:**  
 1. MAINTENANCE OF TRAFFIC ALONG ALGONQUIN ROAD SHALL BE THE SAME AS STAGE 1B. SEE MOT - STAGE 1B SHEET 2 OF 2 FOR LIMITS OF PAVEMENT MARKING TAPE, CONSTRUCTION SIGNING AND ADDITIONAL INFORMATION.

REVISIONS	
NAME	DATE

850 West Higgins Road, Suite 730, Chicago, Illinois 60631-2801  
 www.stanleygroup.com  
 Illinois Firm Registration No. 04-006533  
 (773) 697-3624

ILLINOIS DEPARTMENT OF TRANSPORTATION  
**ILLINOIS ROUTE 47**  
 MAINTENANCE OF TRAFFIC - STAGE 3  
 SHEET 4 OF 6

SCALE: VERT. 1"=50'  
 HORIZ. 1"=100'  
 DATE: 8/5/2009  
 DRAWN BY: E.D.  
 CHECKED BY: A.A.C.

PLOT DATE = Wednesday, August 05, 2009  
 FILE NAME = S:\11-CADD\11-mt\11876.mot\11876.mot.ctb3\_ah184.dgn  
 PLOT SCALE = 1/8"=1'-0"  
 USER NAME = 3536