

F.A.P. RTE.	SECTION	COUNTY	TOTAL SHEETS	SHEET NO.
326		McHENRY	502	101
STA. 9+35.22		TO STA. 142+08.53		
FED. ROAD DIST. NO.		ILLINOIS FED. AID PROJECT		
* (105X & 106) WRS-2				

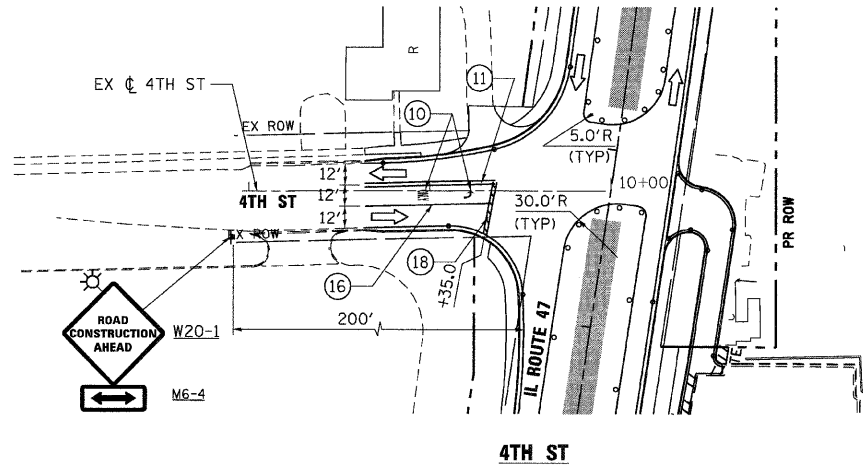

4TH ST

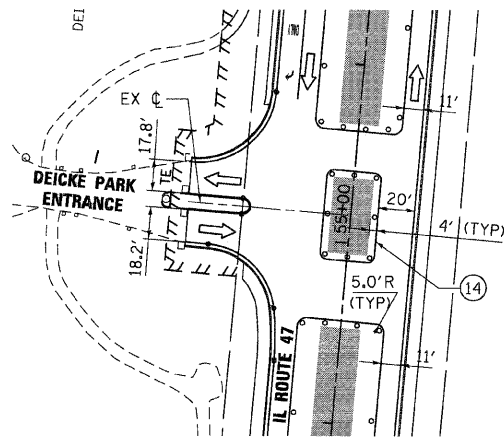

DIECKE PARK ENTRANCE

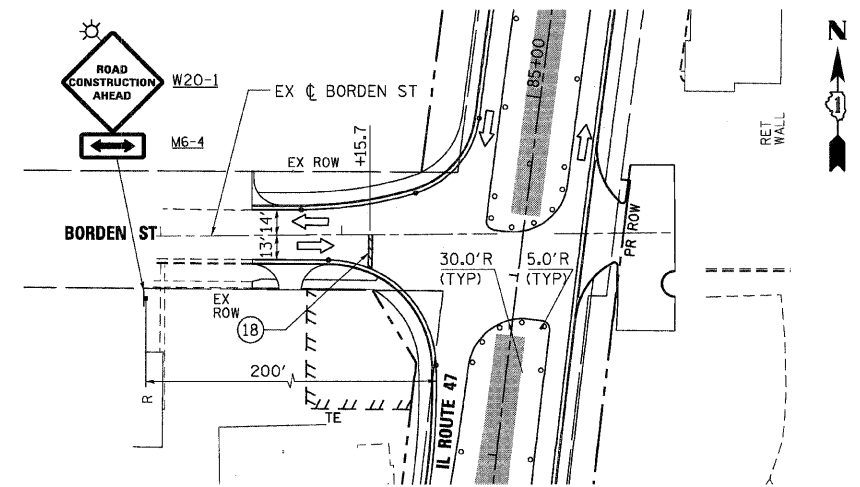

BORDEN STREET

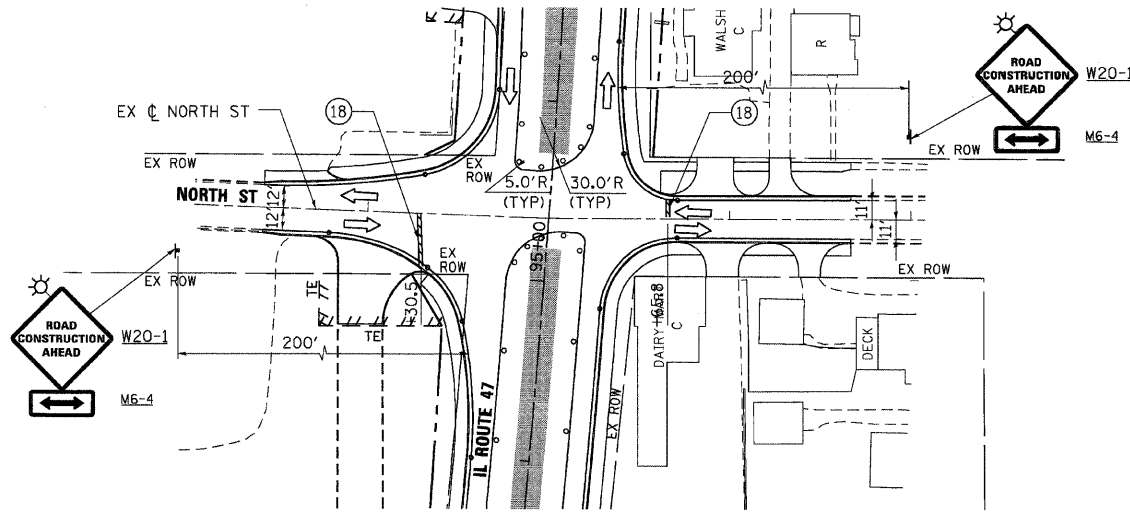

NORTH ST

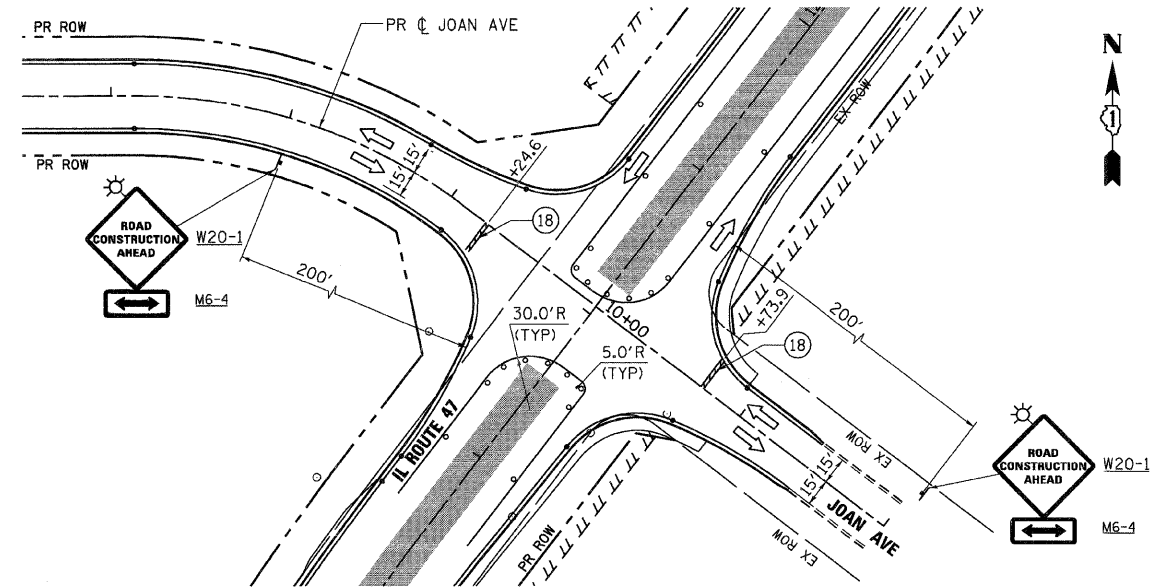

JOAN AVENUE

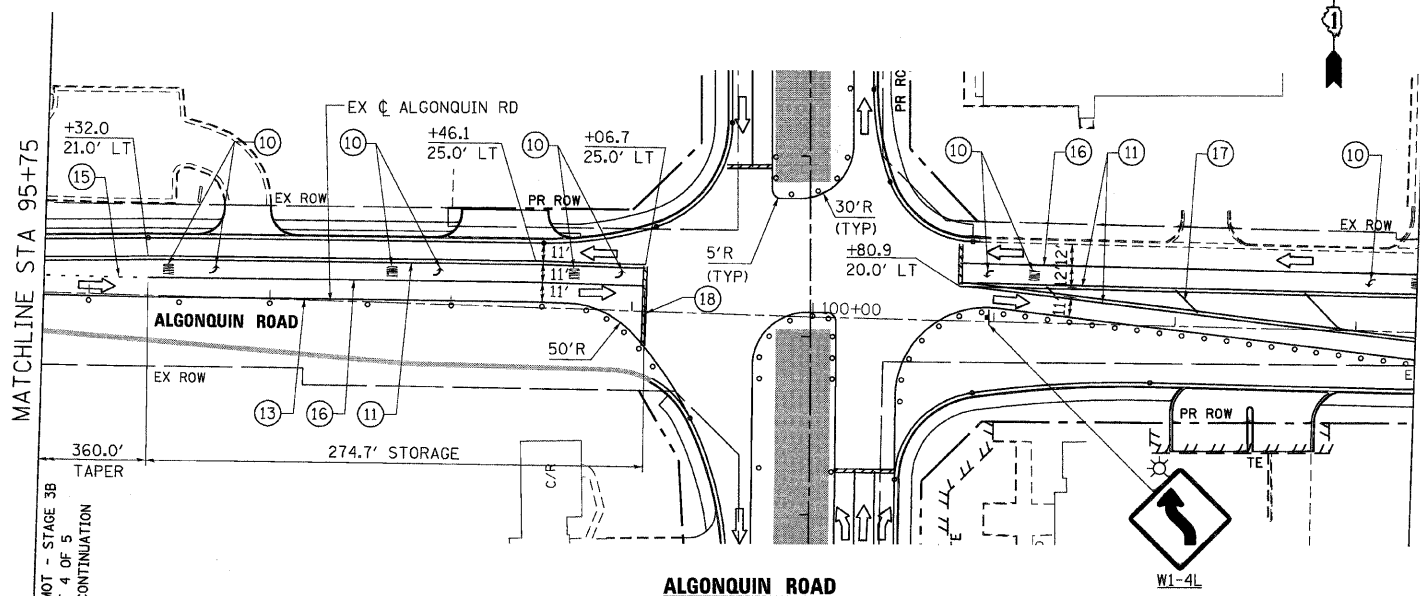

ALGONQUIN ROAD

MATCHLINE STA 103+30

SEE MOT - STAGE 3B  
SHEET 4 OF 5  
FOR CONTINUATION

NOTES:

- PAVEMENT MARKING TAPE FROM STAGE 3 ALONG IL RTE 47 SHALL REMAIN IN PLACE. SEE MOT - STAGE 3 SHEETS 1 THROUGH 5 FOR ADDITIONAL INFORMATION.



REVISIONS	
NAME	DATE

ILLINOIS DEPARTMENT OF TRANSPORTATION  
**ILLINOIS ROUTE 47**  
**MAINTENANCE OF TRAFFIC - STAGE 3B**  
**SHEET 3 OF 5**

SCALE: VERT. 1"=50'  
HORIZ. DATE: 8/5/2009  
DRAWN BY: E.D.  
CHECKED BY: A.A.C.

PLOT DATE = Wednesday, August 05, 2009  
FILE NAME = S:\11-CADD\11-1011\11-1011.mxd  
PLOT SCALE = 1/8"=1'-0"  
USER NAME = 3838

SEE MOT - STAGE 3B  
SHEET 4 OF 5  
FOR CONTINUATION