

F.A.P. RTE.	SECTION	COUNTY	TOTAL SHEETS	SHEET NO.
326		McHENRY	502	204
STA. 9+35.22		TO STA. 142+08.53		
FED. ROAD DIST. NO. ILLINOIS FED. AID PROJECT				
* (105X & 106) WRS-2				

- NOTES:**
- REFER TO DRAINAGE AND UTILITIES PLAN SHEETS FOR ADDITIONAL INFORMATION.
 - REFER TO LIFT STATION PLAN SHEETS 19 OF 24 THROUGH 22 OF 24 FOR ADDITIONAL INFORMATION.
 - CONTRACTOR SHALL PROVIDE STRUCTURAL SOIL RETENTION SYSTEMS, SUCH AS SHORING, BRACING OR UNDERPINNING DESIGNED BY AN ILLINOIS LICENSED STRUCTURAL ENGINEER FOR PIPING, SEWER AND LIFT STATION CONSTRUCTION TO PROTECT ADJACENT STRUCTURES OR FEATURES. THIS WORK WILL NOT BE MEASURED OR PAID FOR SEPARATELY BUT SHALL BE INCLUDED IN THE CONTRACT UNIT COST FOR SANITARY SEWER LIFT STATION OR SANITARY SEWER LIFT STATION ABANDONMENT.
 - CONTRACTOR SHALL COORDINATE OBTAINING POWER CONNECTIONS FOR LIFT STATIONS WITH COMMONWEALTH EDISON.

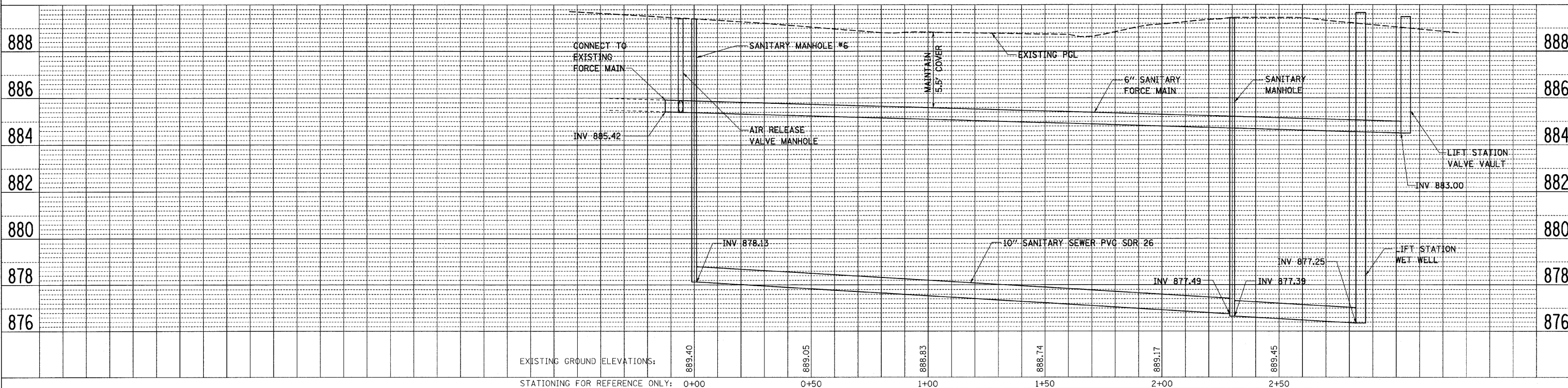
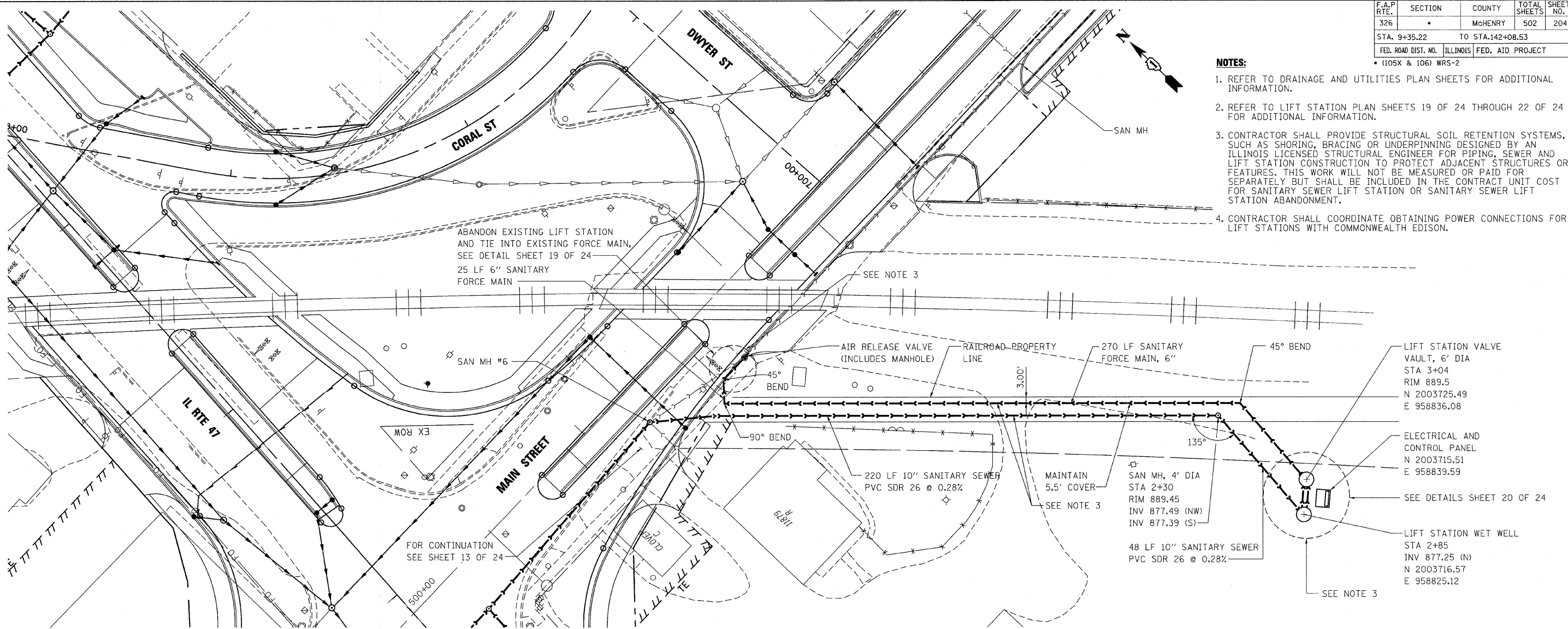

EXISTING GROUND ELEVATIONS:

889.40	889.05	888.83	888.74	889.17	889.45
--------	--------	--------	--------	--------	--------

10/27/2009

PLAN SURVEYED BY DATE
 NOTE BOOK NO. CHECKED BY
 ALIGNED BY DATE
 FILED BY DATE

PROFILE SURVEYED BY DATE
 NOTE BOOK NO. CHECKED BY
 GRADES BY DATE
 STRUCTURES BY DATE

PLOT DATE = Wednesday, October 14, 2009
 FILE NAME = S:\11-CADD\11\m\1284_wm_11*.sta.plandgn
 PLOT SCALE = 1/8"=1'-0"
 USER NAME = 3679