

PART OF THE SW. 1/4 OF THE NW. 1/4 OF SEC. 33, TWP. 43 N., R. 7 E. OF THE 3rd P.M. IN McHENRY COUNTY, ILLINOIS.

CONTRACT NO. 62882

F.A.P. RTE.	SECTION	COUNTY	TOTAL SHEETS	SHEET NO.
326		McHENRY	502	219
STA. 9+35.22		TO STA. 142+08.53		
FED. ROAD DIST. NO.		ILLINOIS FED. AID PROJECT		

LEGEND

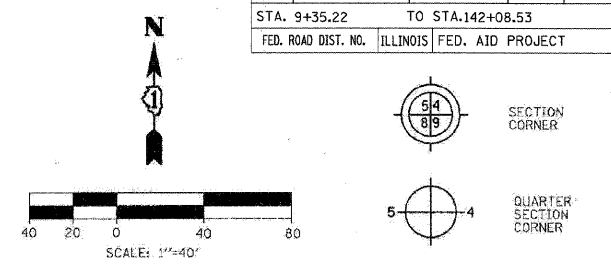

Bearings are referenced to the Illinois State Plane Coordinates Ground System, NAD83, East Zone, as provided by the Illinois Department of Transportation.

---	SECTION LINE
---	QUARTER SECTION LINE
---	QUARTER, QUARTER SECTION LINE
---	PLATTED LOT LINE
---	PROPERTY (DEED) LINE
---	APPARENT PROPERTY LINE
---	EXISTING CENTERLINE
---	EXISTING RIGHT OF WAY LINE
---	PROPOSED CENTERLINE
---	PROPOSED RIGHT OF WAY LINE
---	PROPOSED EASEMENT LINE
---	MEASURED DIMENSION
---	COMPUTED DIMENSION
---	RECORDED DIMENSION
---	EXISTING BUILDING

- IRON PIPE OR ROD FOUND (UNLESS OTHERWISE NOTED)
- + THESE STAKES REFERENCE FOUND OR SET MONUMENTATION. SET 5/8 INCH IRON ROD FLUSH WITH GROUND TO THE FOUND IRON STAKE. IDENTIFIED BY COLORED PLASTIC CAP BEARING SURVEYOR'S REGISTRATION NUMBER.
- T1 THESE STAKES, IN CULTIVATED AREAS REFERENCE FOUND OR SET MONUMENTATION.
- T2 BURIED 5/8 INCH IRON ROD 20 INCHES BELOW GROUND TO TIE FOUND IRON STAKE. IDENTIFIED BY COLORED PLASTIC CAP BEARING SURVEYOR'S REGISTRATION NUMBER.
- T3
- STAKING OF PROPOSED RIGHT OF WAY. SET DIVISION OF HIGHWAYS SURVEY MARKER TO MONUMENT THE POSITION SHOWN. IDENTIFIED BY INSCRIPTION DATA AND SURVEYOR'S REGISTRATION NUMBER.
- M STAKING OF PROPOSED RIGHT OF WAY ON CULTIVATED AREAS. BURIED 5/8 INCH METAL ROD 20 INCHES BELOW GROUND TO MARK FUTURE SURVEY MARKER POSITION IDENTIFIED BY COLORED PLASTIC CAP BEARING SURVEYOR'S REGISTRATION NUMBER.
- ⊙ PERMANENT SURVEY MARKER, I.D.O.T. STD. 2135 (TO BE SET BY OTHERS)
- RIGHT OF WAY STAKING PROPOSED TO BE SET

STATE OF ILLINOIS }  
COUNTY OF DU PAGE }

THIS IS TO CERTIFY THAT I, HAROLD C WESTPHAL JR., AN ILLINOIS PROFESSIONAL LAND SURVEYOR, HAVE SURVEYED THE PLAT OF HIGHWAYS SHOWN HEREON IN SECTIONS 21, 27, 28, 32 & 33, TOWNSHIP 43 NORTH, RANGE 7 EAST AND SECTIONS 4 & 5, TOWNSHIP 42 NORTH, RANGE 7 EAST OF THE THIRD PRINCIPAL MERIDIAN, McHENRY & KANE COUNTIES. THAT THE SURVEY IS TRUE AND COMPLETE AS SHOWN TO THE BEST OF MY KNOWLEDGE AND BELIEF, THAT THE PLAT CORRECTLY REPRESENTS SAID SURVEY, THAT ALL MONUMENTS FOUND AND ESTABLISHED ARE OF PERMANENT QUALITY AND OCCUPY THE POSITIONS SHOWN THEREON AND THAT THE MONUMENTS ARE SUFFICIENT TO ENABLE THE SURVEY TO BE RETRACED, MADE FOR THE DEPARTMENT OF TRANSPORTATION, STATE OF ILLINOIS.

DATED AT ROSELLE, ILLINOIS, THIS 18th DAY OF JULY, 2007 A.D.



*Harold C. Westphal Jr.*  
ILLINOIS PROFESSIONAL LAND SURVEYOR NO. 35-1973  
EXPIRES NOVEMBER 30, 2008

**PAVIA-MARTING & CO.**  
910 WEST LAKE STREET  
ROSELLE, IL 60172-3352  
(630) 529-8000 FAX (630) 894-4916  
Data Firm Professional Registration #24002376

- SURVEYOR NOTE:
- ALL DIMENSIONS ARE IN FEET AND DECIMAL PARTS THEREOF.
  - COORDINATES ARE GROUND VALUES AND CAN BE CONVERTED TO GRID VALUES BY MULTIPLYING THE PUBLISHED GROUND COORDINATES BY 0.999968.
  - BUILDINGS SHOWN WITHOUT TIES WERE SCALED FROM AERIAL IMAGES. SIZE AND LOCATION ARE APPROXIMATE.

SHEET NO. 1 IS A COVER SHEET & NOT RECORDED

REVISION	DATE	DESCRIPTION
12-18-07	REV	PARCEL 68
01-17-08	REV	68TE-B
01-17-08	ADD	1EW0068
10-09-08	ADD	1EW0068PE
10-16-08	REV	1EW1068PE

ILLINOIS DEPT. OF TRANSPORTATION  
PLAT OF HIGHWAYS

ROUTE FAP 326 (IL 47)  
SECTION REED RD. TO KREUTZER RD.  
COUNTY McHENRY  
JOB# R-91-018-01 PROJECT# R-91-018-01  
SEC 33 T 43 . R 7 OF 3rd P.M.  
STA 56+49 TO STA 62+66  
DRAWN JR CHECKED HCW  
SCALE: 1"=40' SHEET NO. 10 OF XX

PARCEL NUMBER	OWNER	TOTAL HOLDING ACRES	TAKEN AREA ACRES SQ. FT.	PREVIOUSLY DEDICATED ACRES SQ. FT.	REMAINDER AREA ACRES	EASEMENT AREA ACRES SQ. FT.	PURPOSE OF EASEMENT	PERMANENT TAX NUMBER	PROPERTY ACQUIRED BY
1EW0068	HUNTLEY PARK DISTRICT	89.232	0.009 378		89.223	N/A N/A	N/A	18-33-151-001 18-33-151-004 18-32-276-001	
1EW1068PE			N/A N/A			0.010 N/A	PERMANENT		
1EW0068TE-A			N/A N/A			0.231 N/A	CONSTRUCTION		
1EW0068TE-B			N/A N/A			0.097 N/A	CONSTRUCTION		

LINE #	BEARING	DISTANCE
L386	S 05° 04' 39" W	30.11
L387	N 05° 32' 50" E	43.28
L388	S 88° 31' 57" W	111.54
L389	S 05° 04' 39" W	14.35
L390	S 46° 23' 17" E	37.39
L391	N 84° 55' 21" W	15.00
L392	N 05° 04' 39" E	30.00
L393	N 05° 04' 39" E	25.85
L394	N 89° 54' 36" W	29.36
L395	S 84° 55' 21" E	15.00
L396	S 05° 04' 39" W	30.00
L397	S 05° 04' 39" W	108.68

LINE #	BEARING	DISTANCE
L52	S 84° 55' 21" E	20.00

COORDINATES			
Station	Offset	North	East
62+02.08	60.00 LT	2002696.264	958424.878
399+07.30	31.95 RT	2002722.057	958397.803

RECEIVED pk  
OCT 18 2008  
PLATS & LEGALS

SCANNED

SEE SHEET 9

SEE SHEET 12

SEE SHEET 11