

F.A.P. RTE.	SECTION	COUNTY	TOTAL SHEETS	SHEET NO.
326	•	McHENRY	502	277
STA. 9+35.22		TO STA.142+08.53		
FED. ROAD DIST. NO.		ILLINOIS FED. AID PROJECT		

TEMPORARY TRAFFIC SIGNAL LEGEND

- ◀ TEMPORARY TRAFFIC SIGNAL HEAD SPAN WIRE MOUNTED ORIGINAL LOCATION
- ↖ TEMPORARY TRAFFIC SIGNAL HEAD SPAN WIRE MOUNTED SECONDARY LOCATION
- ⊗ TEMPORARY WOOD POLE (CLASS 5 OR BETTER) 45 FOOT (13.7M) MINIMUM
- ⊠ TEMPORARY CONTROLLER CABINET
- TEMPORARY SPAN WIRE, TETHER WIRE, AND CABLE
- ⊕ TEMPORARY SERVICE INSTALLATION
- ⊔ TEMPORARY PEDESTRIAN SIGNAL HEAD, BRACKET MOUNTED
- ⊙ MICROWAVE VEHICLE SENSOR
- ⊙ PEDESTRIAN PUSHBUTTON DETECTOR
- ⊙ FM/FREQUENCY VEHICLE LIGHT DETECTOR
- ⊙ CONFIRMATION BEACON
- ⊙ VEHICLE DETECTOR, INDUCTION LOOP
- CT COMMON TRENCH
- UD UNIT DUCT
- G.S. CONDUIT IN GROUND
- ⊔ HANDHOLE
- ⊔ HEAVY DUTY HANDHOLE
- ⊔ VIDEO CAMERA ASSEMBLY

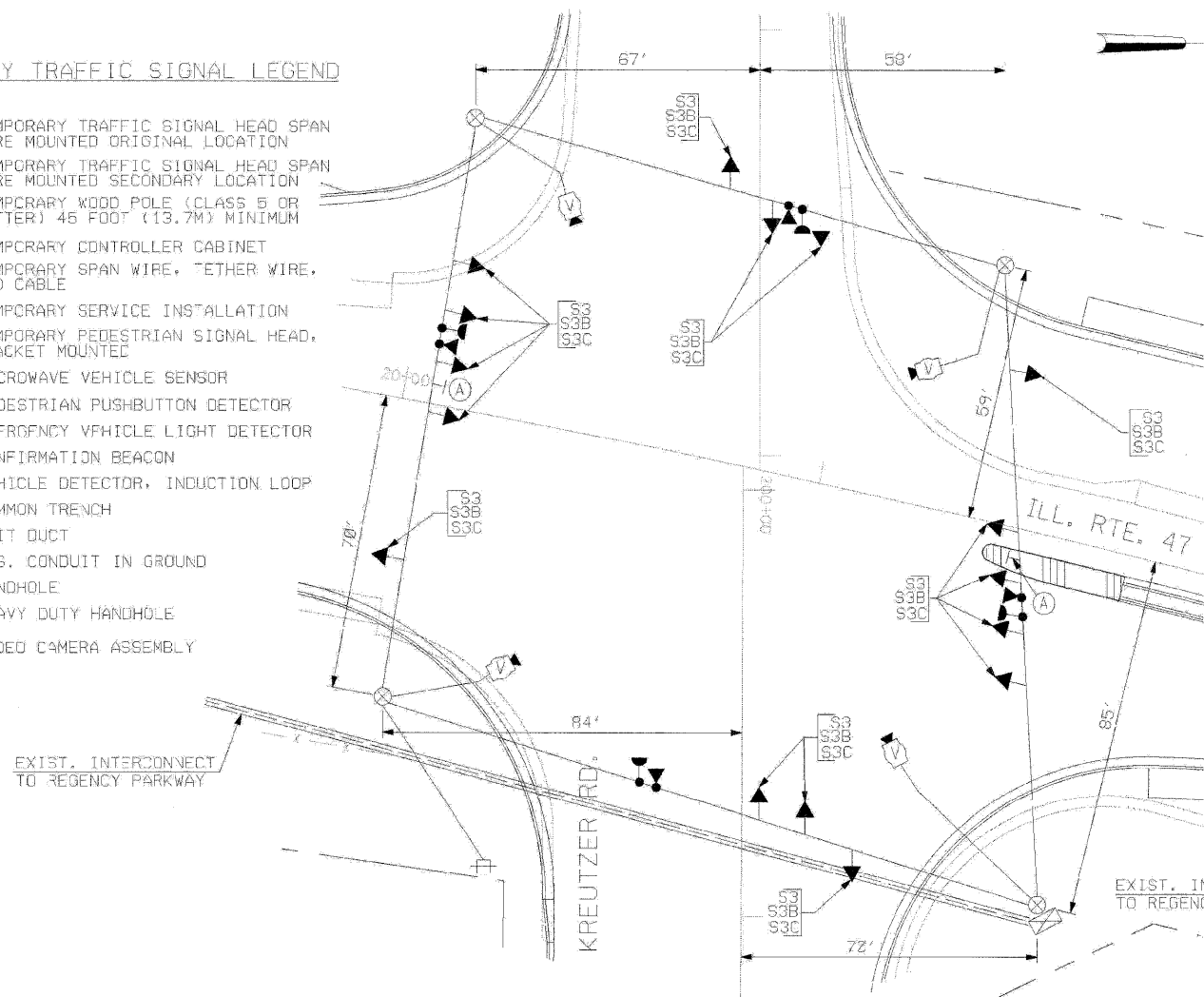

TEMPORARY TRAFFIC SIGNAL PLAN
(SCALE: 1"=20')
STAGES: STAGE 3, STAGE 3B, AND STAGE 3C

Ⓐ
LEFT ON
GREEN
ARROW
ONLY
R10-6, 24" X 30"
(2 REQUIRED, INCIDENTAL)

TEMPORARY CABLE DIAGRAM LEGEND

- ⊠ TEMPORARY TRAFFIC SIGNAL SECTION OR PEDESTRIAN SIGNAL SECTION 12" (300MM)
- ⊠ TEMPORARY CONTROLLER CABINET
- ⊠ TEMPORARY SERVICE INSTALLATION
- ⑤ INDICATES NUMBER OF CONDUCTORS IN CABLE. ALL CONDUCTORS TO BE NUMBER 14 AWG WIRE UNLESS OTHERWISE NOTED.
- ⊙ EMERGENCY VEHICLE LIGHT DETECTOR
- ⊙ CONFIRMATION BEACON
- ⊙ VEHICLE DETECTOR, INDUCTION LOOP
- ⊙ PEDESTRIAN PUSHBUTTON DETECTOR
- ⊙ 12" (300MM) PEDESTRIAN SIGNAL SECTION
- ⊔ VIDEO CAMERA ASSEMBLY
- ⊙ CO-AXIAL VIDEO CABLE

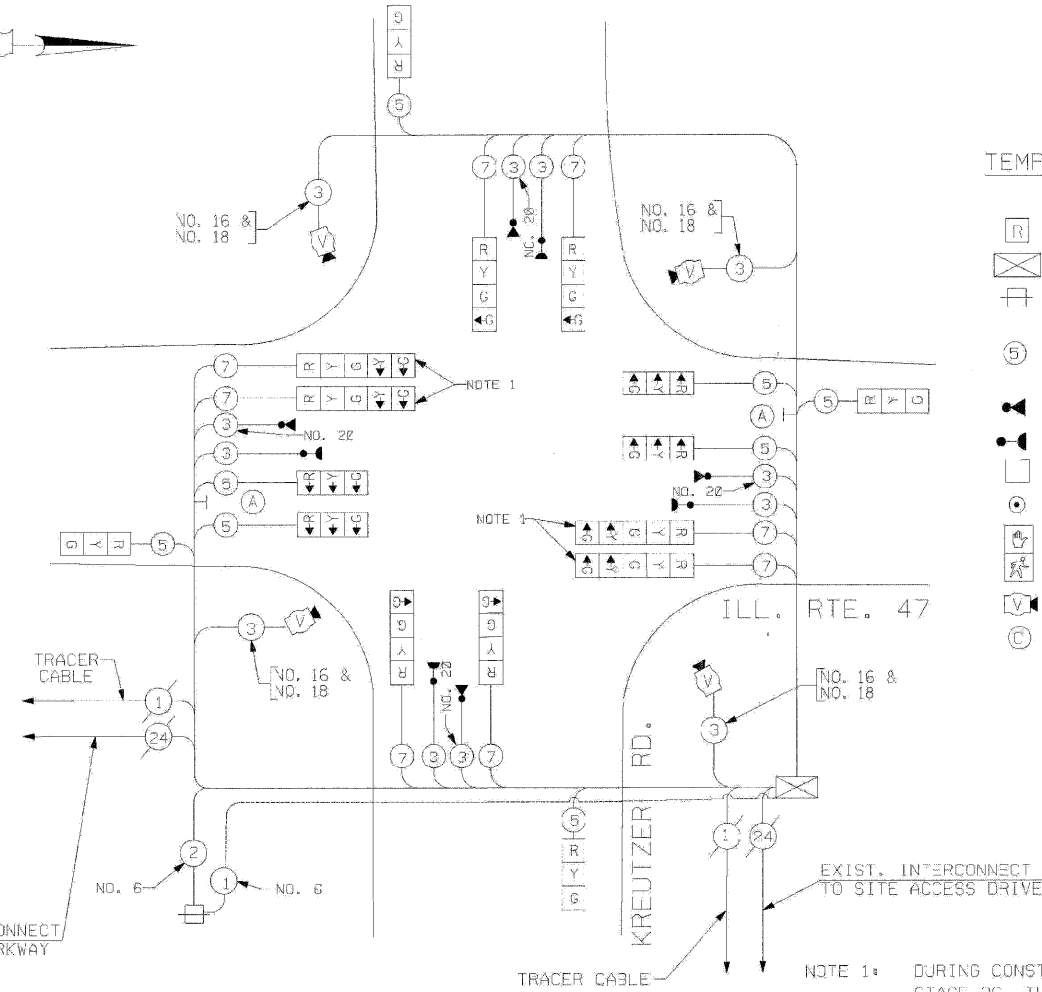

TEMPORARY CABLE PLAN
(NOT TO SCALE)
STAGES: STAGE 3, STAGE 3B, AND STAGE 3C

- NOTE 1: DURING CONSTRUCTION STAGES STAGE 3, STAGE 3B, AND STAGE 3C, THE GREEN AND YELLOW LEFT ARROW INDICATION SECTIONS FOR THE NORTHBOUND AND SOUTHBOUND DIRECTION OF TRAFFIC SHALL BE BAGGED AND DISCONNECTED AT THE CONTROLLER. THEY SHALL BE UNBAGGED AND CONNECTED AFTER CONSTRUCTION STAGE 3C AS DIRECTED BY THE ENGINEER.
- NOTE 2: ALL THE VIDEO DETECTION ZONES SHALL BE REDEFINED FOR EACH CONSTRUCTION STAGE. THIS WORK IS INCIDENTAL TO THE PAY ITEM "MODIFY TEMPORARY TRAFFIC SIGNAL INSTALLATION".
- NOTE 3: ALL THE TEMPORARY TRAFFIC SIGNAL HEADS SHALL BE LED TYPE.

THE TRAFFIC SIGNAL CONTROL EQUIPMENT FOR THIS PROJECT SHALL BE "EAGLE" TO MATCH THE EXISTING ADJACENT SYSTEM.

I.D.D.T. TRAFFIC SIGNAL INSTALLATION ELECTRICAL SERVICE REQUIREMENTS					TOTAL WATTAGE
TYPE	NO LAMPS	WATTAGE		%OPERATION	
SIGNAL (RED)	16	INCAND.	17	0.50	136
		LED	25	0.25	
		LED	15	0.25	
ARROW (GREEN)	20	135	15	0.25	75
ARROW		135	12	0.10	
PED. SIGNAL		90	25	1.00	
CONTROLLER	1	100	100	1.00	100
ILLUM. STGN				0.05	
FLASHER				0.50	
ENERGY COSTS TO:				TOTAL =	411

ILLINOIS DEPARTMENT OF TRANSPORTATION
201 WEST CENTER COURT
SCHAUMBURG, ILLINOIS 60196-1096
ENERGY SUPPLY CONTACT: KATIE OLIVA
PHONE: (847) 608-2338
COMPANY: COMED

GO GANDHI AND ASSOCIATES, INC.
ENGINEERS AND PLANNERS
6055 N. NORTHWEST HIGHWAY
SUITE 308
CHICAGO, ILLINOIS 60631 TEL: (773) 774-8910

REVISIONS	
NAME	DATE

ILLINOIS DEPARTMENT OF TRANSPORTATION
TEMPORARY TRAFFIC SIGNAL INSTALLATION PLAN, TEMPORARY CABLE PLAN
ILLINOIS ROUTE 47 AT KREUTZER ROAD
STAGE 3, STAGE 3B, AND STAGE 3C
(SHEET 5 OF 7)
SCALE: 1"=20'
DATE: APRIL 17, 2009
DRAWN BY: ME/MA,YB
DESIGNED BY: PKG/RRM
CHECKED BY: PKG/RRM