

F.A.P. RTE.	SECTION	COUNTY	TOTAL SHEETS	SHEET NO.
326	*	McHENRY	502	305
STA. 9+35.22		TO STA. 142+08.53		
FED. ROAD DIST. NO.		ILLINOIS FED. AID PROJECT		

TEMPORARY TRAFFIC SIGNAL LEGEND

- ◀ TEMPORARY TRAFFIC SIGNAL HEAD SPAN WIRE MOUNTED ORIGINAL LOCATION
- ◀ TEMPORARY TRAFFIC SIGNAL HEAD SPAN WIRE MOUNTED SECONDARY LOCATION
- ⊗ TEMPORARY WOOD PCLE (CLASS 5 OR BETTER) 45 FOOT (13.7M) MINIMUM
- ⊗ TEMPORARY CONTROLLER CABINET
- ⊗ TEMPORARY SPAN WIRE, TETHER WIRE, AND CABLE
- TEMPORARY SERVICE INSTALLATION
- ⊕ TEMPORARY PEDESTRIAN SIGNAL HEAD, BRACKET MOUNTED
- ⊕ MICROWAVE VEHICLE SENSOR
- ⊕ PEDESTRIAN PUSHBUTTON DETECTOR
- ⊕ EMERGENCY VEHICLE LIGHT DETECTOR
- ⊕ CONFIRMATION BEACON
- ⊕ VEHICLE DETECTOR, INDUCTION LOOP
- CT COMMON TRENCH
- UD UNIT DUCT
- G.S. CONDUIT IN GROUND
- ⊕ HANDHOLE
- ⊕ HEAVY DUTY HANDHOLE
- ⊕ VIDEO CAMERA ASSEMBLY

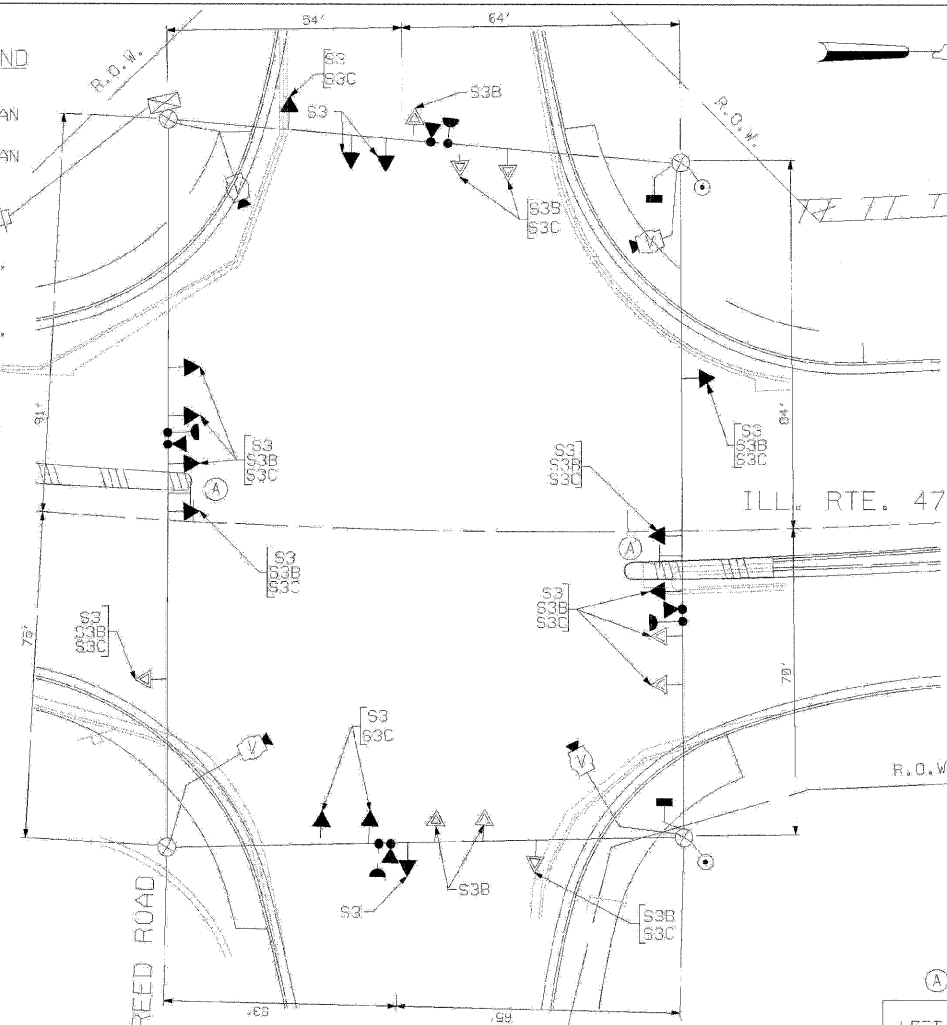

TEMPORARY TRAFFIC SIGNAL PLAN
(SCALE: 1"=20')
STAGES: STAGE 3, STAGE 3B, AND STAGE 3C.

(A)
LEFT ON GREEN ARROW ONLY
R12 5, 24" X 30"
(2 REQUIRED, INCIDENTAL)

TEMPORARY CABLE DIAGRAM LEGEND

- ⊗ TEMPORARY TRAFFIC SIGNAL SECTION OR PEDESTRIAN SIGNAL SECTION 12" (300MM)
- ⊗ TEMPORARY CONTROLLER CABINET
- ⊗ TEMPORARY SERVICE INSTALLATION
- (5) INDICATES NUMBER OF CONDUCTORS IN CABLE. ALL CONDUCTORS TO BE NUMBER 14 AWG WIRE UNLESS OTHERWISE NOTED.
- ⊕ EMERGENCY VEHICLE LIGHT DETECTOR
- ⊕ CONFIRMATION BEACON
- ⊕ VEHICLE DETECTOR, INDUCTION LOOP
- ⊕ PEDESTRIAN PUSHBUTTON DETECTOR
- ⊕ 12" (300MM) PEDESTRIAN SIGNAL SECTION
- ⊕ VIDEO CAMERA ASSEMBLY
- ⊕ CO-AXIAL VIDEO CABLE
- ⊕ SIGN PANEL

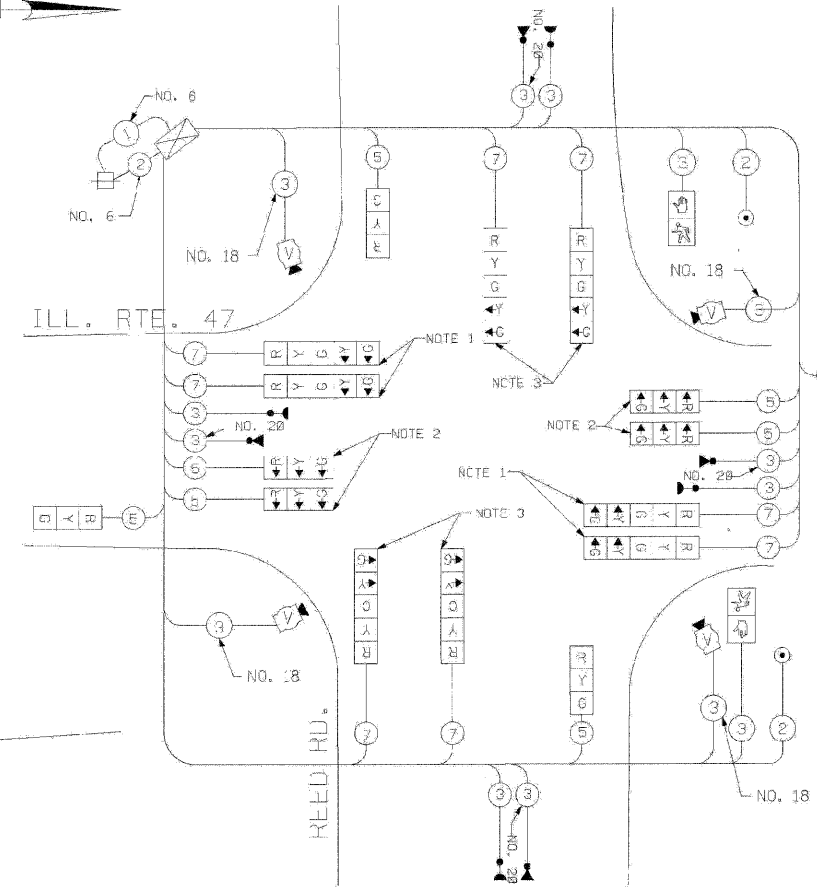

TEMPORARY CABLE PLAN

(NOT TO SCALE)
STAGES: STAGE 3, STAGE 3B, AND STAGE 3C.

- NOTE 1: DURING CONSTRUCTION STAGE 3, STAGE 3B, AND STAGE 3C, THE GREEN AND YELLOW LEFT ARROW INDICATION SECTIONS FOR THE NORTHBOUND AND SOUTHBOUND DIRECTION OF TRAFFIC SHALL BE BAGGED AND DISCONNECTED AT THE CONTROLLER. THEY SHALL BE UNBAGGED AND CONNECTED AT THE CONTROLLER AFTER CONSTRUCTION STAGE 3C UNTIL PROPOSED TRAFFIC SIGNALS ARE MADE OPERATIONAL.
- NOTE 2: THESE SIGNAL HEADS WITH ALL ARROW INDICATIONS SHALL BE BAGGED AND DISCONNECTED AT THE CONTROLLER AFTER CONSTRUCTION STAGE 3C, WHEN ALL THE PROPOSED ROADWAY GEOMETRICS ARE BUILT AND OPEN TO TRAFFIC. THESE SIGNAL HEADS ARE NEEDED IN STAGES 3, 3B, AND 3C ONLY AND CAN BE REMOVED AFTER STAGE 3C WITH APPROVAL OF THE ENGINEER.
- NOTE 3: THE YELLOW LEFT ARROW INDICATION SECTION IN THE 5-SECTION SIGNAL HEADS FOR THE EASTBOUND AND WESTBOUND DIRECTION SHALL REMAIN BAGGED AND DISCONNECTED AT THE CONTROLLER THRU CONSTRUCTION STAGE 3, STAGE 3B, AND STAGE 3C.
- NOTE 4: ALL THE VIDEO DETECTION ZONES SHALL BE REDEFINED FOR EACH CONSTRUCTION STAGE. THIS WORK IS INCIDENTAL TO THE PAY ITEM "TEMPORARY TRAFFIC SIGNAL INSTALLATION".
- NOTE 5: ALL THE TEMPORARY TRAFFIC SIGNAL HEADS SHALL BE LED TYPE.

THE TRAFFIC SIGNAL EQUIPMENT FOR THIS PROJECT SHALL BE "EAGLE" TO MATCH THE EXISTING ADJACENT SYSTEM.

I.D.O.T. TRAFFIC SIGNAL INSTALLATION ELECTRICAL SERVICE REQUIREMENTS					
TYPE	NO LAMPS	WATTAGE		OPERATION	TOTAL WATTAGE
SIGNAL (RED)	16	135	17	0.50	126
(YELLOW)	16	135	25	0.25	100
(GREEN)	20	135	15	0.25	70
ARROW		135	12	0.10	
PED. SIGNAL	2	90	25	1.00	50
CONTROLLER	1	100	100	1.00	100
ILLUM. SIGN				0.25	
FLASHER				0.50	
ENERGY COSTS TO:					TOTAL =
ILLINOIS DEPARTMENT OF TRANSPORTATION 201 WEST CENTER COURT SCHAUMBURG, ILLINOIS 60196-1096					461
ENERGY SUPPLY CONTACT: KATIE OLIVA PHONE: (847) 608-2339 COMPANY: COMED					

ILLINOIS DEPARTMENT OF TRANSPORTATION
TEMPORARY TRAFFIC SIGNAL INSTALLATION PLAN, TEMPORARY CABLE PLAN
ROUTE 47 AT REED ROAD
STAGE 3, STAGE 3B, AND STAGE 3C
(SHEET 3 OF 4)

SCALE: 1"=20'
DATE: APRIL 17, 2009

DRAWN BY: ME,MA,YB
DESIGNED BY: PKC/RM
CHECKED BY: FRG/RM

GO GANDHI AND ASSOCIATES, INC.
ENGINEERS AND PLANNERS
6035 N. WORTHWEST HIGHWAY
SUITE 300
CHICAGO, ILLINOIS 60631 TEL: (773) 774-5900

REVISIONS	
NAME	DATE

PLOT DATE = 4/24/2009
FILE NAME = 04111-0000-01-11-11-11-11.dwg
PLOT SCALE = 1:1
USER NAME = 3830

04111-0000-01-11-11-11.dwg
4/24/2009
3:06:26 PM