

F.A.P. RTE.	SECTION	COUNTY	TOTAL SHEETS	SHEET NO.
326		McHENRY	502	307
STA. 9+35.22		TO STA. 142+08.53		
FED. ROAD DIST. NO.		ILLINOIS FED. AID PROJECT		

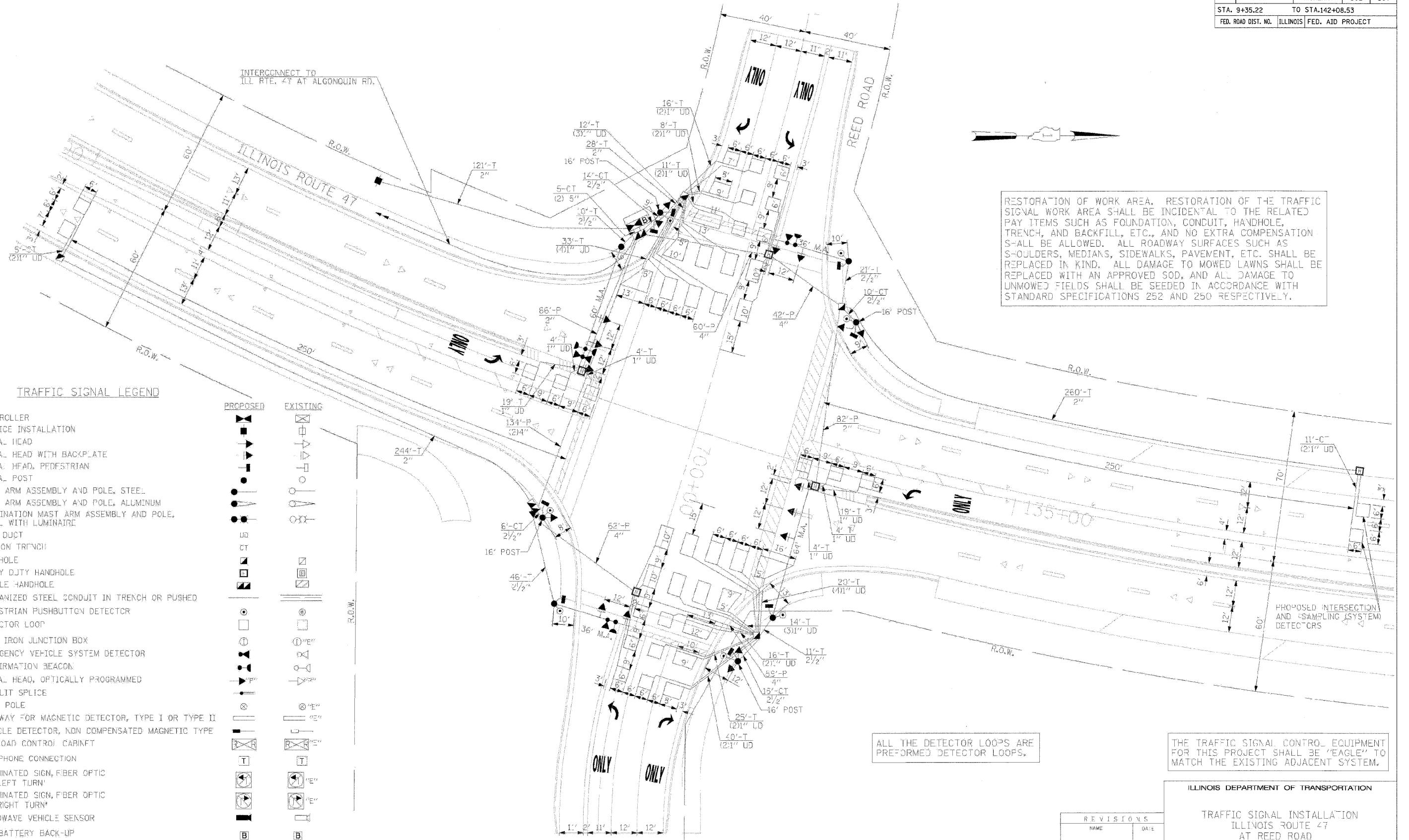

RESTORATION OF WORK AREA. RESTORATION OF THE TRAFFIC SIGNAL WORK AREA SHALL BE INCIDENTAL TO THE RELATED PAY ITEMS SUCH AS FOUNDATION, CONDUIT, HANDHOLE, TRENCH, AND BACKFILL, ETC., AND NO EXTRA COMPENSATION SHALL BE ALLOWED. ALL ROADWAY SURFACES SUCH AS SHOULDERS, MEDIANS, SIDEWALKS, PAVEMENT, ETC. SHALL BE REPLACED IN KIND. ALL DAMAGE TO MOWED LAWNS SHALL BE REPLACED WITH AN APPROVED SOD, AND ALL DAMAGE TO UNMOWED FIELDS SHALL BE SEEDING IN ACCORDANCE WITH STANDARD SPECIFICATIONS 252 AND 250 RESPECTIVELY.

TRAFFIC SIGNAL LEGEND

- | | | |
|--|----------|----------|
| CONTROLLER | PROPOSED | EXISTING |
| SERVICE INSTALLATION | [Symbol] | [Symbol] |
| SIGNAL HEAD | [Symbol] | [Symbol] |
| SIGNAL HEAD WITH BACKPLATE | [Symbol] | [Symbol] |
| SIGNAL HEAD, PEDESTRIAN | [Symbol] | [Symbol] |
| SIGNAL POST | [Symbol] | [Symbol] |
| MAST ARM ASSEMBLY AND POLE, STEEL | [Symbol] | [Symbol] |
| MAST ARM ASSEMBLY AND POLE, ALUMINUM | [Symbol] | [Symbol] |
| COMBINATION MAST ARM ASSEMBLY AND POLE, STEEL WITH LUMINAIRE | [Symbol] | [Symbol] |
| UNIT DUCT | [Symbol] | [Symbol] |
| COMMON TRENCH | [Symbol] | [Symbol] |
| HANDHOLE | [Symbol] | [Symbol] |
| HEAVY DUTY HANDHOLE | [Symbol] | [Symbol] |
| DOUBLE HANDHOLE | [Symbol] | [Symbol] |
| GALVANIZED STEEL CONDUIT IN TRENCH OR PUSHED | [Symbol] | [Symbol] |
| PEDESTRIAN PUSHBUTTON DETECTOR | [Symbol] | [Symbol] |
| DETECTOR LOOP | [Symbol] | [Symbol] |
| CAST IRON JUNCTION BOX | [Symbol] | [Symbol] |
| EMERGENCY VEHICLE SYSTEM DETECTOR | [Symbol] | [Symbol] |
| CONFIRMATION BEACON | [Symbol] | [Symbol] |
| SIGNAL HEAD, OPTICALLY PROGRAMMED | [Symbol] | [Symbol] |
| CONDUIT SPLICE | [Symbol] | [Symbol] |
| WOOD POLE | [Symbol] | [Symbol] |
| RACEWAY FOR MAGNETIC DETECTOR, TYPE I OR TYPE II | [Symbol] | [Symbol] |
| VEHICLE DETECTOR, NON COMPENSATED MAGNETIC TYPE | [Symbol] | [Symbol] |
| RAILROAD CONTROL CABINETS | [Symbol] | [Symbol] |
| TELEPHONE CONNECTION | [Symbol] | [Symbol] |
| ILLUMINATED SIGN, FIBER OPTIC 'NO LEFT TURN' | [Symbol] | [Symbol] |
| ILLUMINATED SIGN, FIBER OPTIC 'NO RIGHT TURN' | [Symbol] | [Symbol] |
| MICROWAVE VEHICLE SENSOR | [Symbol] | [Symbol] |
| UPS-BATTERY BACK-UP | [Symbol] | [Symbol] |

ALL THE DETECTOR LOOPS ARE PRE-FORMED DETECTOR LOOPS.

THE TRAFFIC SIGNAL CONTROL EQUIPMENT FOR THIS PROJECT SHALL BE "EAGLE" TO MATCH THE EXISTING ADJACENT SYSTEM.

ILLINOIS DEPARTMENT OF TRANSPORTATION

**TRAFFIC SIGNAL INSTALLATION
ILLINOIS ROUTE 47
AT REED ROAD**

REVISIONS	
NAME	DATE

SCALE: 1"=20'
DATE: APRIL 17, 2009

DRAWN BY: MAA
DESIGNED BY: PKG/RRM
CHECKED BY: PKG/RRM



GANDHI AND ASSOCIATES, INC.
ENGINEERS AND PLANNERS
605 N. NORTHWEST HIGHWAY
SUITE 306
CHICAGO, ILLINOIS 60651 TEL: (773) 774-5900



GANDHI AND ASSOCIATES, INC.
ENGINEERS AND PLANNERS
605 N. NORTHWEST HIGHWAY
SUITE 306
CHICAGO, ILLINOIS 60651 TEL: (773) 774-5900