

FIELD ENGINEER: MARILIN D. SOLOMON (847) 705-4407
CONSULTANT: JAMES J. BENES & ASSOCIATES, INC. (630) 719-7570

F.A.U. RTE.	SECTION	COUNTY	TOTAL SHEETS	SHEET NO.
2662	-	DUPAGE	25	1
FED. ROAD DIST. NO.	ILLINOIS	FED. AID PROJECT		
CONTRACT NO. 63098				

STATE OF ILLINOIS
DEPARTMENT OF TRANSPORTATION
DIVISION OF HIGHWAYS

**PLANS FOR PROPOSED
FEDERAL AID HIGHWAY**

FOR INDEX OF SHEETS, SEE SHEET NO. 2

PLAN 1" = 20'
PROFILE HORIZ. 1" = 20'
PROFILE VERT. 1" = 5'
CROSS SECTIONS HORIZ. 1" = 10'
CROSS SECTIONS VERT. 1" = 5'

**F.A.U. ROUTE 2662 (JORIE BOULEVARD)
31st STREET TO 22nd STREET
SECTION NO. 08-00041-00-RS
LAPP ROADWAY RESURFACING
PROJECT NO. M-9003(159)
VILLAGE OF OAK BROOK
DuPAGE COUNTY
JOB NO. C-91-195-09**

TRAFFIC DATA
ADT = 13,200
SPEED LIMIT = 35 MPH

DESIGN DESIGNATION: COLLECTOR

PROJECT LOCATED IN
VILLAGE OF OAK BROOK

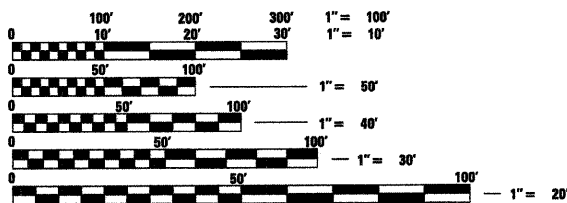

FULL SIZE PLANS HAVE BEEN PREPARED USING STANDARD ENGINEERING SCALES, REDUCED SIZED PLANS WILL NOT CONFORM TO STANDARD SCALES, IN MAKING MEASUREMENTS ON REDUCED PLANS, THE ABOVE SCALES MAY BE USED.

J.U.L.I.E.
JOINT UTILITY LOCATION INFORMATION FOR EXCAVATION
811



CONTRACT NO. 63098

YORK TOWNSHIP, SECTION 26 RANGE 11E

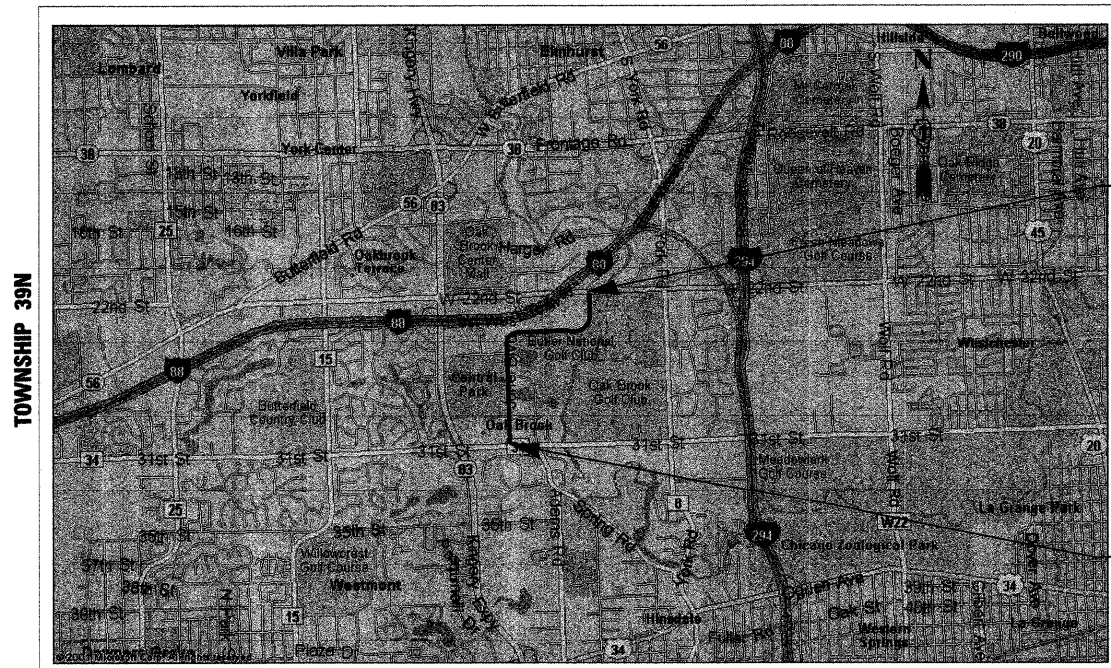

PROJECT ENDS
STA 78+11

PROJECT BEGINS
STA 1+25

SECTION 26, YORK TOWNSHIP 3rd P.M.
GROSS AND NET LENGTH OF PROJECT: 7686 FT (1.456 MILES)
SCALE: NTS
LOCATION MAP

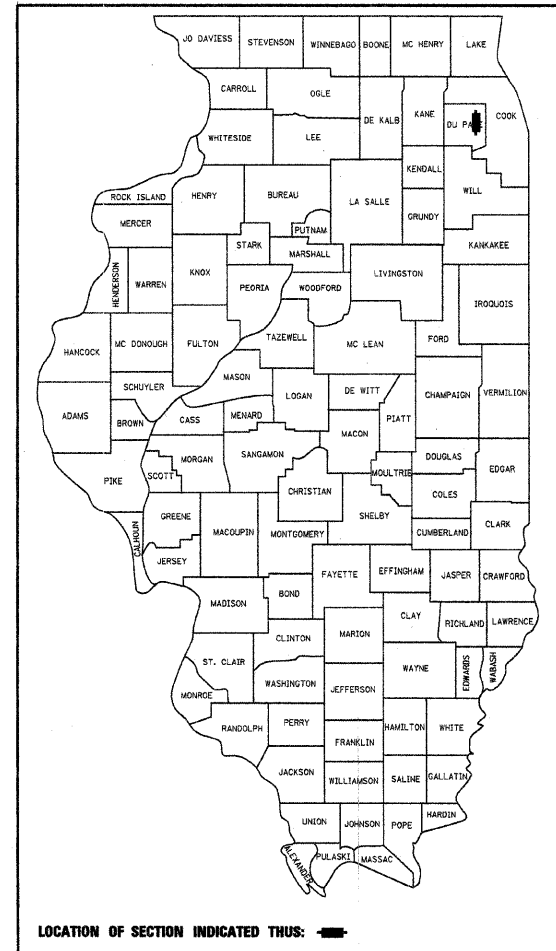

STATE OF ILLINOIS
DEPARTMENT OF TRANSPORTATION
DIVISION OF HIGHWAYS

APPROVED: AUGUST 25, 2009
Robert J. Benes
Oak Brook, Village Engineer

PASSED: OCTOBER 26, 2009
Cheryl Christensen
District 1 Engineer of Local Roads & Streets

Releasing for Bid
Based on Limited
Review OCTOBER 26, 2009
Diane M. O'Keefe
Deputy Director of Highways, Region 1 Engineer

PRINTED BY AUTHORITY OF THE STATE OF ILLINOIS

JJB
JAMES J. BENES & ASSOCIATES
CONSULTING ENGINEERS
(630) 719-7570
950 WARRENVILLE ROAD, SUITE 101
LISLE, IL 60532
SIGNATURE: *James J. Benes*
DATE: 8-25-09
IL LICENSE NO. 062-039438
EXP. DATE: NOVEMBER 30, 2009
FIELD: JAMES J. BENES AND ASSOCIATES, INC.