

F.A.U. RTE.	SECTION	COUNTY	TOTAL SHEETS	SHEET NO.
2662	08-00041-00-RS	DuPAGE	25	12
STA. 55+00		TO STA. 65+00		
ILLINOIS FED. AID PROJECT				
CONTRACT NO. 6309B				

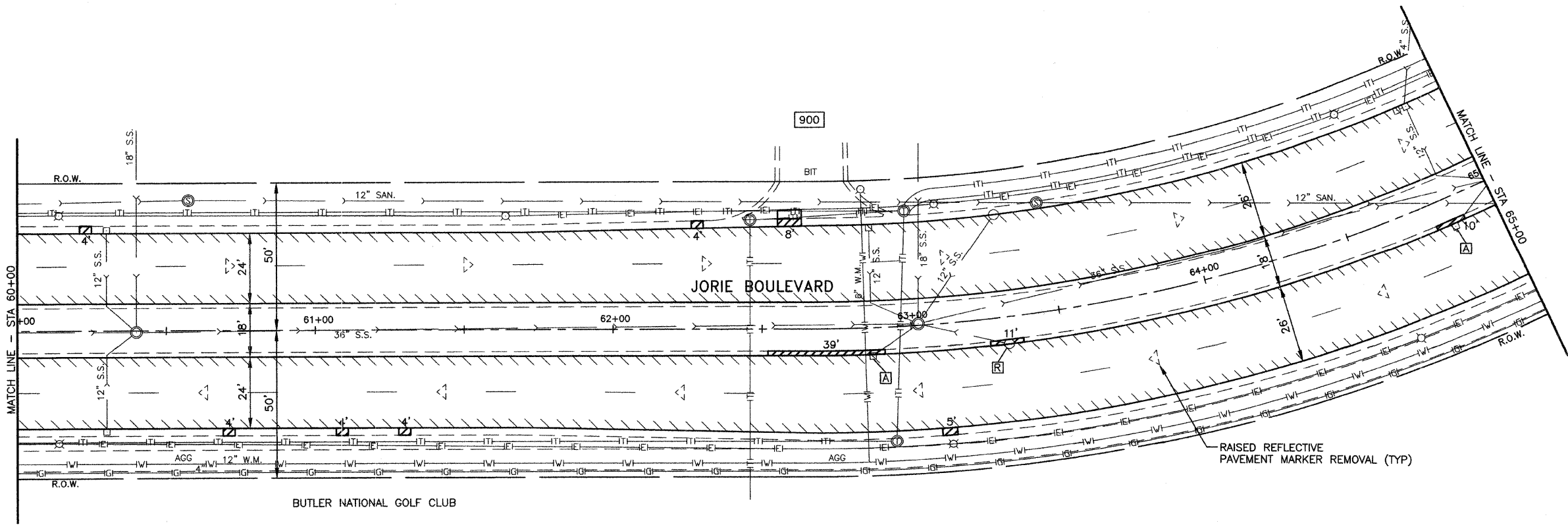
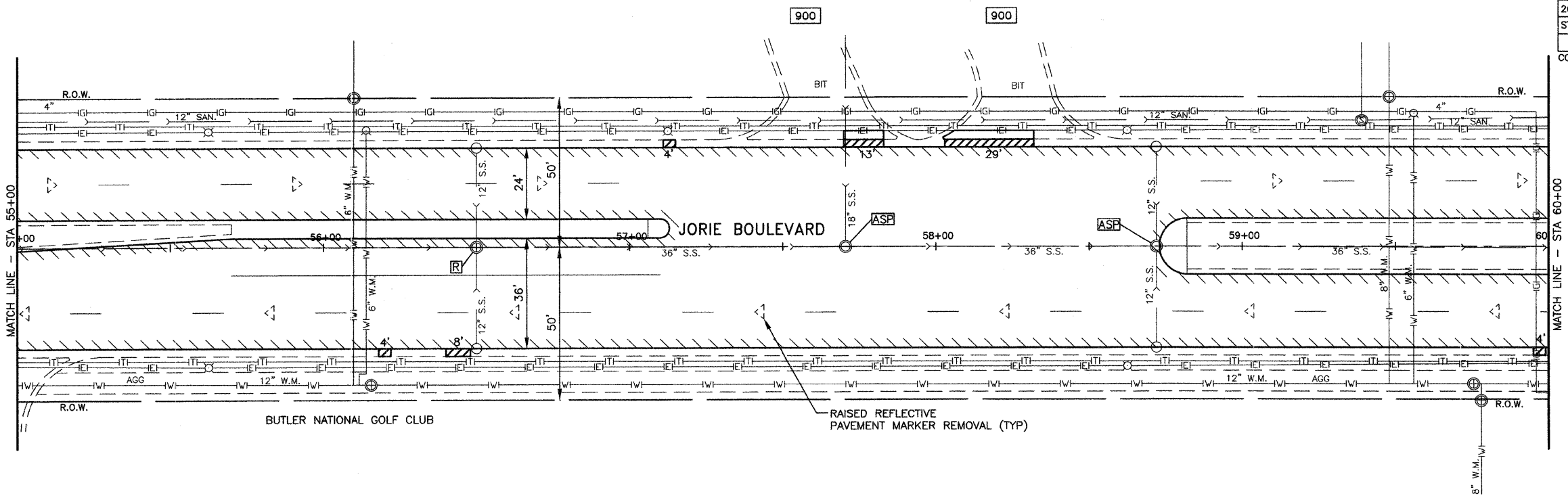

LEGEND

- A STRUCTURE TO BE ADJUSTED
- AS STRUCTURE TO BE ADJUSTED SPECIAL
- R STRUCTURE TO BE RECONSTRUCTED WITH NEW FRAME & LID
- RE STRUCTURE TO BE RECONSTRUCTED
- RM STRUCTURE TO BE REMOVED
- HMA HOT-MIX ASPHALT SURFACE REMOVAL LIMIT
- C&G COMBINATION CURB AND GUTTER REMOVAL OR CURB REMOVAL
- S SIDEWALK REMOVAL
- D DRIVEWAY REMOVAL AND REPLACEMENT AT CURB REPAIRS
- * DETECTIBLE WARNINGS

REVISIONS	
NAME	DATE

ILLINOIS DEPARTMENT OF TRANSPORTATION
 F.A.U. ROUTE 2662
 JORIE BOULEVARD

PLAN VIEW
 STA 55+00 TO STA 65+00

SCALE: 1"=20'
 DATE: 03/04/08

DRAWN BY: BCD
 CHECKED BY: JDM

JJB JAMES J. BENES & ASSOCIATES, INC.
 950 Warrenville Road, Suite 101, Lisle, Illinois 60532
 Tel. (630) 719-7570 • Fax (630) 719-7589