

F.A.U. RTE.	SECTION	COUNTY	TOTAL SHEETS	SHEET NO.
2662	08-00041-00-RS	DuPAGE	25	17
STA. 57+00		TO STA. 78+11		
ILLINOIS FED. AID PROJECT				
CONTRACT NO. 63098				

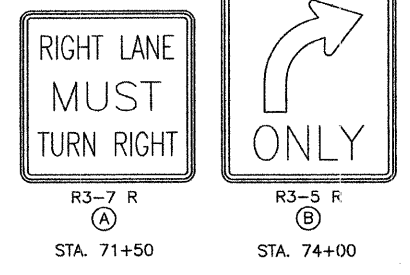
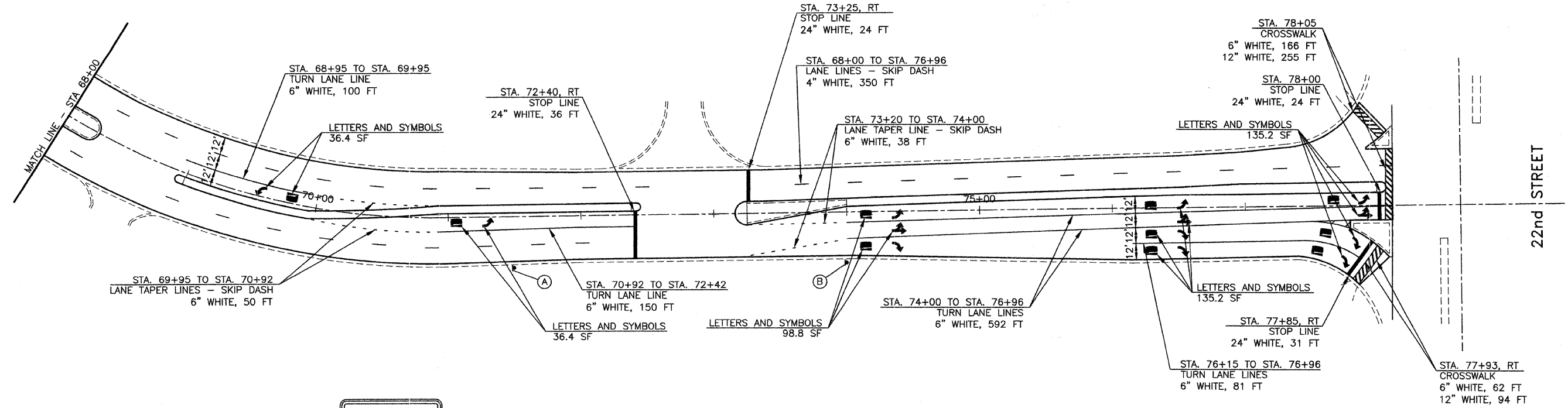
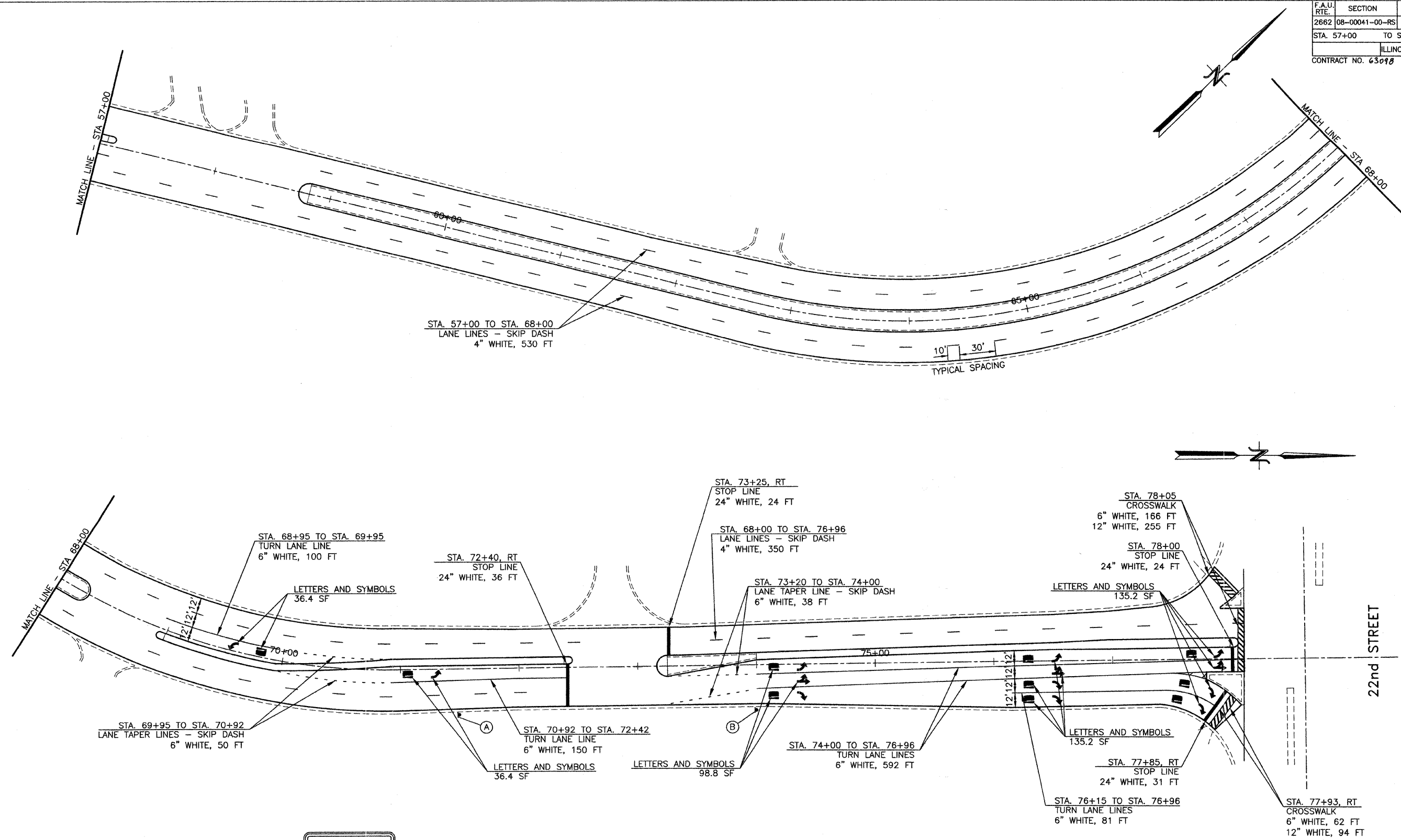

REVISIONS	
NAME	DATE

ILLINOIS DEPARTMENT OF TRANSPORTATION
 F.A.U. ROUTE 2662
 JORIE BOULEVARD

PAVEMENT MARKING PLAN
 STA. 57+00 TO STA. 78+11

SCALE: 1"=40'
 DATE: _____

DRAWN BY: BCD
 CHECKED BY: JDM

JJB
JAMES J. BENES & ASSOCIATES, INC.
 950 Warrenville Road, Suite 101, Lisle, Illinois 60532
 Tel. (630) 719-7570 • Fax (630) 719-7589