

TRAFFIC SIGNAL LEGEND

	PROPOSED	EXISTING		PROPOSED	EXISTING
CONTROLLER CABINET			PEDESTRIAN PUSHBUTTON DETECTOR		
SERVICE INSTALLATION			DETECTOR LOOP		
SIGNAL HEAD			CAST IRON JUNCTION BOX		
SIGNAL HEAD WITH BACKPLATE			EMERGENCY VEHICLE LIGHT DETECTOR		
SIGNAL HEAD, PEDESTRIAN			CONFIRMATION BEACON		
SIGNAL POST			SIGNAL HEAD OPTICALLY PROGRAMMED		
MAST ARM ASSEMBLY AND POLE, STEEL			CONDUIT SPLICE		
MAST ARM ASSEMBLY AND POLE, ALUMINUM			WOOD POLE		
COMBINATION MAST ARM ASSEMBLY AND POLE, STEEL WITH LUMINAIRE			RACEWAY FOR MAGNETIC DETECTOR, TYPE I OR TYPE II		
UNIT DUCT	UD		VEHICLE DETECTOR, NON COMPENSATED MAGNETIC TYPE		
COMMON TRENCH	CT		RAILROAD CONTROL CABINET		
HANDHOLE			TELEPHONE CONNECTION		
HEAVY DUTY HANDHOLE			ILLUMINATED SIGN "NO LEFT TURN"		
DOUBLE HANDHOLE			ILLUMINATED SIGN "NO RIGHT TURN"		
G.S. CONDUIT IN TRENCH (T) OR PUSHED (P)	T/P				

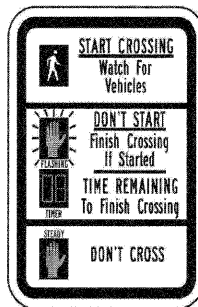
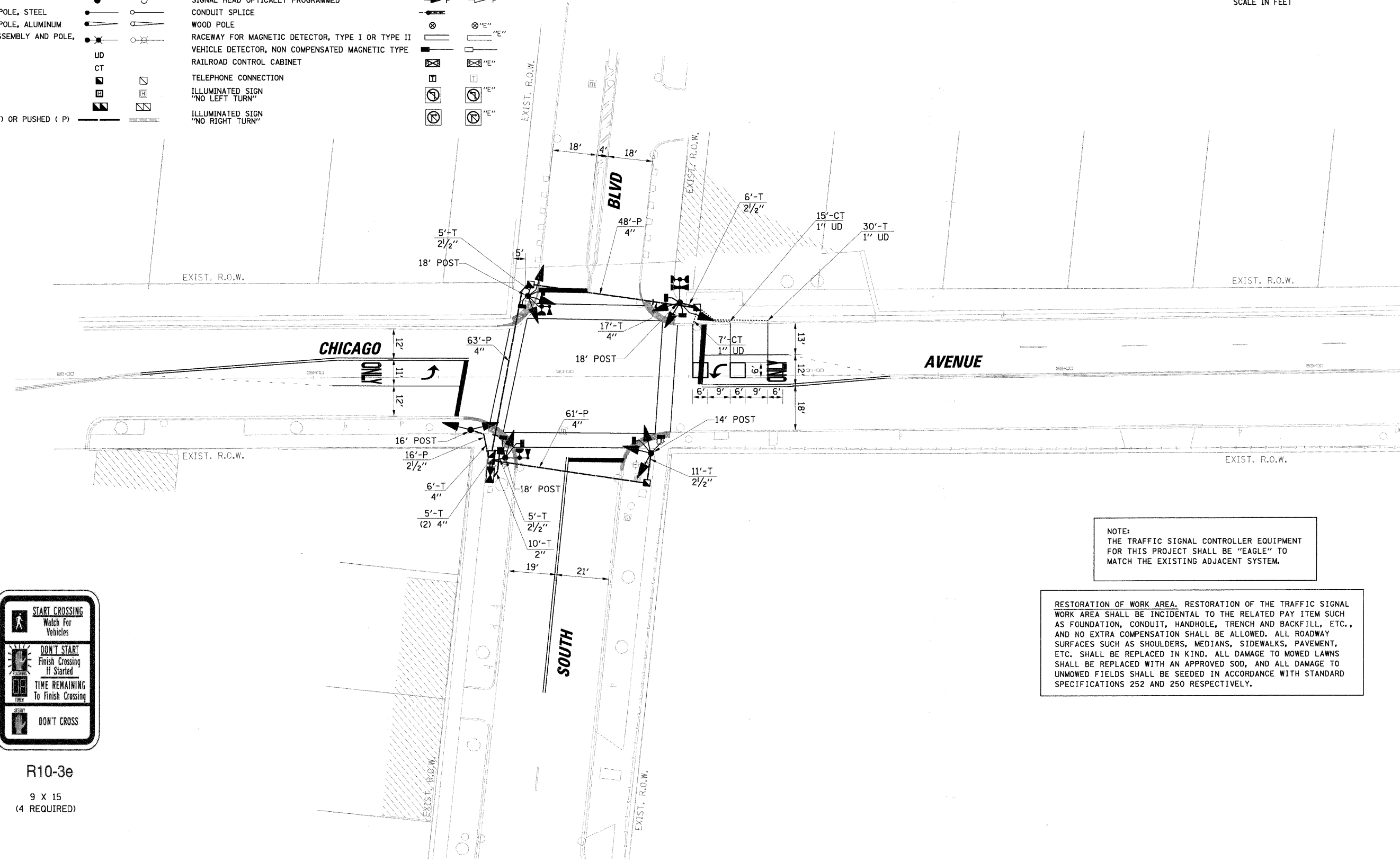
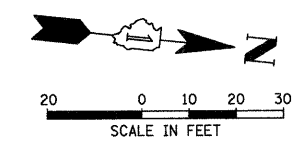

R10-3e
9 X 15
(4 REQUIRED)

NOTE:
THE TRAFFIC SIGNAL CONTROLLER EQUIPMENT FOR THIS PROJECT SHALL BE "EAGLE" TO MATCH THE EXISTING ADJACENT SYSTEM.

RESTORATION OF WORK AREA. RESTORATION OF THE TRAFFIC SIGNAL WORK AREA SHALL BE INCIDENTAL TO THE RELATED PAY ITEM SUCH AS FOUNDATION, CONDUIT, HANDHOLE, TRENCH AND BACKFILL, ETC., AND NO EXTRA COMPENSATION SHALL BE ALLOWED. ALL ROADWAY SURFACES SUCH AS SHOULDERS, MEDIANS, SIDEWALKS, PAVEMENT, ETC. SHALL BE REPLACED IN KIND. ALL DAMAGE TO MOWED LAWNS SHALL BE REPLACED WITH AN APPROVED SOD, AND ALL DAMAGE TO UNMOWED FIELDS SHALL BE SEEDED IN ACCORDANCE WITH STANDARD SPECIFICATIONS 252 AND 250 RESPECTIVELY.

PLAN	DATE	BY
DATE	BY <td>DATE</td>	DATE
NO.	NO.	NO.

CHRISTOPHER B. BURKE
ENGINEERING LTD.
9575 West Higgins Road, Suite 600
Rosemont, Illinois 60018
(647) 823-0500

FILE NAME = N:\EVANSTON\05282\Traffic\cvm00_south-chi.udgn	USER NAME = FPAICONE	DESIGNED -	REVISED -	STATE OF ILLINOIS DEPARTMENT OF TRANSPORTATION	TRAFFIC SIGNAL INSTALLATION PLAN CHICAGO AVENUE AT SOUTH BLVD	F.A.U. RTE. 2853	SECTION 05-00240-00-TL	COUNTY COOK	TOTAL SHEETS 24	SHEET NO. 8
PLOT SCALE = 20'	PLOT DATE = 11/2/2009	DRAWN -	REVISED -			CONTRACT NO. 63111				
		CHECKED -	REVISED -			FED. ROAD DIST. NO. ILLINOIS FED. AID PROJECT				
		DATE -	REVISED -							