

SECTION 17, TOWNSHIP 36, RANGE 14

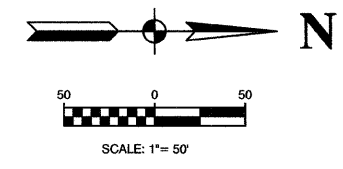
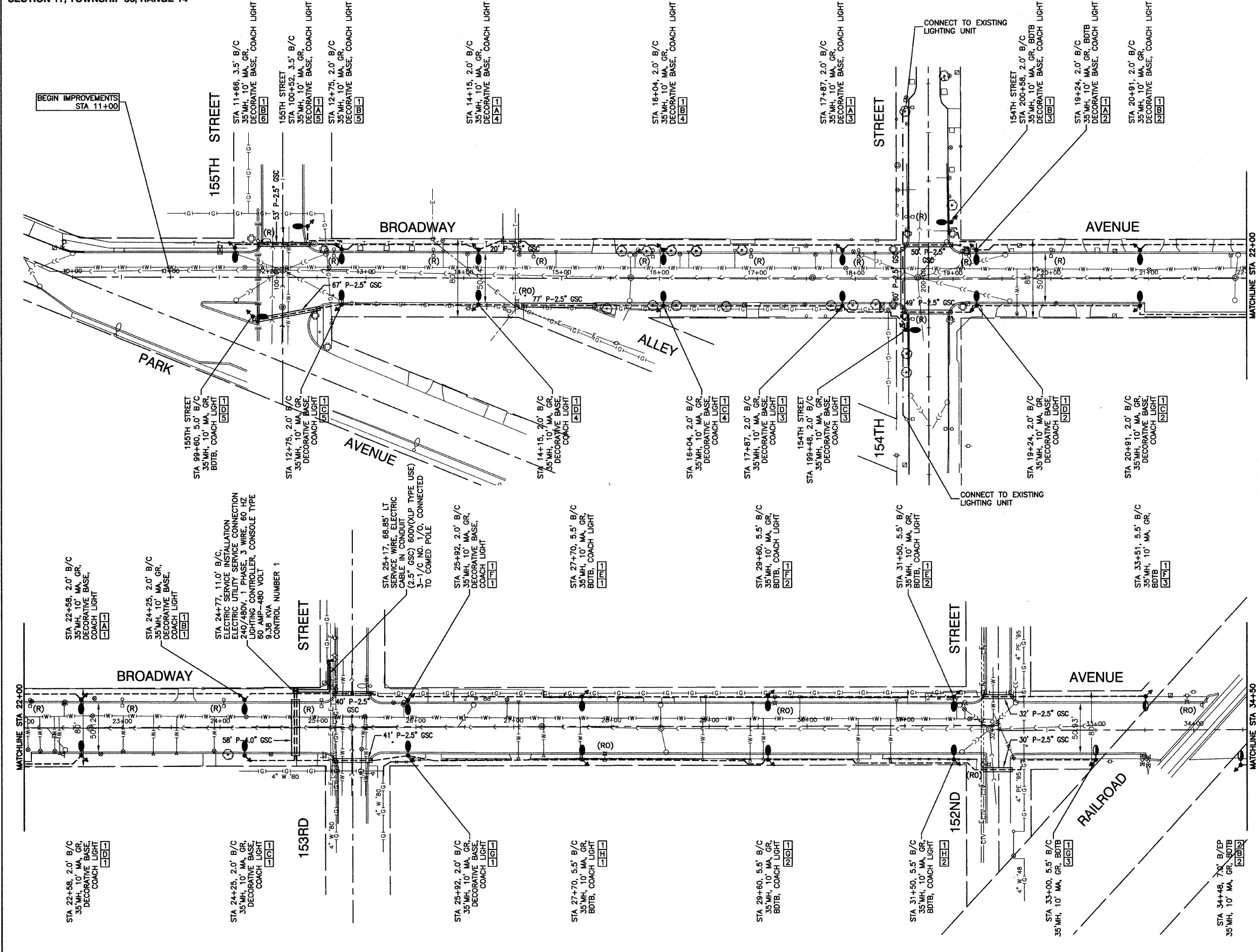

LEGEND:

- ○ EXISTING STREET LIGHT
- ● PROPOSED STREET LIGHT-250W HPS
- ● PROPOSED STREET LIGHT-150W HPS
- □ EXISTING CONTROLLER
- □ PROPOSED CONTROLLER, CONSOLE TYPE
- ⊞ ⊞ COMED POWER POLE FOR SERVICE CONNECTION
- — CONDUIT, PUSHED, GALVANIZED STEEL
- — CONDUIT, TRENCHED, GALVANIZED STEEL
- — UNIT DUCT, 600V, 3-1C NO.4, 1/C NO.6 GROUND, (XLP-TYPE USE), 1-1/4" DIA., POLYETHYLENE
- — UNIT DUCT, 600V, 2-1C NO.4, 1/C NO.6 GROUND, (XLP-TYPE USE), 1" DIA., POLYETHYLENE
- ⊗ GR GROUND ROD, 5/8" DIA. x 10'
- (R) REMOVAL OF EXISTING STREET LIGHT (SALVAGE)
- (RO) REMOVAL OF EXISTING STREET LIGHT (BY OTHERS)
- MH MOUNTING HEIGHT
- MA MAST ARM
- B/C BACK OF CURB
- B/EP BEHIND EDGE OF PAVEMENT
- BDTB BREAKAWAY DEVICE, TRANSFORMER BASE, 11.5" BOLT CIRCLE

POLE IDENTIFICATION



PLAN	REVISIONS	DATE
NO.	BY	
NO.	BY	
NO.	BY	
NO.	BY	

PROFILE	REVISIONS	DATE
NO.	BY	
NO.	BY	
NO.	BY	
NO.	BY	

FILE NAME = 08307-PLAN-01
PLOT SCALE = 1"=50'
PLOT DATE = 10-19-09

USER NAME =	DESIGNED = DWS	REVISED =
CHECKED = EJT	REVISED =	
DRAWN = MJD	REVISED =	
CHECKED = PAP	REVISED =	

STATE OF ILLINOIS
DEPARTMENT OF TRANSPORTATION

BROADWAY AVENUE STREET LIGHTING PARK AVENUE TO 151ST STREET (SIBLEY BOULEVARD) PLAN SHEET			
SCALE: 1"=50'	SHEET NO. 3 OF 10 SHEETS	STA. 11+00 TO STA. 34+50	

F.A.U. RITE	SECTION	COUNTY	TOTAL SHEETS	SHEET NO.
1025	09-00182-00-LT	COOK	10	3
CONTRACT NO. 63286				
FED. ROAD DIST. NO. 1 ILLINOIS FED. AID PROJECT ARA-9003 (333)				

