

SECTION 28, TOWNSHIP 35, RANGE 14

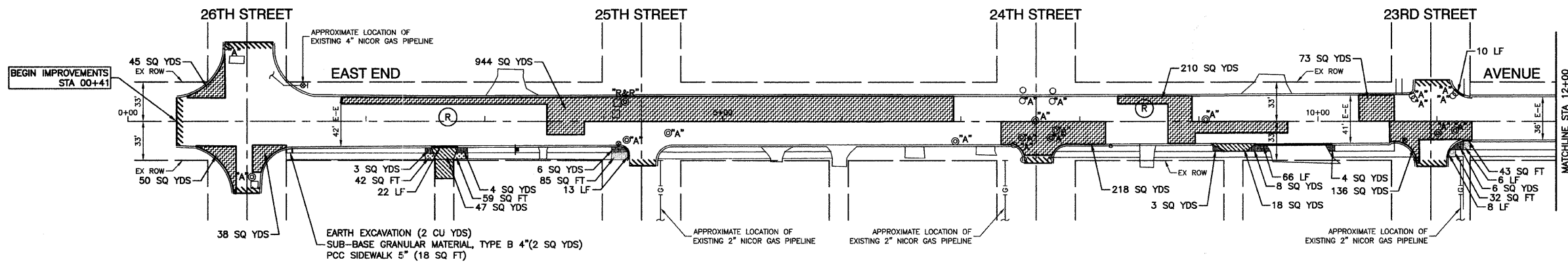

DATE	
BY	
REVISION	
PLANNED	
ALIGNED	
CHECKED	
FILED	
NO.	



DATE	
BY	
REVISION	
PLANNED	
ALIGNED	
CHECKED	
FILED	
NO.	

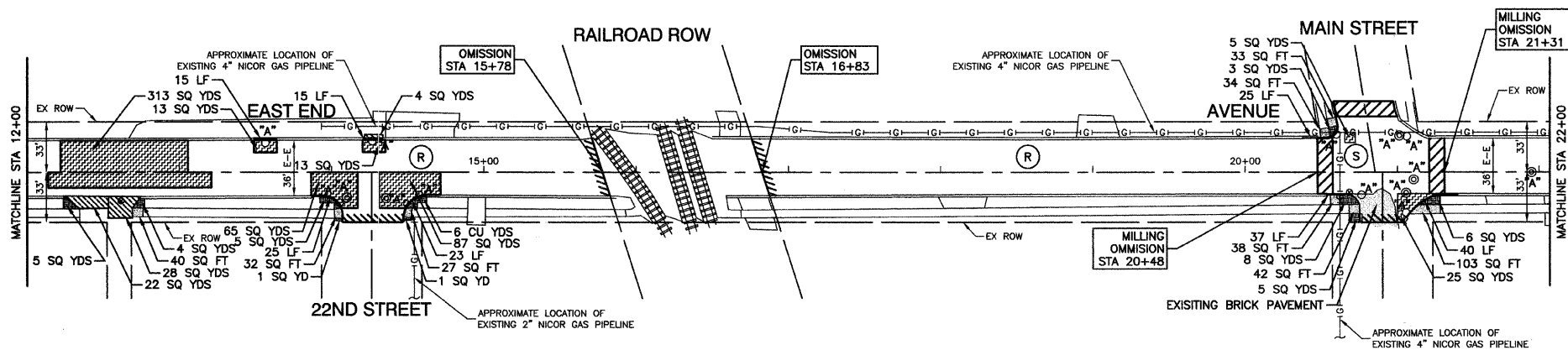

NOTE:

LIMIT OF CONSTRUCTION ON ALL SIDE STREETS IS THE RADIUS RETURN.

LEGEND

- PROJECT LIMITS
- DRIVEWAY PAVEMENT REMOVAL
- PCC DRIVEWAY PAVEMENT, 7"
- DRIVEWAY PAVEMENT REMOVAL
- HOT-MIX ASPHALT BASE COURSE, 8"
- HOT-MIX ASPHALT SURFACE COURSE, MIX "C", N50
- HOT-MIX ASPHALT SURFACE REMOVAL - BUTT JOINT (SEE SHEET 12 FOR BUTT JOINT DETAIL)
- CONCRETE SIDEWALK REMOVAL, PCC SIDEWALK, 5"
- BITUMINOUS SIDEWALK REMOVAL, PCC SIDEWALK, 5"
- CLASS D PATCHES, TYPE I, II, III, IV, 8 INCH PREPARATION OF BASE AGGREGATE BASE REPAIR
- COMBINATION CONCRETE CURB AND GUTTER REMOVAL AND REPLACEMENT
- TOPSOIL FURNISH AND PLACE, 4" SODDING, SALT TOLERANT FERTILIZER NUTRIENTS (NITROGEN, PHOSPHORUS, POTASSIUM)
- HOT-MIX ASPHALT SURFACE COURSE, MIX "D", N50 1 1/2"
- HOT-MIX ASPHALT SURFACE REMOVAL, 2" POLYMERIZED LEVELING BINDER (MACHINE METHOD), N50 3/4" HOT-MIX ASPHALT SURFACE COURSE, MIX "D", N50 1 1/2"
- FRAMES AND LIDS TO BE ADJUSTED (SPECIAL)
- REMOVING MANHOLES
- MANHOLES, TYPE A, 4'-DIAMETER, TYPE 1 FRAME, CLOSED LID

FILE NAME = 06173_01-PLAN-01 - IDOT P01

USER NAME =	DESIGNED -- MPN	REVISED --
	CHECKED -- JMN	REVISED --
PLOT SCALE = 1"=50'	DRAWN -- PS, MJD	REVISED --
PLOT DATE = 10-16-09	CHECKED -- JMN	REVISED --

STATE OF ILLINOIS
DEPARTMENT OF TRANSPORTATION

LOCAL AGENCY PAVEMENT PRESERVATION
EAST END AVENUE
PAVEMENT PLAN

SCALE: 1"=50' SHEET NO. 4 OF 18 SHEETS STA. 0+41 TO STA. 22+00

F.A.U. RTE.	SECTION	COUNTY	TOTAL SHEETS	SHEET NO.
2887	09-00225-00-RS	COOK	18	4
CONTRACT NO. 63314				
FED. ROAD DIST. NO. 1 ILLINOIS FED. AID PROJECT ARA-9003(337)				