

F.A.U. RTE.	SECTION	COUNTY	TOTAL SHEETS	SHEET NO.
1638*	**	WILL	38	15
STA.		TO STA.		
FED. ROAD DIST. NO. -		ILLINOIS	FED. AID PROJECT	
CONTRACT NO. 63316		* EXCHANGE STREET ** 09-00044-01-TL		

LIMIT OF IMPROVEMENTS
STA. 14+00

NOTE: WITHIN INDEPENDENCE BLVD. R.O.W. ALL DISTURBED GROUND SHALL BE SEEDED WITH CLASS 1 LAWN MIXTURE, ON 4" THICK TOPSOIL BED, FERTILIZER, AND EROSION CONTROL BLANKET, TO THE SATISFACTION OF THE VILLAGE OF CRETE.

LEGEND

SILT FENCE _____

INLET WITH STRAW BALE PLACEMENT 

TEMPORARY DITCH CHECK 

EROSION CONTROL BLANKET 

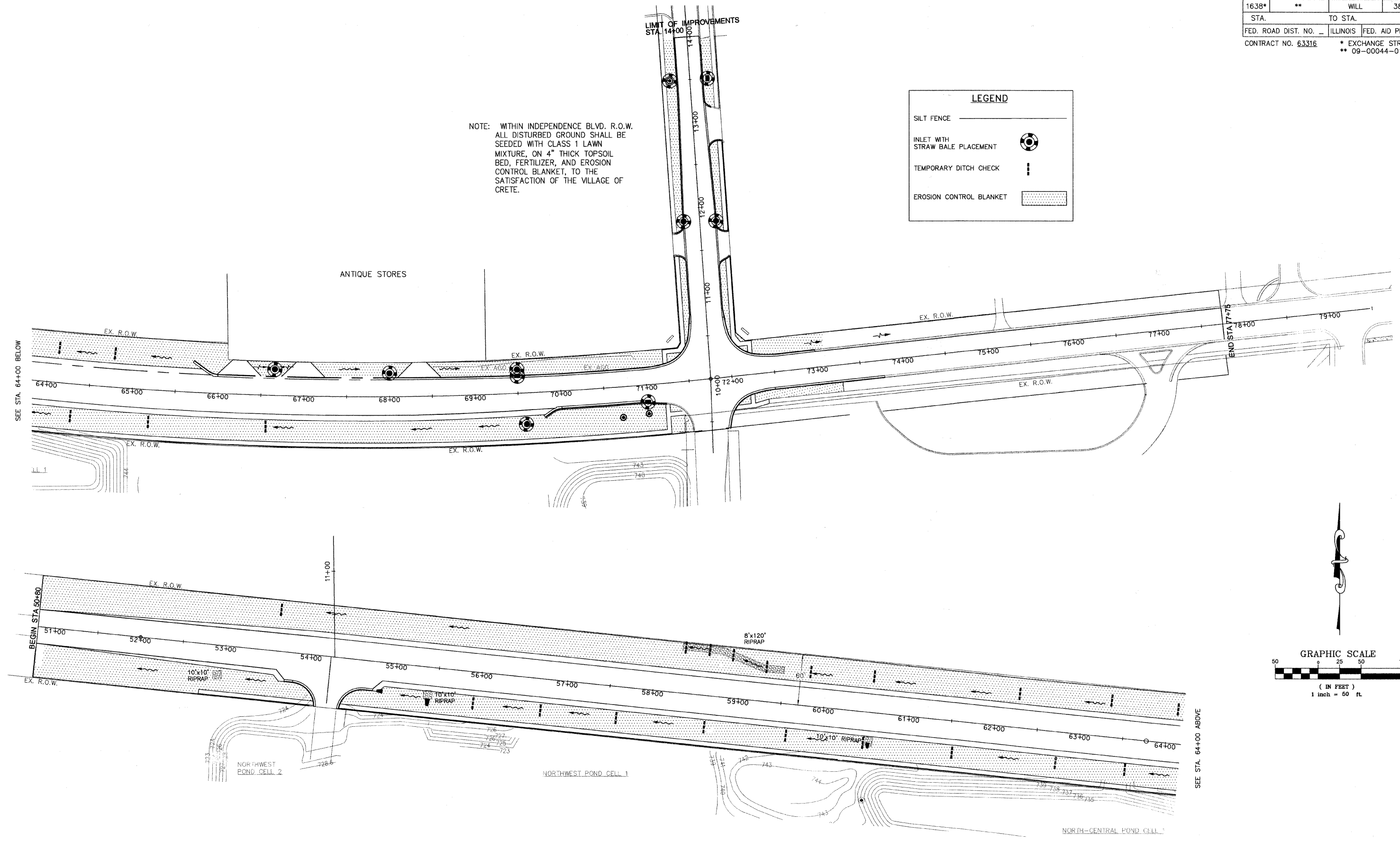

GRAPHIC SCALE

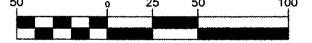

(IN FEET)
1 inch = 50 ft.

REVISIONS		
NO.	NAME	DATE
1	PER IDOT	8-13-09
2	PER IDOT	10-29-09

MCBRIDE ENGINEERING, INC.
 CIVIL ENGINEERS & SURVEYORS
 ILLINOIS PROFESSIONAL DESIGN FIRM #164-000803

CORPORATE: 3649 W. 183rd Street Suite 124, Hazel Crest, IL 60429-2409, 708-799-1350
 ARLINGTON HEIGHTS DIVISION: 320 S. Belmont Avenue, Arlington Heights, IL 60005-2038, 847-394-4810

MEI PROJECT: 04119.806 SCALE: 1"=50'

VILLAGE OF CRETE
 EXCHANGE STREET IMPROVEMENTS
 CRETE, WILL COUNTY, ILLINOIS

**SOIL EROSION AND
 SEDIMENT CONTROL PLAN**

DATE: 7-3-09 DRAWN BY: PG/ADM
 CHECKED BY: LGB

M:\2004\04119.4.dwg\04119.806_WORKING.dwg 10/29/2009 11:24:17 AM CDT