

FOR PAVEMENT MARKINGS
SEE SHEETS 13 & 14.

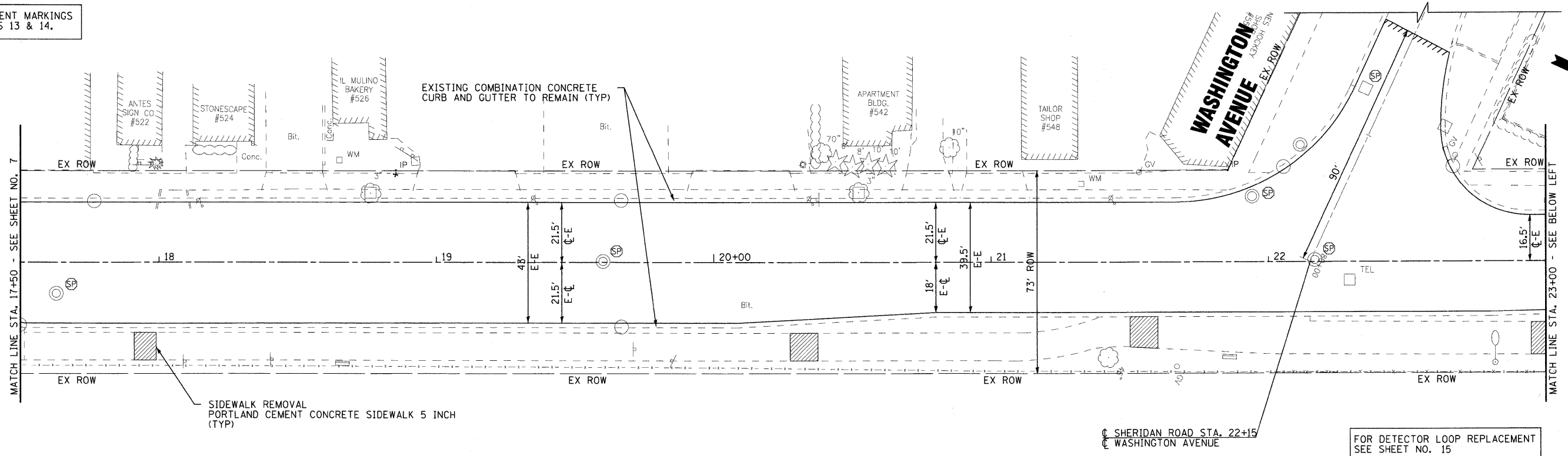

SHERIDAN ROAD

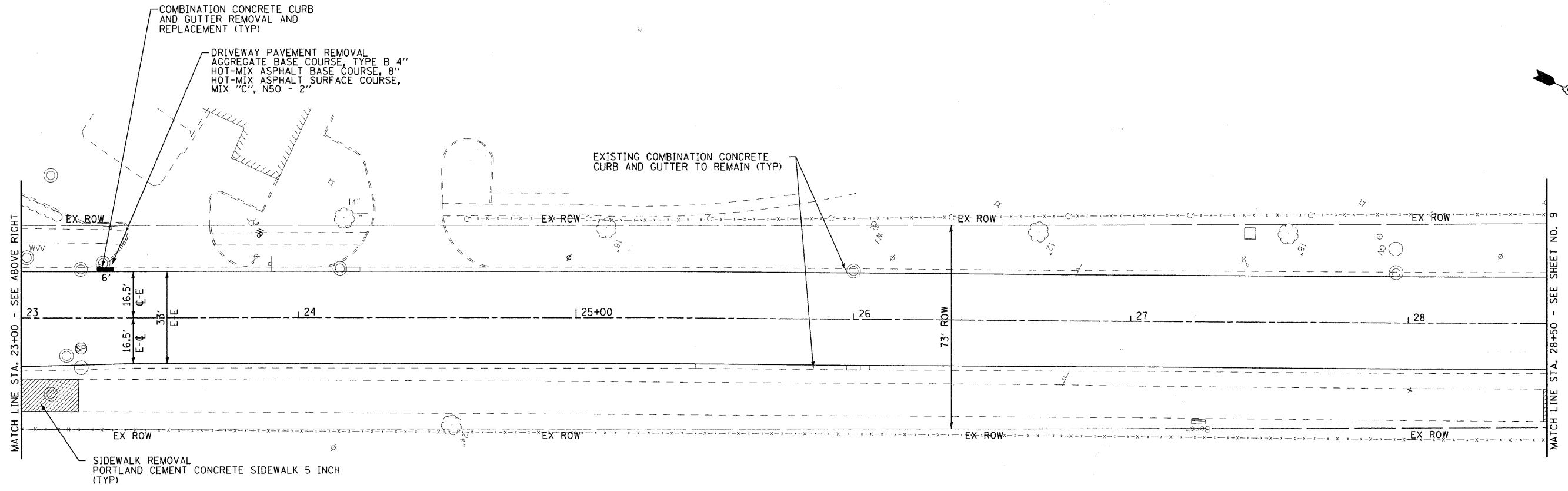

SHERIDAN ROAD

COPYRIGHT © 2009 BY BAXTER & WOODMAN, INC.
 STATE OF ILLINOIS - PROFESSIONAL DESIGN FIRM
 LICENSE NO. 184-00121 - EXPIRES 7/30/2011
 410 So. LaSalle St., Suite 200, Chicago, IL 60606



DESIGNED - SLN	REVISED - IDOT REVIEW 10/05/09
DRAWN - KAR	REVISED -
CHECKED - RWL	REVISED -
DATE - 08-20-09	FILE - 090831-pp2.shx

**CITY OF HIGHWOOD, ILLINOIS
SHERIDAN ROAD ARRA (LAPP)
RESURFACING**

PLAN - SHERIDAN ROAD

SCALE: 1" = 20' STA. 17+50 TO STA. 28+50

F.A.U. RTE.	SECTION	COUNTY	TOTAL SHEETS	SHEET NO.
2744	09-00053-00-RS	LAKE	25	8
FED. ROAD DIST. NO. 1 C-91-891-09			CONTRACT NO. 63338	
ILLINOIS FED. AID PROJECT ARA-9003(457)				